

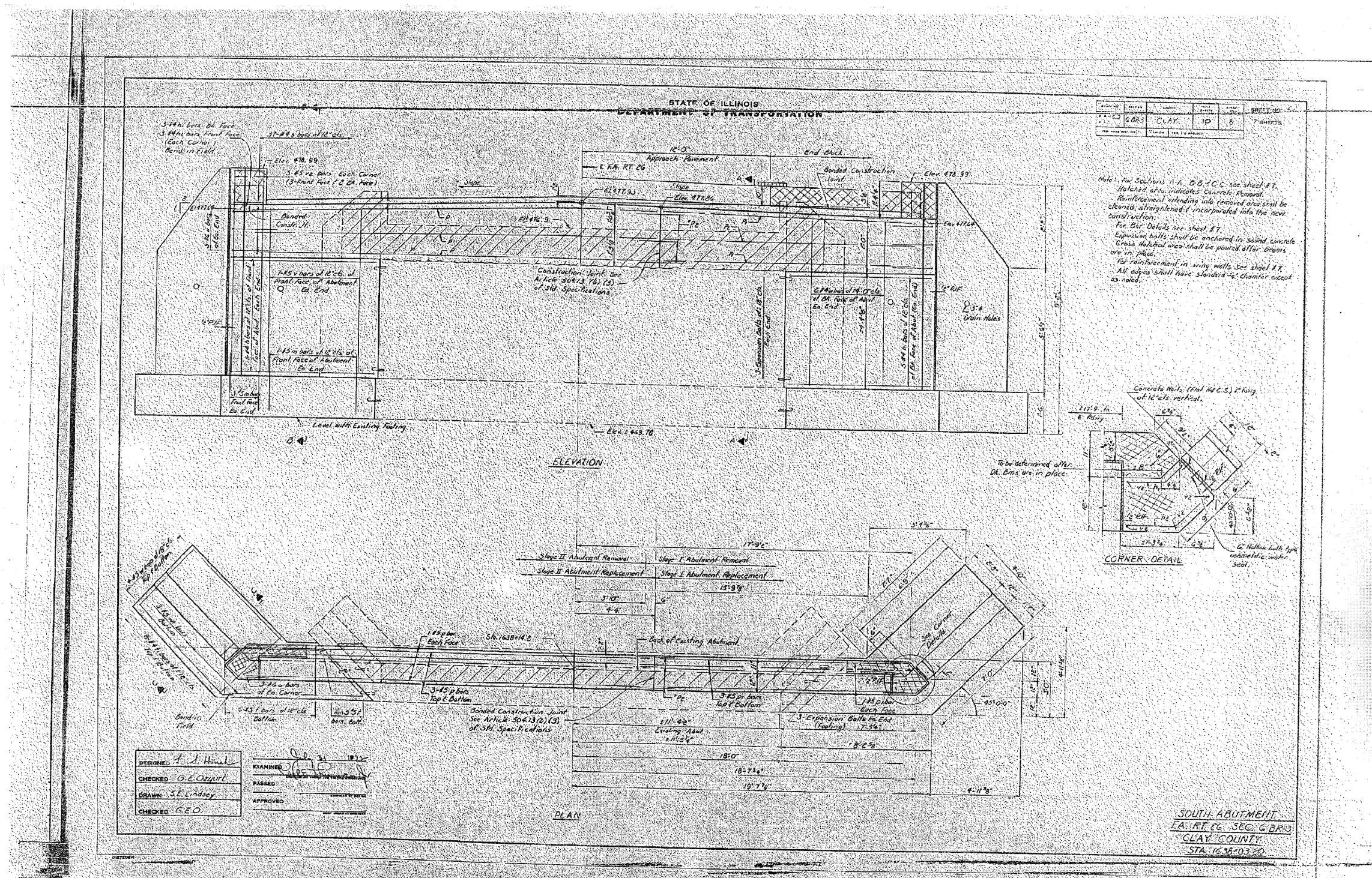

CONTRACT NO. 74107			
FAP RTE	SECTION	COUNTY	TOTAL SHEETS NO.
328	6BR-3B-1	CLAY	109 47
STA.		TO STA.	
FED. ROAD DIST. NO.		ILLINOIS FED. AID PROJECT	

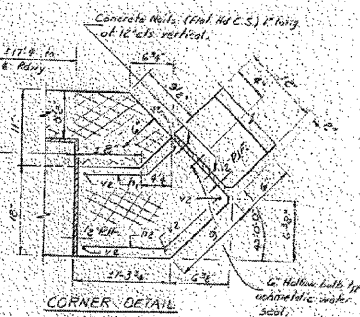

Note: For Sections A-A, B-B, C-C see sheet #1.
 Hatched area indicates Concrete Formwork.
 Reinforcement extending into removed area shall be cleaned, straightened & incorporated into the new construction.
 For Bar Details see sheet #1.
 Expansion balls shall be anchored in sound concrete.
 Cross Hatched area shall be poured after bays are in place.
 For reinforcement in wing walls see sheet #2.
 All edges shall have standard 4" chamfer except as noted.



DESIGNED BY: J. J. Henschel	EXAMINED BY: [Signature]
CHECKED BY: G. E. O'Leary	PAIRED BY: [Signature]
DRAWN BY: S. E. Lindsey	APPROVED BY: [Signature]
CHECKED BY: G. E. O.	

ESCA CONSULTANTS, INC.		
DESIGNED BY:	DAJ	04/08
DRAWN BY:	HAS	04/08
CHECKED BY:	ELH	05/08
APPROVED BY:	RDP	08/08

FOR INFORMATION ONLY

EXISTING STRUCTURE PLANS
 US 45 OVER BRANCH OF ELM CREEK
 FAP ROUTE 328 - SECTION (6BR-3)B-1
 CLAY COUNTY