

EXISTING STRUCTURE DATA
 ☐ STATION 721+12.00 (F.A.I. ROUTE 72)
 SKEW 26°-30' RT. FOR.
 APPROX. LENGTH 418'-0"
 (BK.-BK. APPR. BENTS)
 APPROX. HORIZ. CLEARANCE 42'-0"
 CONSTRUCTED AS SECTION 58-66 B
 STRUCTURE No. 058-0093 (E.B.)
 STRUCTURE No. 058-0094 (W.B.)
 DATA OBTAINED FROM OLD PLANS

PAVING OMISSION
 STA. 719+00.65 TO 723+18.90

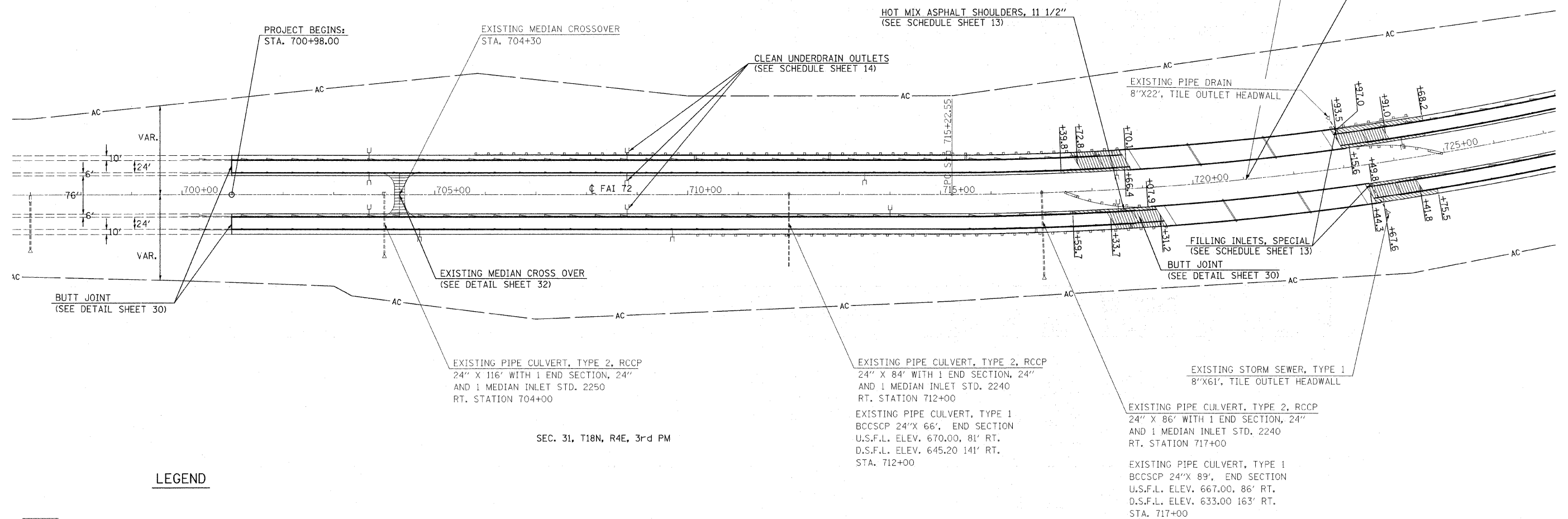

LEGEND

- HOT MIX ASPHALT SURFACE REMOVAL - VARIABLE DEPTH
- PAVED SHOULDER REMOVAL
- PAVEMENT REMOVAL
- PORTLAND CEMENT CONCRETE SURFACE REMOVAL - BUTT JOINT
- HOT MIX ASPHALT SURFACE REMOVAL - BUTT JOINT

FILE NAME =	USER NAME = swartzw	DESIGNED -	REVISED -
ct:\pw_work\FWIDOT\SWARTZRW\dms3580\shp\plan_74171.dgn		DRAWN -	REVISED -
		CHECKED -	REVISED -
		DATE -	REVISED -

**STATE OF ILLINOIS
 DEPARTMENT OF TRANSPORTATION**

PLAN SHEET

SCALE: 100 SHEET NO. 1 OF 8 SHEETS STA. 700+98.00 TO STA. 727+00.00

F.A.I. RTE.	SECTION	COUNTY	TOTAL SHEETS	SHEET NO.
72	(58,74)166,67RS-1	MACON	38	15
CONTRACT NO. 74171				
FED. ROAD DIST. NO.		ILLINOIS FED. AID PROJECT		