

PROP. CURVE 13  
 PI STA. = 733+00.56  
 $\Delta = 34^\circ 28' 49''$  (LT)  
 $D = 1^\circ 00' 00''$   
 $R = 5,729.61'$   
 $T = 1,778.01'$   
 $L = 3,448.05'$   
 $E = 269.54'$   
 $e = \text{-----}$   
 T.R. = -----  
 S.E. RUN = -----  
 P.C. STA. = 715+22.55  
 P.T. STA. = 749+70.60

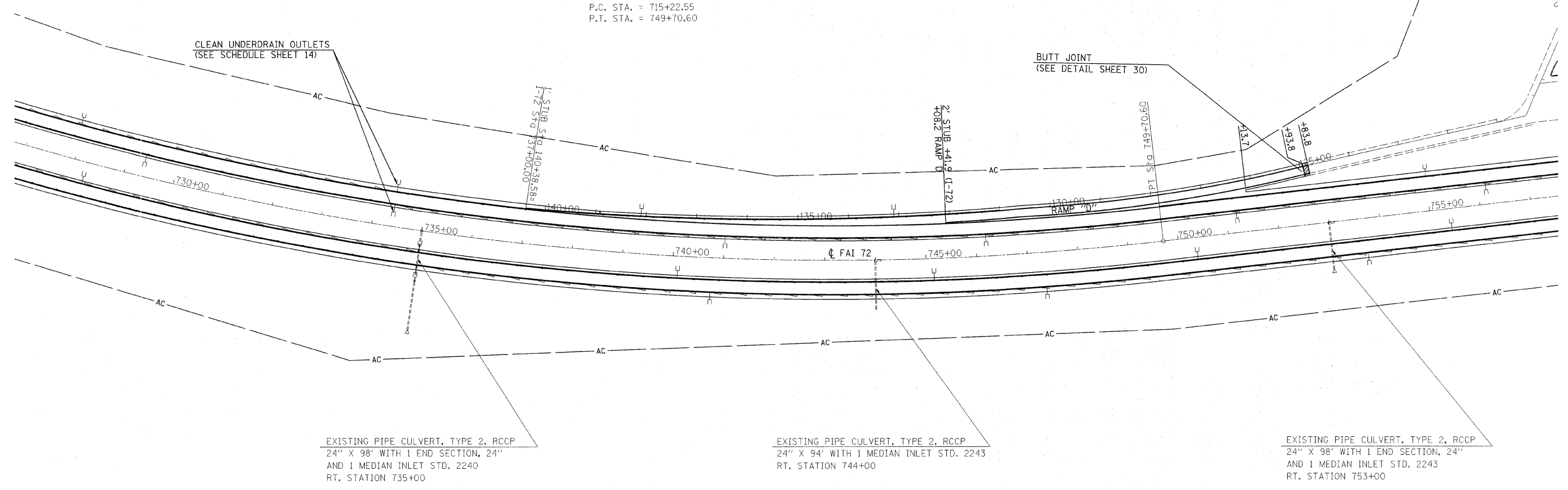

**LEGEND**

- HOT MIX ASPHALT SURFACE REMOVAL - VARIABLE DEPTH
- PAVED SHOULDER REMOVAL
- PAVEMENT REMOVAL
- PORTLAND CEMENT CONCRETE SURFACE REMOVAL - BUTT JOINT
- HOT MIX ASPHALT SURFACE REMOVAL - BUTT JOINT

FILE NAME = <small>et:\pw\work\VP\WIDOT\SWARTZRW\dms35589\sh</small>	USER NAME = swartzrw <small>plan_74171.dgn</small>	DESIGNED -	REVISED -	<b>STATE OF ILLINOIS DEPARTMENT OF TRANSPORTATION</b>	<b>PLAN SHEET</b>	F.A.I. RTE. 72	SECTION (58,74)(66,67)RS-1	COUNTY MACON	TOTAL SHEETS 38	SHEET NO. 16	
PLOT SCALE = 100.0000 1/1 IN. PLOT DATE = 10/9/2008						SCALE: 100		SHEET NO. 2 OF 8 SHEETS		STA. 727+00.00 TO STA. 757+00.00	
DRAWN -						FED. ROAD DIST. NO.		ILLINOIS FED. AID PROJECT			
CHECKED -						CONTRACT NO. 74171					
DATE -											