

STAGE II DETAIL *

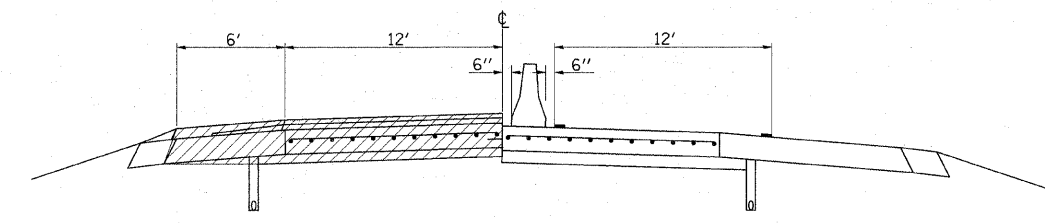

* TRAFFIC STAGING MAY BE MODIFIED BY THE CONTRACTOR TO ALLOW FOR ONE (1) REST AREA TO REMAIN OPEN DURING CONSTRUCTION.

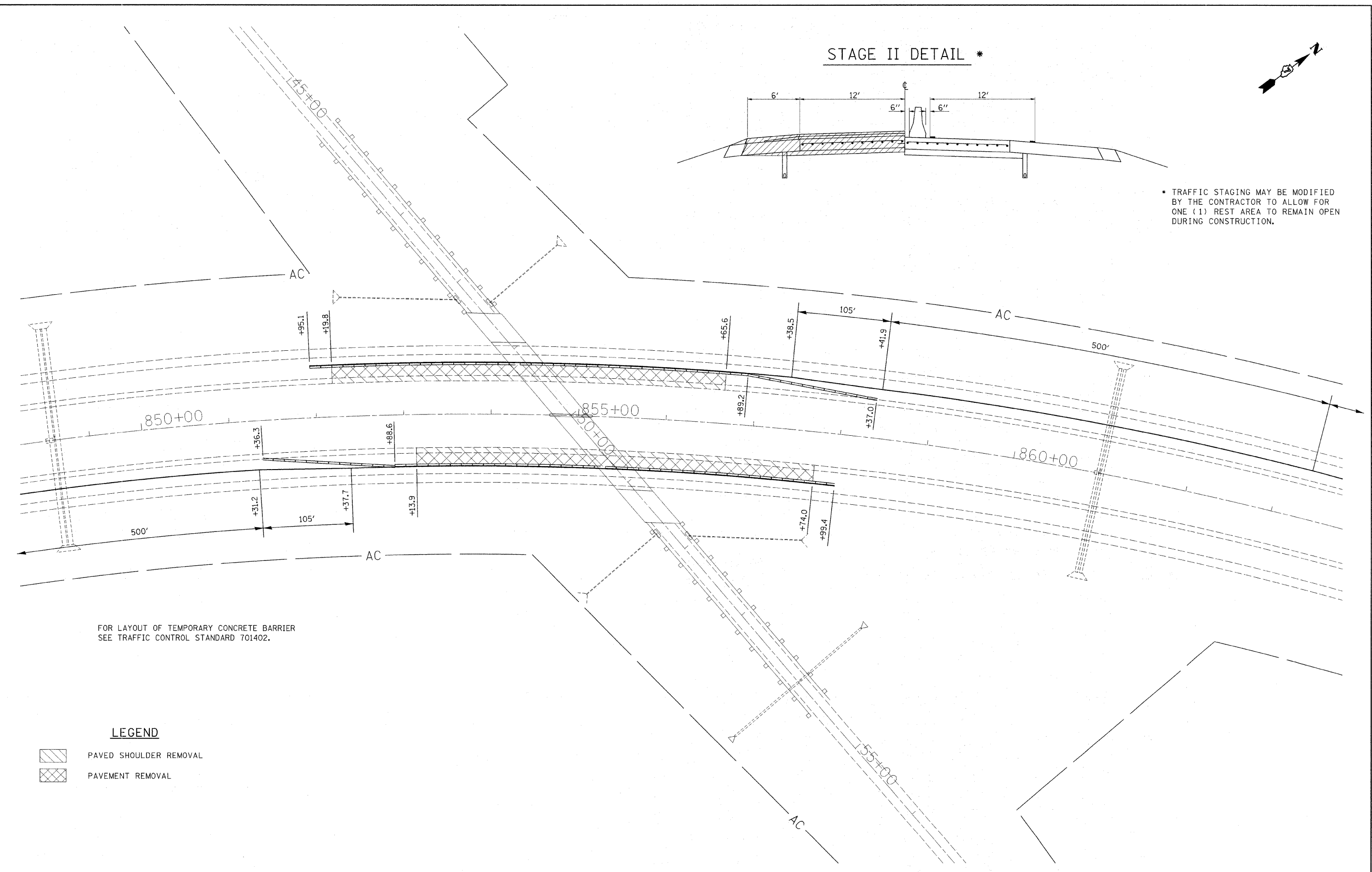

FOR LAYOUT OF TEMPORARY CONCRETE BARRIER
SEE TRAFFIC CONTROL STANDARD 701402.

LEGEND

- PAVED SHOULDER REMOVAL
- PAVEMENT REMOVAL

FILE NAME =	USER NAME = swartzw	DESIGNED -	REVISED -	STATE OF ILLINOIS DEPARTMENT OF TRANSPORTATION	STAGE II FOR TYPE IV, 10" PATCH	F.A.I. RTE. 72	SECTION (58,74)(66,67)RS-1	COUNTY MACON	TOTAL SHEETS 38	SHEET NO. 27
cs:\pw\work\PWID01\SWARTZRW\dms50694\stage2.74171.dgn		DRAWN -	REVISED -							
	PLOT SCALE = 50.0000' / IN.	CHECKED -	REVISED -		SCALE: 50	SHEET NO. 2 OF 3 SHEETS	STA. 849+00	TO STA. 862+00	CONTRACT NO. 74171	
	PLOT DATE = 10/9/2008	DATE -	REVISED -		FED. ROAD DIST. NO. ILLINOIS FED. AID PROJECT					