

BILL OF MATERIAL

BAR	NUMBER OF BARS		TOTAL	SIZE	LENGTH	
	STAGE I	STAGE II				
a(E)	8		8	#5	24'-11"	
a1(E)	8		8	#6	24'-11"	
a2(E)		8	8	#5	18'-10"	
a3(E)		8	8	#6	18'-10"	
d(E)	6	6	12	#4	1'-3"	
d1(E)	6		6	#4	2'-6"	
d2(E)		6	6	#4	1'-6"	
d3(E)	6	6	12	#4	4'-0"	
h(E)	8		8	#6	24'-11"	
h1(E)		8	8	#6	18'-10"	
x(E)	46	34	80	#5	4'-9"	
CONCRETE REMOVAL					CU. YD.	12.5
REINFORCEMENT BARS (EPOXY COATED)					POUND	1880.0
CONCRETE SUPERSTRUCTURE					CU. YD.	14.1

REINFORCEMENT BARS DESIGNATED (E) SHALL BE EPOXY COATED

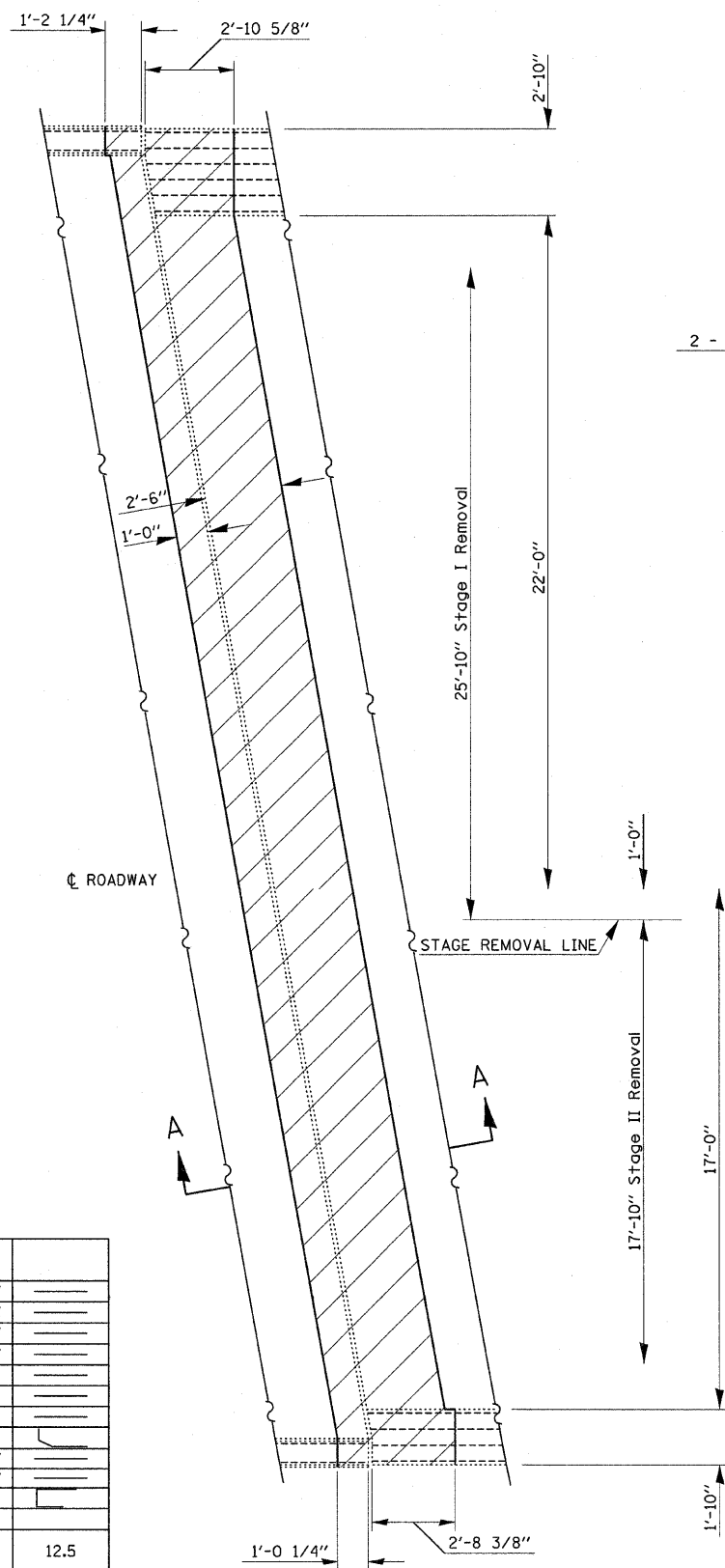

EXISTING PARTIAL PLAN

(West Abutment shown; East Abutment similar)

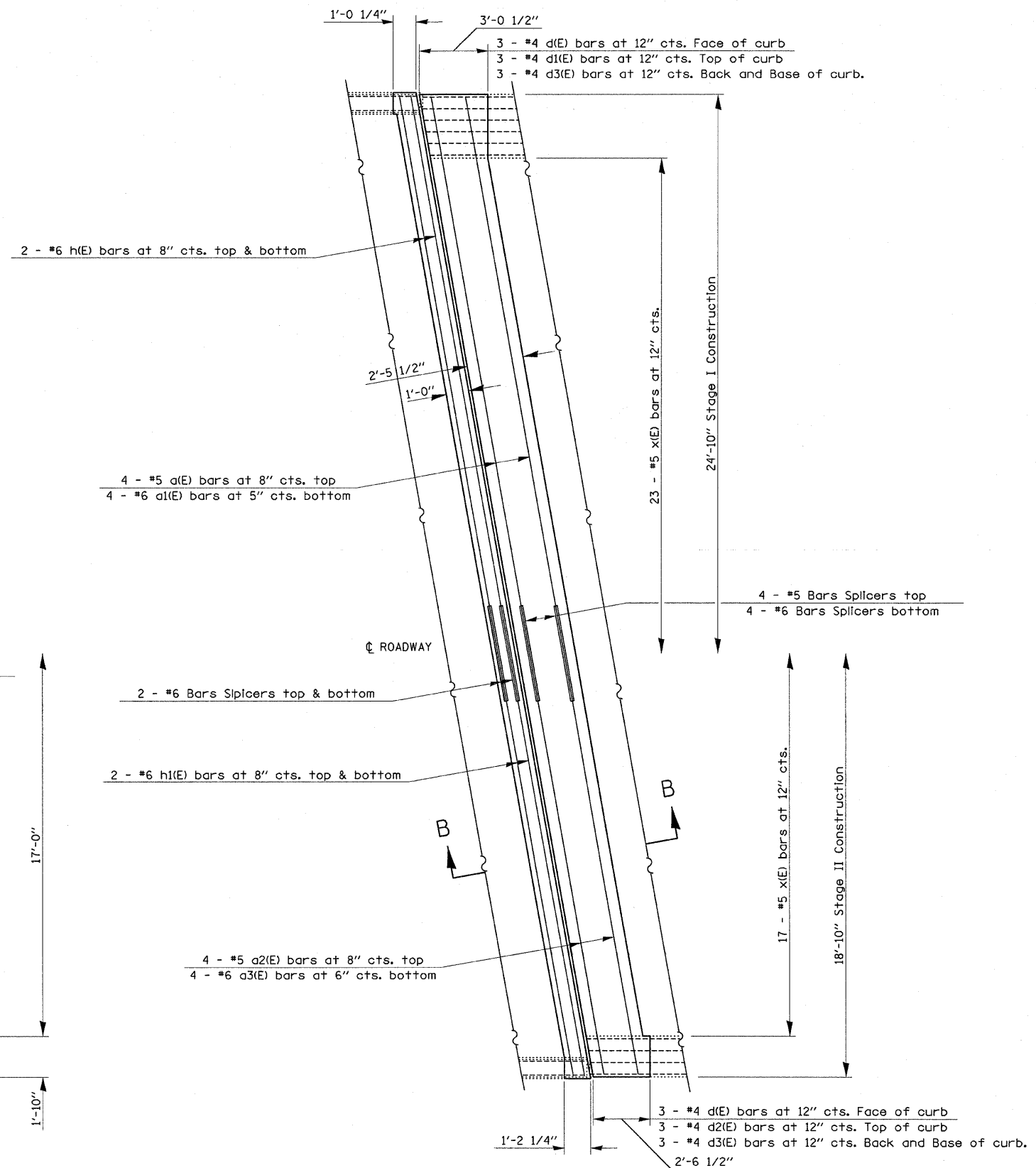

PROPOSED PARTIAL PLAN

(West Abutment shown; East Abutment similar)

For section A-A and B-B, see sheet 5 of 15.

FILE NAME =
 USER NAME = swartzw
 DRAWN -
 CHECKED -
 PLOT SCALE = 20.0000 ' / IN.
 PLOT DATE = 10/14/2008

DESIGNED -
 REVISIONS:
 REVISIONS:
 REVISIONS:
 REVISIONS:
 REVISIONS:
 DATE -

STATE OF ILLINOIS
DEPARTMENT OF TRANSPORTATION

EXPANSION JOINT REPLACEMENT DETAILS
SN. 051-0016 (WB)
 SCALE: N/A SHEET NO. 3 OF 15 SHEETS STA. TO STA.

F.A.P. RTE.	SECTION	COUNTY	TOTAL SHEETS	SHEET NO.
327	(51-23-1, 51-24)RS-1	LAWRENCE	47	35
CONTRACT NO. 74308			ILLINOIS FED. AID PROJECT	

SHEET NO. 3
15 SHEETS