

STATE OF ILLINOIS
DEPARTMENT OF TRANSPORTATION

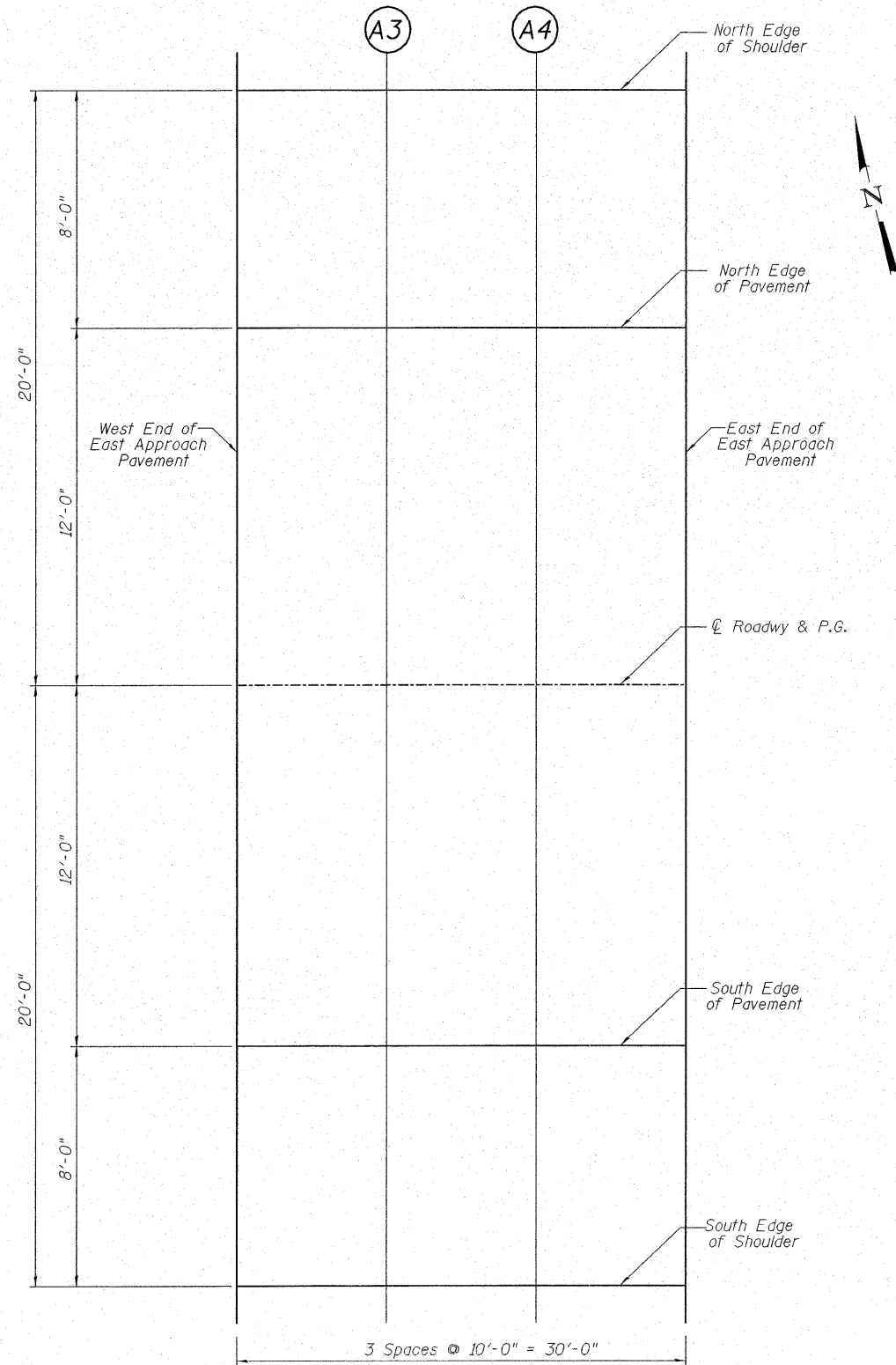

NORTH EDGE OF SHOULDER

Location	Station	Offset	Theoretical Grade Elevations
West End of East Approach Pavement	150+22.75	-20.00	407.38
A1	150+32.75	-20.00	407.36
A2	150+42.75	-20.00	407.34
East End of East Approach Pavement	150.52.75	-20.00	407.32

NORTH EDGE OF PAVEMENT

Location	Station	Offset	Theoretical Grade Elevations
West End of East Approach Pavement	150+22.75	-12.00	407.55
A1	150+32.75	-12.00	407.53
A2	150+42.75	-12.00	407.51
East End of East Approach Pavement	150.52.75	-12.00	407.49

CL ROADWAY & PROFILE GRADE

Location	Station	Offset	Theoretical Grade Elevations
West End of East Approach Pavement	150+22.75	0.00	407.73
A1	150+32.75	0.00	407.71
A2	150+42.75	0.00	407.69
East End of East Approach Pavement	150.52.75	0.00	407.67

SOUTH EDGE OF PAVEMENT

Location	Station	Offset	Theoretical Grade Elevations
West End of East Approach Pavement	150+22.75	12.00	407.55
A1	150+32.75	12.00	407.53
A2	150+42.75	12.00	407.51
East End of East Approach Pavement	150.52.75	12.00	407.49

SOUTH EDGE OF SHOULDER

Location	Station	Offset	Theoretical Grade Elevations
West End of East Approach Pavement	150+22.75	20.00	407.38
A1	150+32.75	20.00	407.36
A2	150+42.75	20.00	407.34
East End of East Approach Pavement	150.52.75	20.00	407.32

PLAN
East Approach

DESIGNED	DB
CHECKED	RS
DRAWN	ER
CHECKED	WWH



Juneau Associates, Inc. P.C.
CONSULTING ENGINEERS AND LAND SURVEYORS
2100 State Street
Granite City, Illinois 62040
Phone: (618) 937-1400
Fax: (618) 937-5541
Registered Professional Service Corporation License No. 184-003889

100 North Research Drive
Edwardsville, Illinois 62025
Phone: (618) 659-0200/(618) 659-0800
Fax: (618) 659-0441

Notes:

Elevations are at top of concrete.
All stations and offsets are given with respect to centerline of profile grade.

TOP OF APPROACH
SLAB ELEVATIONS
ILLINOIS ROUTE 4/15 OVER
KASKASKIA OVERFLOW
F.A.P. ROUTE 817 SEC 421B-1
ST. CLAIR COUNTY
STATION 149+50.00
STRUCTURE NO. 082-0275

SHEET NO. 9	F.A.P. RTE.	SECTION	COUNTY	TOTAL SHEETS	SHEET NO.
	817	421B-1	ST. CLAIR	56	28
28 SHEETS	STRUCTURE NO. 082-0275		CONTRACT NO. 76885		
FED. ROAD DIST. NO.		ILLINOIS	FED. AID PROJECT		