

F.A.U. RTE.	SECTION	COUNTY	TOTAL SHEETS	SHEET NO.
2505	94-P4008-01-BR	KANE	81	14
STA. 229+00		TO STA. 235+00		
FED. ROAD DIST. NO.	ILLINOIS FED. AID PROJECT			

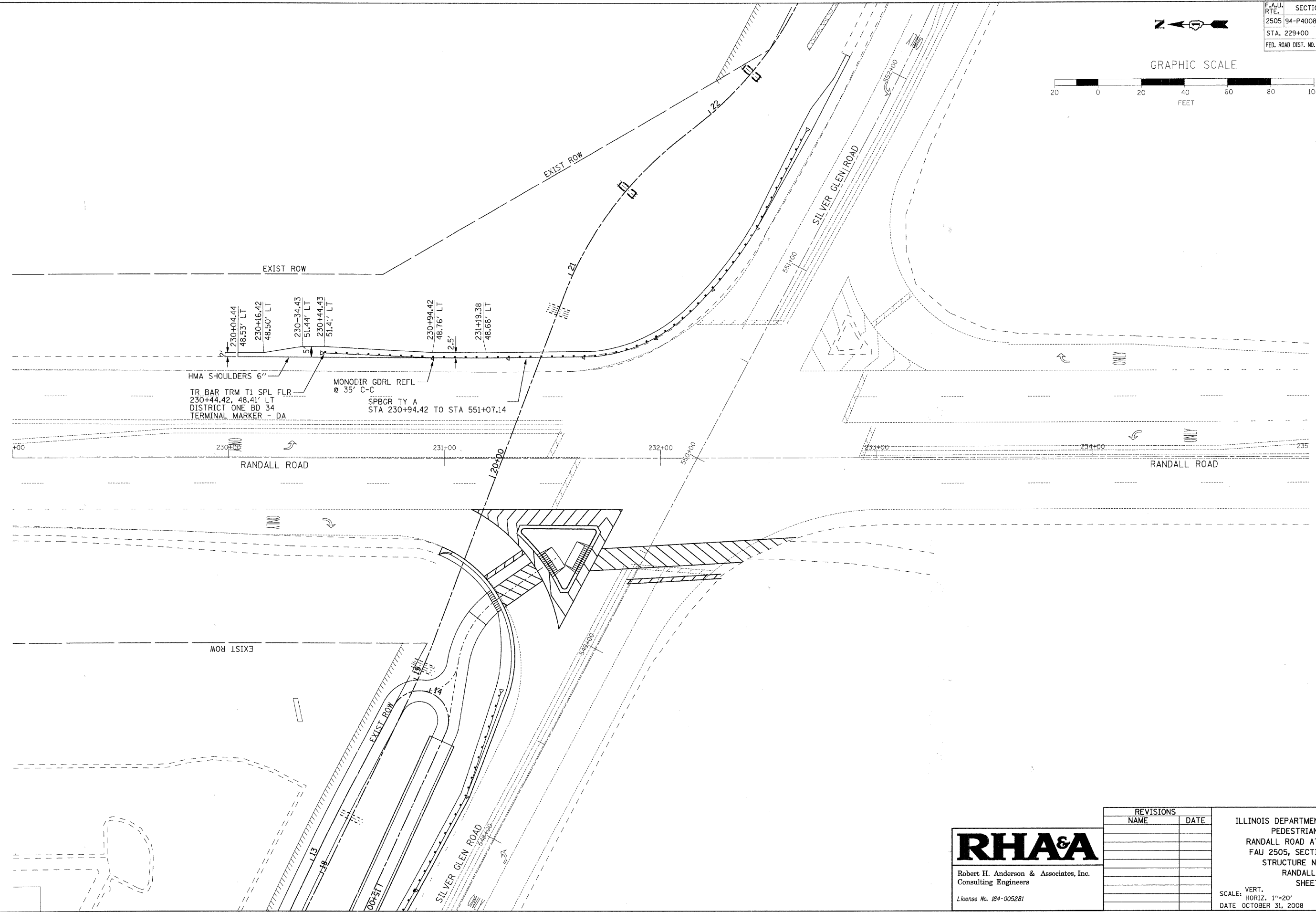
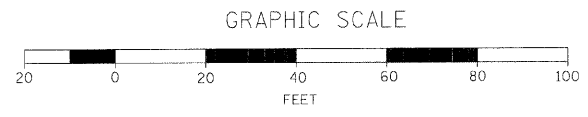

230+04.44  
48.53' LT  
 230+16.42  
48.50' LT  
 230+34.43  
51.44' LT  
 230+44.43  
51.41' LT  
 230+94.42  
48.76' LT  
 231+19.38  
48.68' LT

HMA SHOULDERS 6"  
 TR BAR TRM T1 SPL FLR  
 230+44.42, 48.41' LT  
 DISTRICT ONE BD 34  
 TERMINAL MARKER - DA

MONODIR GDRL REFL  
 @ 35' C-C  
 SPBGR TY A  
 STA 230+94.42 TO STA 551+07.14

PLOT DATE = 11/14/2008  
 FILE NAME = H:\STC\p\h\0\1168648\k\k\ Bridge Design\Drawn\08\_1168648.rwd.dgn  
 PLOT SCALE = 1"=20'  
 REFERENCE = #REF#



Robert H. Anderson & Associates, Inc.  
 Consulting Engineers  
 License No. 184-005281

REVISIONS	
NAME	DATE

ILLINOIS DEPARTMENT OF TRANSPORTATION  
 PEDESTRIAN BRIDGE OVER  
 RANDALL ROAD AT SILVER GLEN ROAD  
 FAU 2505, SECTION 94-P4008-01-BR  
 STRUCTURE NUMBER 045-9000  
 RANDALL ROAD PLAN  
 SHEET 1 OF 1

SCALE: VERT.      DRAWN BY    TC  
       HORIZ. 1"=20'      CHECKED BY    SBP  
 DATE OCTOBER 31, 2008