

F.A.U. RTE.	SECTION	COUNTY	TOTAL SHEETS	SHEET NO.
2505	94-P4008-01-BR	KANE	81	16
STA. 10+00		TO STA. 20+25		
FED. ROAD DIST. NO.		ILLINOIS FED. AID PROJECT		

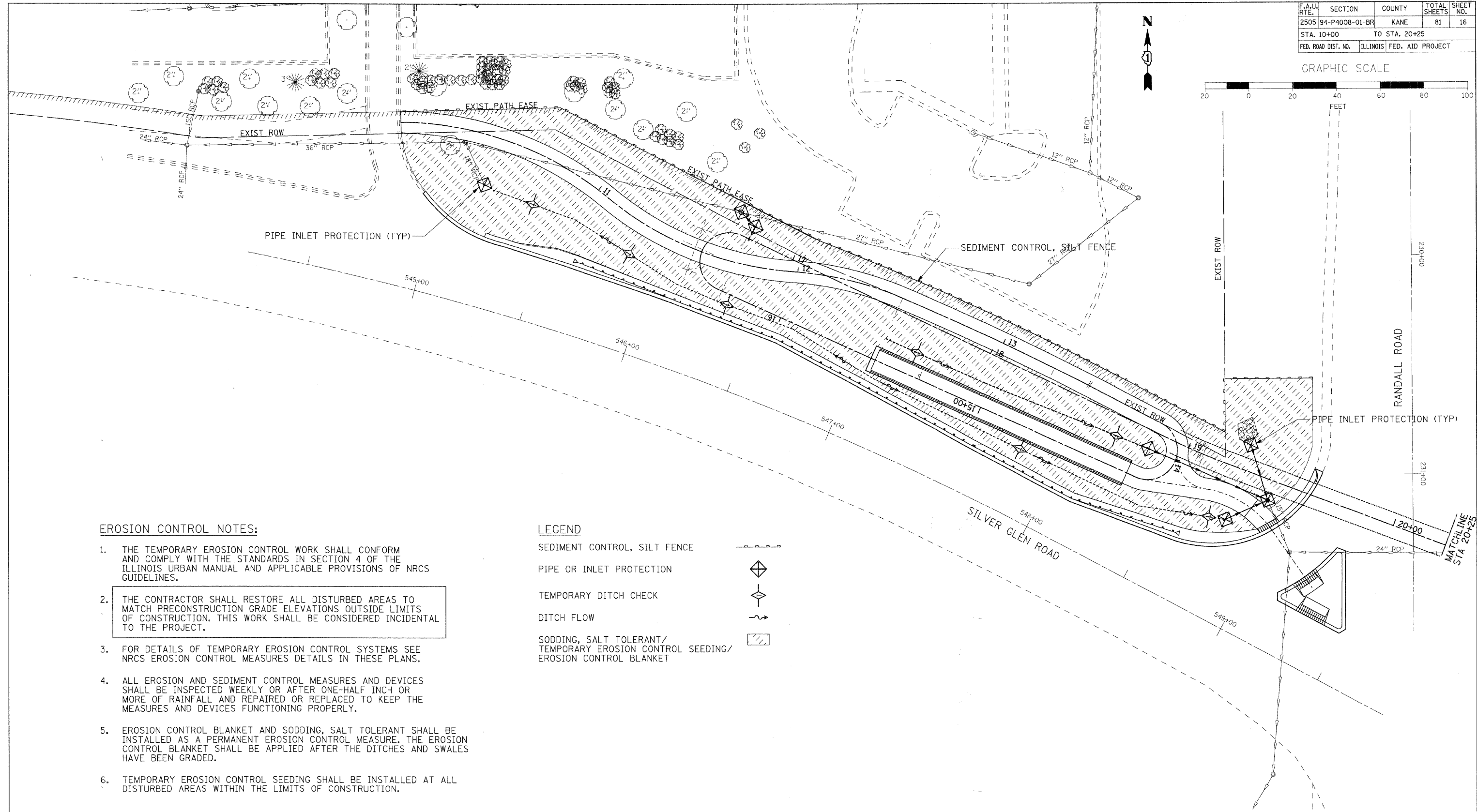
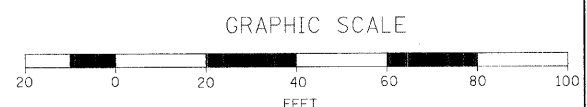

**EROSION CONTROL NOTES:**

1. THE TEMPORARY EROSION CONTROL WORK SHALL CONFORM AND COMPLY WITH THE STANDARDS IN SECTION 4 OF THE ILLINOIS URBAN MANUAL AND APPLICABLE PROVISIONS OF NRCS GUIDELINES.
2. THE CONTRACTOR SHALL RESTORE ALL DISTURBED AREAS TO MATCH PRECONSTRUCTION GRADE ELEVATIONS OUTSIDE LIMITS OF CONSTRUCTION. THIS WORK SHALL BE CONSIDERED INCIDENTAL TO THE PROJECT.
3. FOR DETAILS OF TEMPORARY EROSION CONTROL SYSTEMS SEE NRCS EROSION CONTROL MEASURES DETAILS IN THESE PLANS.
4. ALL EROSION AND SEDIMENT CONTROL MEASURES AND DEVICES SHALL BE INSPECTED WEEKLY OR AFTER ONE-HALF INCH OR MORE OF RAINFALL AND REPAIRED OR REPLACED TO KEEP THE MEASURES AND DEVICES FUNCTIONING PROPERLY.
5. EROSION CONTROL BLANKET AND SODDING, SALT TOLERANT SHALL BE INSTALLED AS A PERMANENT EROSION CONTROL MEASURE. THE EROSION CONTROL BLANKET SHALL BE APPLIED AFTER THE DITCHES AND SWALES HAVE BEEN GRADED.
6. TEMPORARY EROSION CONTROL SEEDING SHALL BE INSTALLED AT ALL DISTURBED AREAS WITHIN THE LIMITS OF CONSTRUCTION.

**LEGEND**

- SEDIMENT CONTROL, SILT FENCE
- PIPE OR INLET PROTECTION
- TEMPORARY DITCH CHECK
- DITCH FLOW
- SODDING, SALT TOLERANT/  
TEMPORARY EROSION CONTROL SEEDING/  
EROSION CONTROL BLANKET

PLOT DATE = 11/4/2008  
 FILE NAME = H:\S1\CP\Per\K0\dat\1168648\k0\_1168648\ER01.dgn  
 PLOT SCALE = 1"=20'  
 REFERENCE = #REF#



Robert H. Anderson & Associates, Inc.  
 Consulting Engineers  
 License No. 184-005281

REVISIONS	
NAME	DATE

ILLINOIS DEPARTMENT OF TRANSPORTATION  
 PEDESTRIAN BRIDGE OVER  
 RANDALL ROAD AT SILVER GLEN ROAD  
 FAU 2505, SECTION 94-P4008-01-BR  
 STRUCTURE NUMBER 045-9000  
 SEDIMENT AND EROSION CONTROL  
 SHEET 1 OF 2

SCALE: VERT.      DRAWN BY TC  
 HORIZ. 1"=20'      CHECKED BY SBP  
 DATE OCTOBER 31, 2008