

F.A.U. RTE.	SECTION	COUNTY	TOTAL SHEETS	SHEET NO.
2505	94-P4008-01-BR	KANE	81	17
STA. 20+25		TO STA. 23+92.54		
FED. ROAD DIST. NO.		ILLINOIS FED. AID PROJECT		

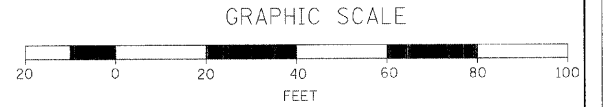

- LEGEND**
- SEDIMENT CONTROL, SILT FENCE
 - PIPE OR INLET PROTECTION
 - TEMPORARY DITCH CHECK
 - DITCH FLOW
 - SODDING, SALT TOLERANT/
TEMPORARY EROSION CONTROL SEEDING/
EROSION CONTROL BLANKET

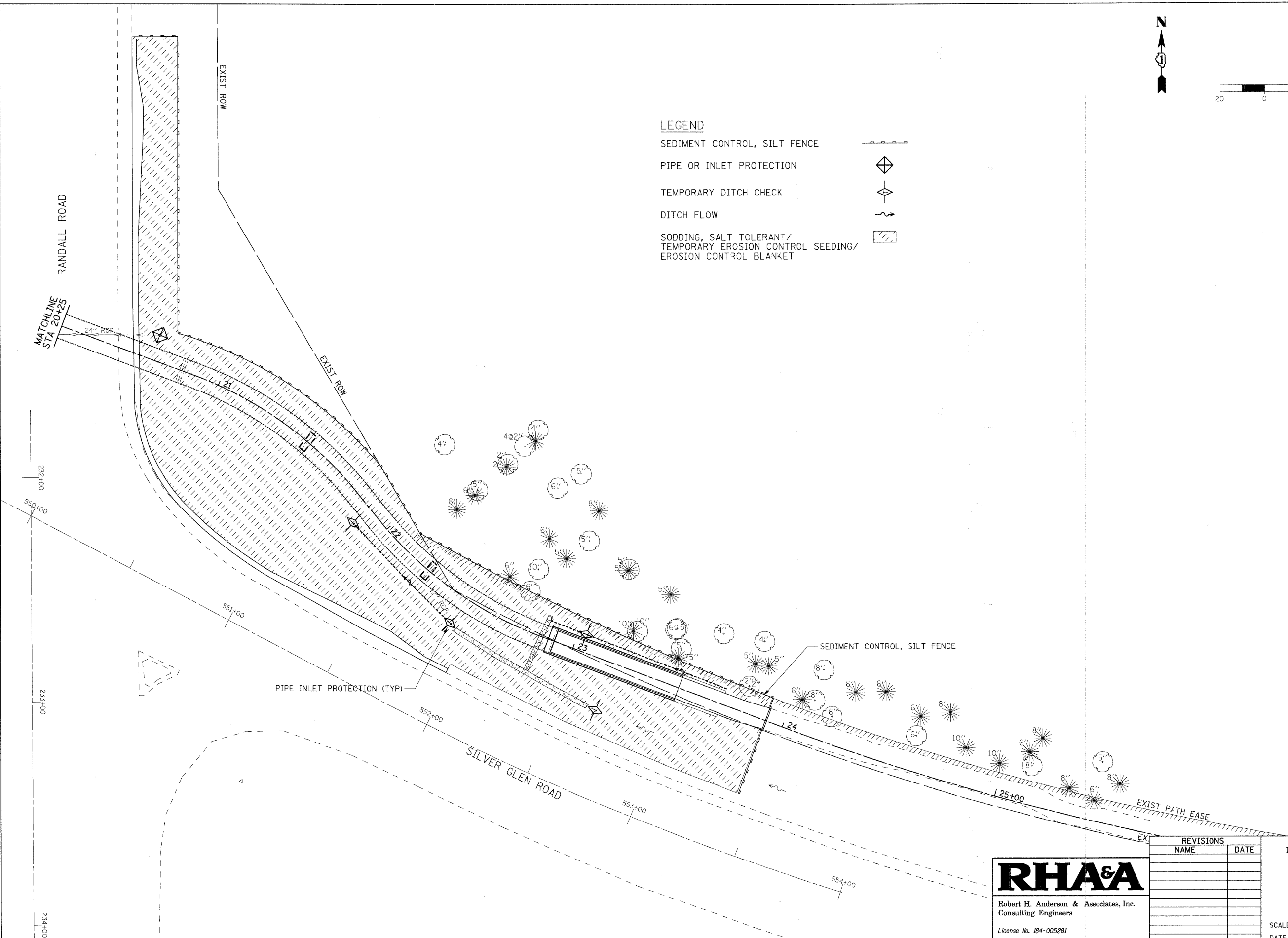

PLOT DATE = 11/14/2008
 FILE NAME = H:\STC\p-k\dwt\1168648\Bke Bridge\Design\Drawings\1168648\1168648ERR02.dgn
 PLOT SCALE = 1"=20'
 REFERENCE = #REF#

RH&A
 Robert H. Anderson & Associates, Inc.
 Consulting Engineers
 License No. 184-005281

REVISIONS	
NAME	DATE

ILLINOIS DEPARTMENT OF TRANSPORTATION
 PEDESTRIAN BRIDGE OVER
 RANDALL ROAD AT SILVER GLEN ROAD
 FAU 2505, SECTION 94-P4008-01-BR
 STRUCTURE NUMBER 045-9000
 SEDIMENT AND EROSION CONTROL
 SHEET 2 OF 2

SCALE: VERT. DRAWN BY TC
 HORIZ. 1"=20' CHECKED BY SBP
 DATE OCTOBER 31, 2008