

# STATE OF ILLINOIS

## DEPARTMENT OF TRANSPORTATION

### DIVISION OF HIGHWAYS

#### SURFACE TRANSPORTATION URBAN PROGRAM

# FAU 6208 (CARDINAL DRIVE)

## VILLAGE OF BRADLEY

SECTION 07-00093-00-RP  
PROJECT NO. M-5034(18)  
JOB NO. C-93-041-07

F.A.U. RTE.	SECTION	COUNTY	TOTAL SHEETS	SHEET NO.
6208	07-00093-00-RP	KANKAKEE	43	01
MG2A# M2-096		CONTRACT NO.: 87342		

### INDEX OF SHEETS

- 01 COVER SHEET
- 02 GENERAL NOTES
- 03 SUMMARY OF QUANTITIES
- 04 TYPICAL SECTIONS
- 05 - 08 SCHEDULES
- 09 ALIGNMENT, TIES & BENCHMARKS
- 10 - 18 PLAN & PROFILE - CARDINAL DR.
- 19 - 21 PAVEMENT MARKING
- 22 - 23 STORM WATER POLLUTION PREVENTION PLAN
- 24 - 25 DETAILS
- 26 TRAFFIC CONTROL & DETOUR MAP
- 27 - 43 CROSS SECTIONS - CARDINAL DR.

### HIGHWAY STANDARDS

- 280001-04 TEMPORARY EROSION CONTROL SYSTEMS
- 424001-05 CURB RAMPS FOR SIDEWALKS
- 542301-02 PRECAST REINFORCED CONCRETE FLARED END SECTION
- 542306-02 PRECAST REINFORCED CONCRETE ELLIPTICAL FLARED END SECTION
- 542311-01 GRATING FOR CONCRETE FLARED END SECTION
- 602301-02 INLET - TYPE A
- 602306-02 INLET - TYPE B
- 602401-02 MANHOLE, TYPE A
- 602406-03 MANHOLE, TYPE A (6") DIAMETER
- 602411-01 MANHOLE, TYPE A (7") DIAMETER
- 602601-02 PRECAST REINFORCED CONCRETE FLAT SLAB TOP
- 604001-03 FRAME AND LIDS, TYPE 1
- 604051-03 FRAME AND GRATE, TYPE 11
- 604056-03 FRAME AND GRATE, TYPE 11V
- 606001-04 CONCRETE CURB TYPE B AND COMBINATION CONCRETE CURB AND GUTTER
- 701006-03 OFF-RD OPERATIONS, 2L, 2W, 15'-24" FROM PAVEMENT EDGE
- 701011-02 OFF-RD MOVING OPERATIONS, 2L, 2W, DAY ONLY
- 701301-03 LANE CLOSURE, 2L, 2W, SHORT TIME OPERATIONS
- 701501-05 URBAN LANE CLOSURE, 2L, 2W UNDIVIDED
- 701901-01 TRAFFIC CONTROL DEVICES
- 720006-02 SIGN PANEL ERECTION DETAILS
- 728001-01 TELESCOPING STEEL SIGN SUPPORT
- 780001-02 TYPICAL PAVEMENT MARKINGS
- BLR 22-6 TYPICAL APPLICATIONS OF TRAFFIC CONTROL DEVICES FOR CONSTRUCTION ON RURAL LOCAL HIGHWAYS

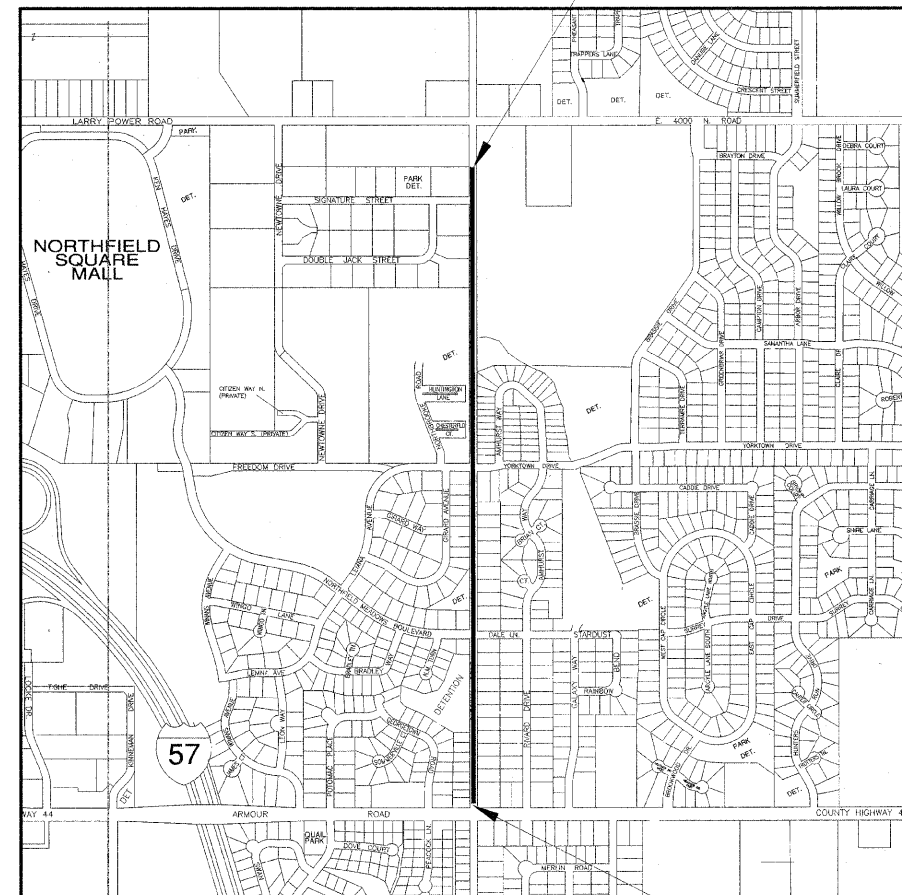

CARDINAL DR.  
END OF IMPROVEMENTS STA. 104+68

CARDINAL DR.  
BEGIN IMPROVEMENTS STA. 56+36

TOWNSHIP 31 N RANGE 12 E

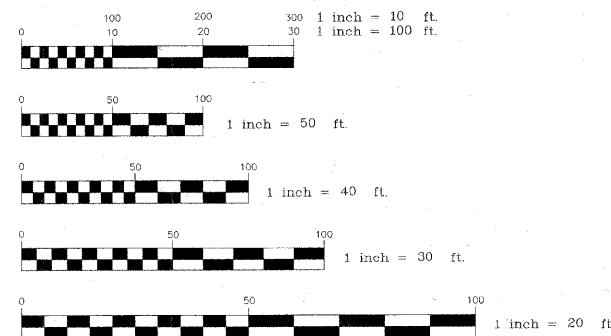
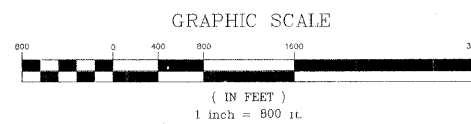

FULL SIZE PLANS HAVE BEEN PREPARED USING STANDARD ENGINEERING SCALES. REDUCED SIZED PLANS WILL NOT CONFORM TO STANDARD SCALES. IN MAKING MEASUREMENTS ON REDUCED PLANS, THE ABOVE SCALES MAY BE USED.

FUNCTIONAL CLASSIFICATION - URBAN TWO WAY COLLECTOR  
CURRENT 2007 ADT = 3250 M.U. 1% S.U. 4% P.V. 95%  
DESIGN 2028 ADT = 9100 M.U. 1% S.U. 4% P.V. 95%  
DESIGN SPEED - 30 M.P.H.

GROSS LENGTH - 4832 FT. = 0.915 MILES  
NET LENGTH - 4832 FT. = 0.915 MILES

THIS PROJECT IS BUILT IN ACCORDANCE WITH URBAN RECONSTRUCTION POLICIES AS OUTLINED IN THE BUREAU OF LOCAL ROADS & STREETS MANUAL

**STATE OF ILLINOIS**  
**DEPARTMENT OF TRANSPORTATION**  
**DIVISION OF HIGHWAYS**

APPROVED: [Signature] Village President 10/20/08  
VILLAGE OF BRADLEY TITLE DATE

PASSED: [Signature] 11-06-08  
DISTRICT 3 ENGINEER OF LOCAL ROADS AND STREETS DATE

RELEASED FOR BID  
BASED ON LIMITED REVIEWS:

[Signature] 11-06-08  
DEPUTY DIRECTOR OF HIGHWAYS REGION 2 ENGINEER DATE

[Signature] 10-28-08  
MICHAEL A. GINGERICH P.E. # 062-049765 DATE

EXPIRATION DATE OF P.E. LICENSE: 11-30-2009

PRINTED BY THE AUTHORITY OF THE STATE OF ILLINOIS

240 N. Industrial Drive  
Bradley, Illinois 60915  
815-939-4921  
FAX: 815-939-9810

DATE	BY	DESCRIPTION
2/11/08	AJC/JWP	PER IDOT REVIEW
3/27/08	JWP	PER IDOT REVIEW
4/1/08	JWP	PER IDOT REVIEW
5/7/08	JWP	BIKE PATH REVISION PER COMMENT
10/27/08	JWP	UPDATE STANDARDS

ILLINOIS DEPARTMENT OF TRANSPORTATION  
COVER SHEET  
CARDINAL DRIVE

SCALE: \_\_\_\_\_ DRAWN BY: MJO/AJC  
DATE: 1/4/08 CHECKED BY: JWP

CONTRACT NO.: 87342