

RTE. NO.	SECTION	COUNTY	TOTAL SHEETS	SHEET NO.
CH 12	07-00118-00-BR	LOGAN	12	12
STA. 20+00		STA.		
FED. ROAD DIST.	ILLINOIS	FED. AID PROJECT		

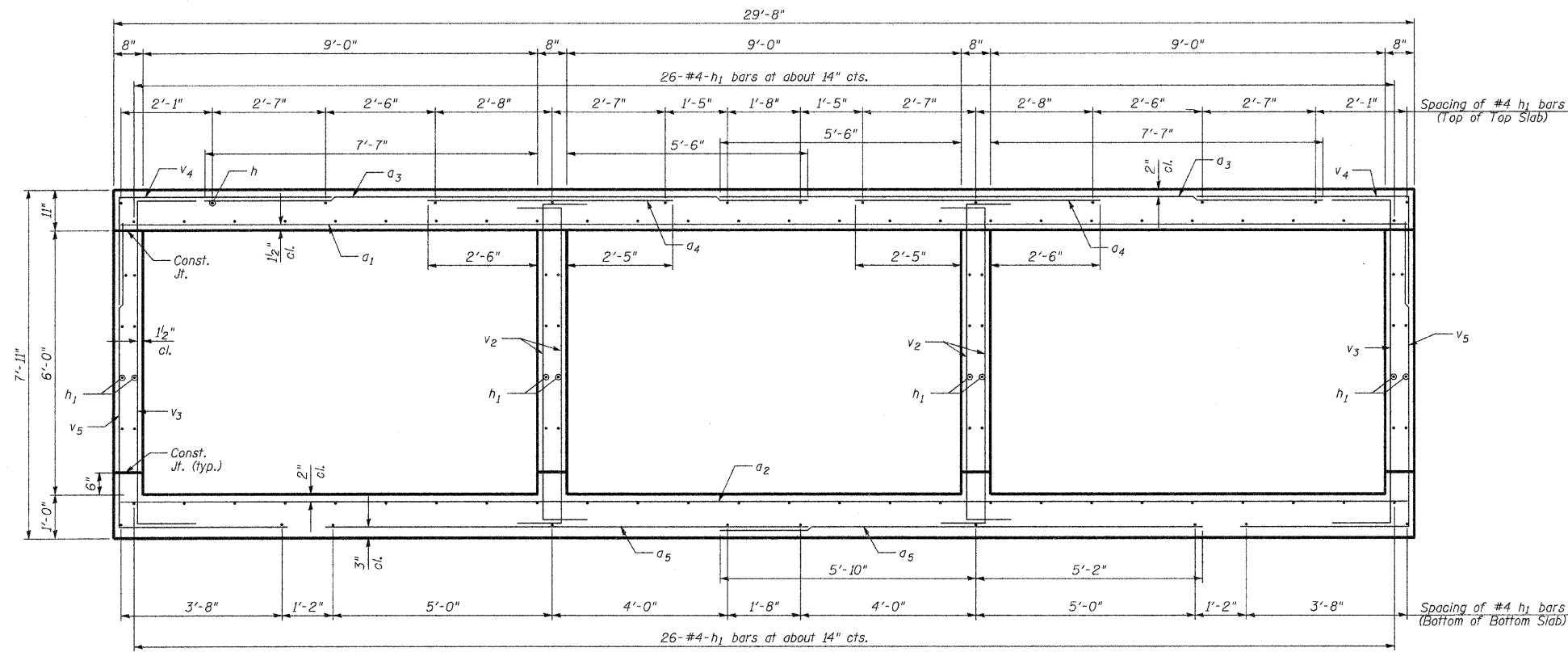

SECTION THRU BARREL

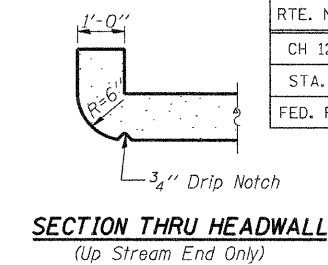

SECTION THRU HEADWALL
(Up Stream End Only)

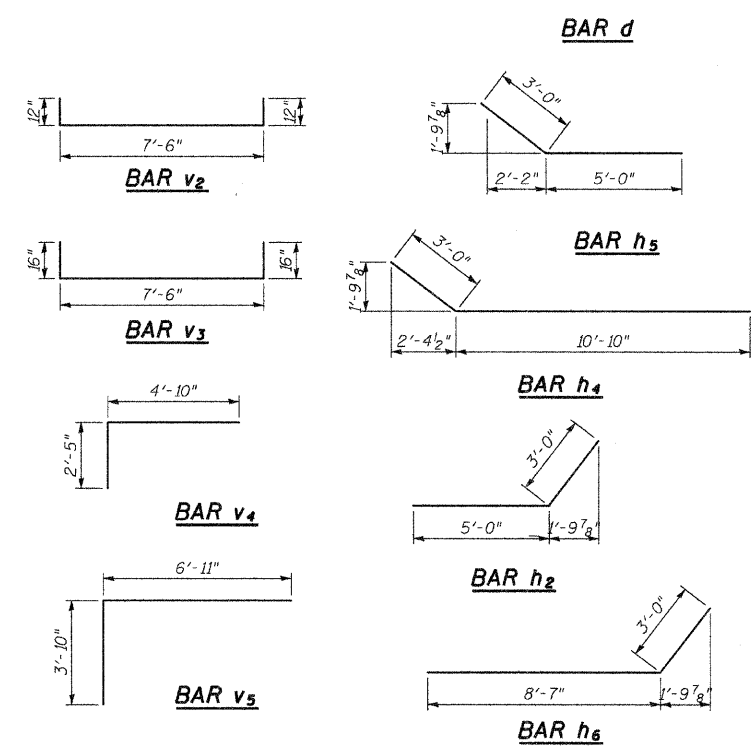

BILL OF MATERIAL

Bar No.	Size	Length	Shape
a1	#5	29'-4"	—
a2	#4	29'-4"	—
a3	#5	13'-9"	—
a4	#5	5'-7"	—
a5	#5	11'-0"	—
d	#4	4'-6"	┌
h1	#4	24'-4"	—
h2	#6	8'-0"	└
h3	#6	29'-10"	—
h4	#8	13'-10"	—
h5	#8	8'-0"	—
h6	#6	11'-7"	—
v	#4	7'-7"	—
v1	#4	10'-2"	—
v2	#5	9'-6"	—
v3	#5	10'-2"	—
v4	#5	7'-3"	—
v5	#5	10'-9"	—
Removal of Existing Structures			L. Sum 1
Structure Excavation			Cu. Yd. 71
Reinforcement Bars			Pound 19,840
Concrete Box Culverts			Cu. Yd. 143.9

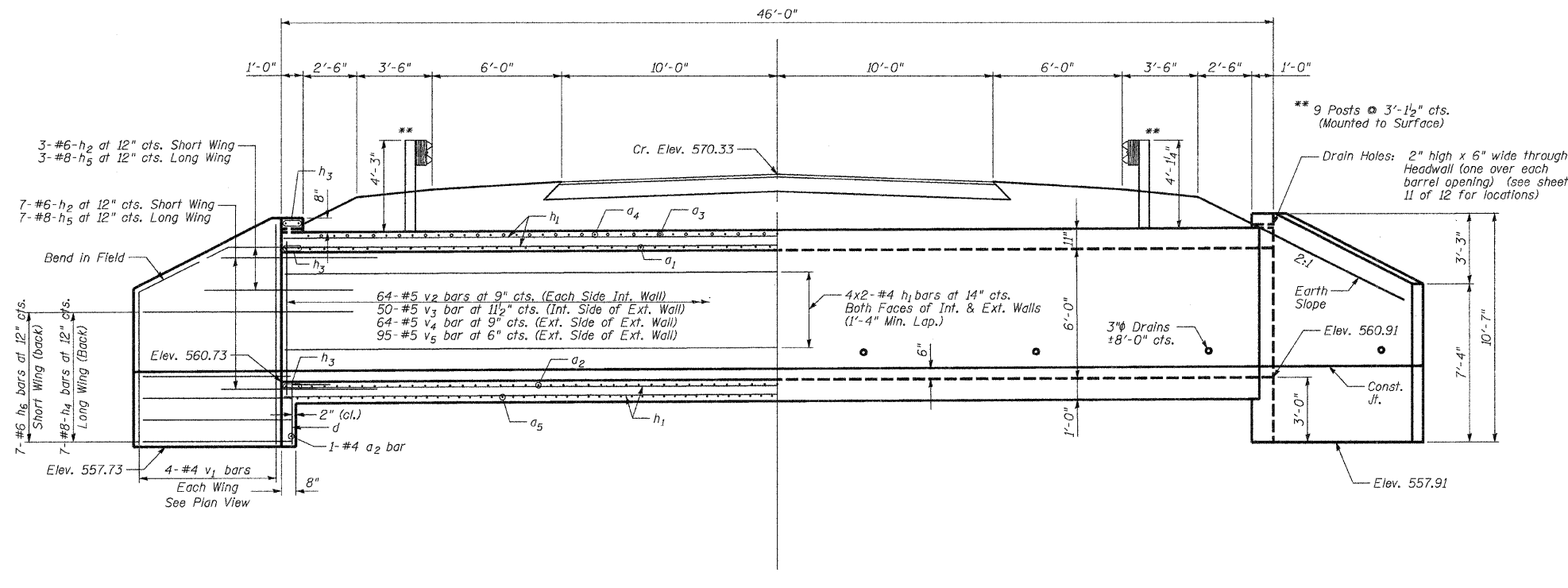

HALF LONG. SECTION

HALF ELEVATION

Dimensions at Rt. L's to Ⓢ Roadway

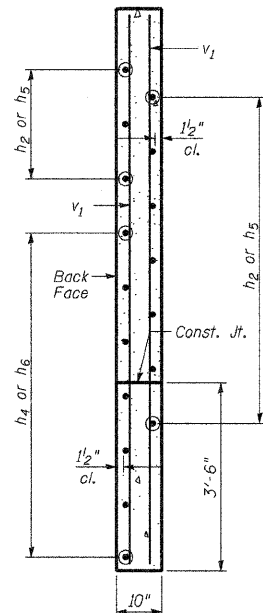

SECTION A-A

CULVERT DETAILS
CH 12 OVER
LAKE FORK CREEK TRIBUTARY
STATION 20+00.00

FILE NAME = R07013.PLAN.dgn	USER NAME = default	DESIGNED - JLS	REVISED -	STATE OF ILLINOIS DEPARTMENT OF TRANSPORTATION	CULVERT DETAILS	F.A. RTE.	SECTION	COUNTY	TOTAL SHEETS	SHEET NO.		
		DRAWN - JLS	REVISED -			07-00118-00-BR	LOGAN	12	12			
		CHECKED - CSB	REVISED -			SN 054-3921	CONTRACT NO.					
		DATE - JUN 2008	REVISED -			SCALE:		SHEET NO. 3 OF 3 SHEETS		STA. 20+00 TO STA.		FED. ROAD DIST. NO.