

ROUTE NO.	SECTION	COUNTY	TOTAL SHEETS	SHEET NO.
CH 9	*	CASS	29	5
FED. ROAD DIST. NO. 7		ILLINOIS	PROJECT	BRS-580(105)
*04-00068-00-BR		CONTRACT #		93474

- 1 ROAD CLOSED 1 3/4 MILES AHEAD LOCAL TRAFFIC ONLY R11-3 ROAD CLOSED 1 3/4 MILES AHEAD LOCAL TRAFFIC ONLY R11-3
- 2 COUNTY HIGHWAY 9 CLOSED WEST OF ARENZVILLE 1 1/2 MILES AHEAD M3-1 COUNTY HIGHWAY 9 CLOSED WEST OF ARENZVILLE 1 1/2 MILES AHEAD M3-1
- 3 COUNTY HIGHWAY 9 CLOSED WEST OF ARENZVILLE 1 1/4 MILES AHEAD M3-1 COUNTY HIGHWAY 9 CLOSED WEST OF ARENZVILLE 1 1/4 MILES AHEAD M3-1
- 4 ROAD CLOSED AHEAD W20-3 ROAD CLOSED AHEAD W20-3
- 5 ROAD CLOSED 500 FT W20-3 ROAD CLOSED 500 FT W20-3
- 6 AS SHOWN M5-1R
- 7 TYPE III BARRICADES EACH WITH 2 TYPE A FLASHING LIGHTS

SEE STANDARD BLR 21 AND SPECIAL PROVISIONS

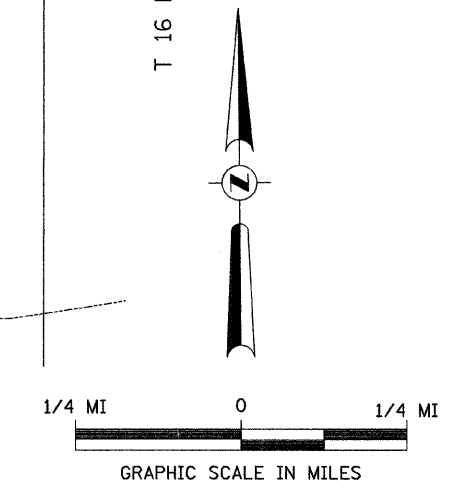
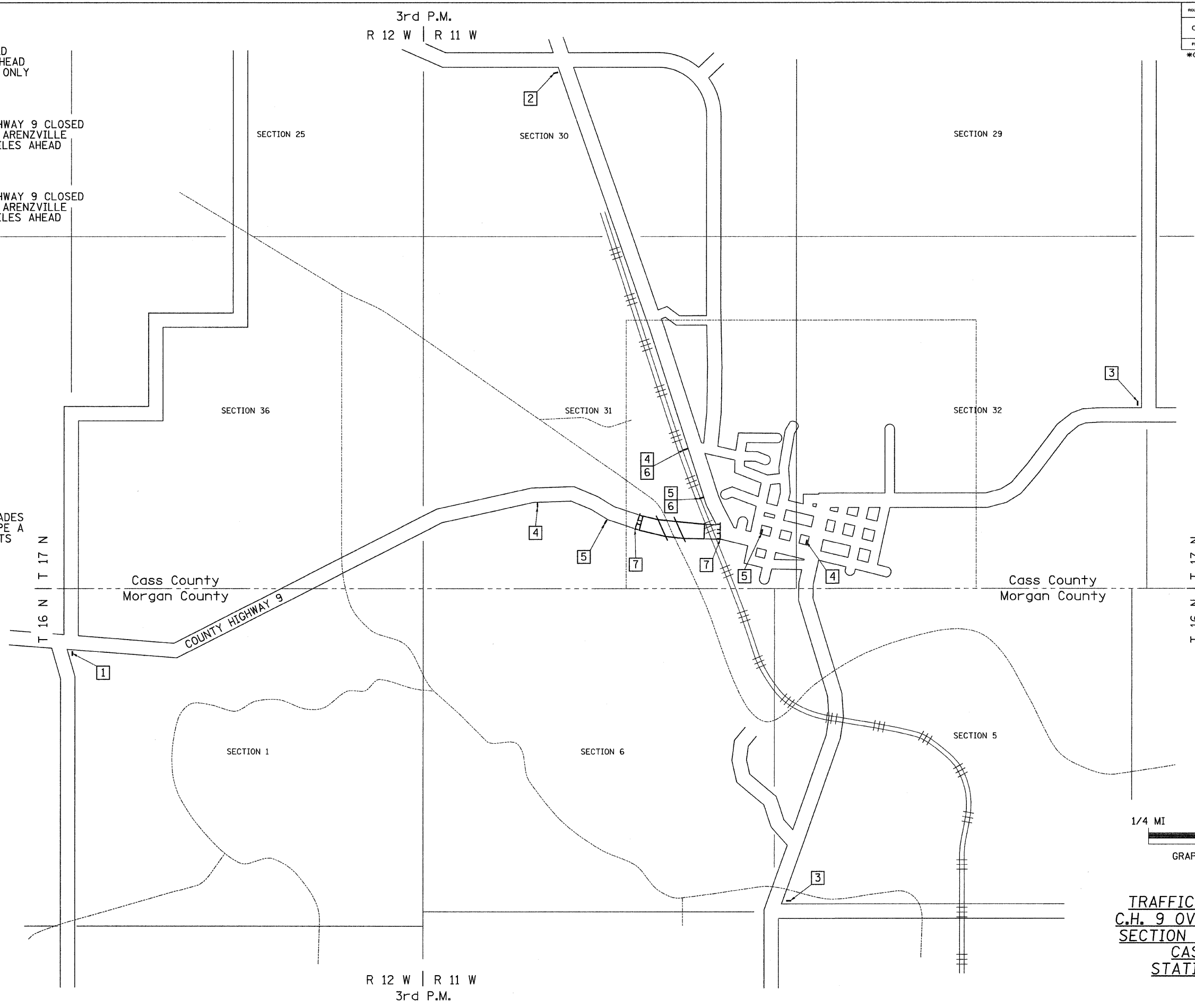

TRAFFIC CONTROL PLAN
C.H. 9 OVER INDIAN CREEK
SECTION 04-00068-00-BR
CASS COUNTY
STATION 49+92.52