

F.A.S.	SECTION	COUNTY	TOTAL SHEETS	SHEET NO.
653	04-00256-00-BR	SHELBY	40	11
STA. 14+50		TO STA. 27+00		
FED. ROAD DIST. NO.		ILLINOIS FED. AID PROJECT		

Contract No. 95555

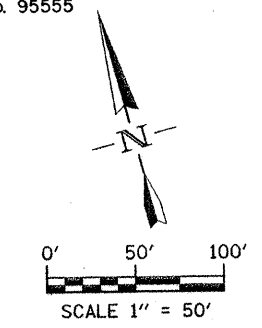

S.W. 1/4, S.W. 1/4, SEC. 27, T. 10 N., R. 4 E., 3rd P.M.

CURVE 1 DATA
 PI STA. 17+31.97
 $\Delta = 17^\circ 36' 07''$ (RT)
 $D = 5^\circ 43' 46''$
 $R = 1,000.00'$
 $T = 154.83'$
 $L = 307.21'$
 $E = 11.91'$
 $e = 0.055''$
 $T.R. = 41'$
 $S.E. RUN = 112'$
 $P.C. STA. 15+77.14$
 $P.T. STA. 18+84.36$
 $S.E. ATTAINED FROM STA. 14+61.47$ TO STA. 16+14.47
 $S.E. REMOVED FROM STA. 18+47.03$ TO STA. 20+00.03

CURVE 2 DATA
 PI STA. 24+01.56
 $\Delta = 10^\circ 03' 37''$ (RT)
 $D = 5^\circ 43' 46''$
 $R = 1,000.00'$
 $T = 88.02'$
 $L = 175.58'$
 $E = 3.87'$
 $e = 0.055''$
 $T.R. = 41'$
 $S.E. RUN = 112'$
 $P.C. STA. 23+13.54$
 $P.T. STA. 24+89.12$
 $S.E. ATTAINED FROM STA. 21+97.87$ TO STA. 23+50.87
 $S.E. REMOVED FROM STA. 24+51.79$ TO STA. 26+04.79

Note: Sta. 296+00 to Sta. 303+00 is along \bar{C} of Existing Alignment.

See Details Sheet 10 of 40 Sheets for STAGE ONE Construction Details and Schedules.

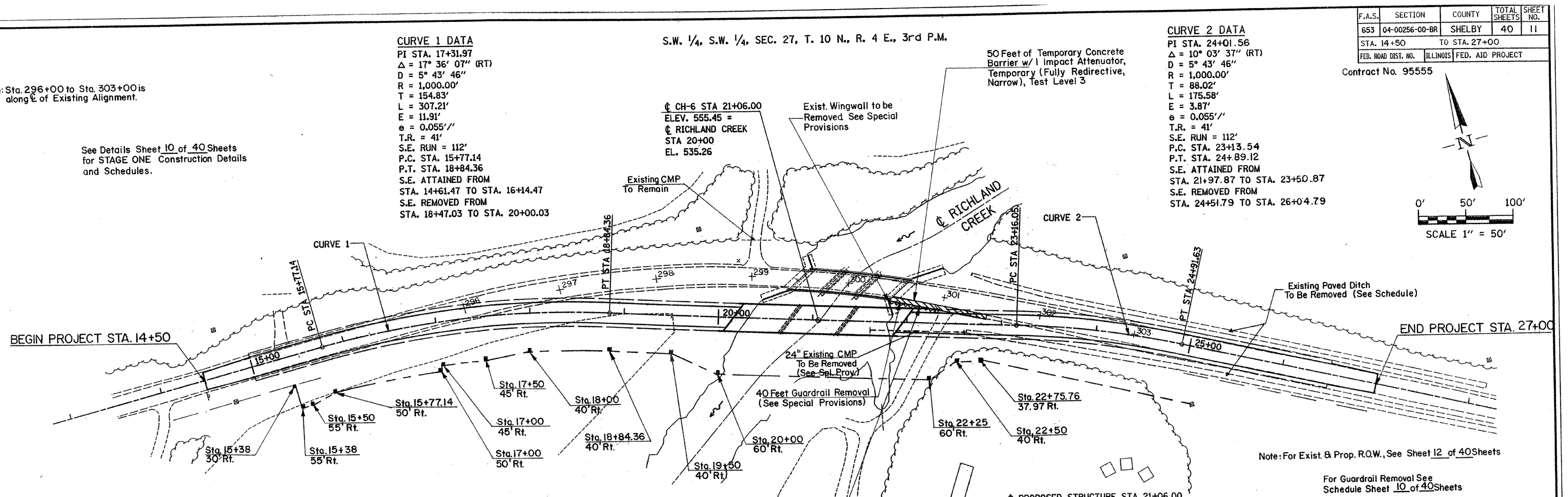

STAGE ONE CONSTRUCTION

ROADWAY WIDTH TRANSITIONS

STA. 14+50 TO STA. 15+00
 STA. 26+50 TO STA. 27+00

For proposed \bar{C} location, see Layout Page Sheet 4 of 40 Sheets

N.W. 1/4, N.W. 1/4, SEC. 34, T. 9 N., R. 4 E., 3rd P.M.

PC.C. BASE CSE. WIDENING 8" Rt. Sta. 300+50 To Sta. 301+50

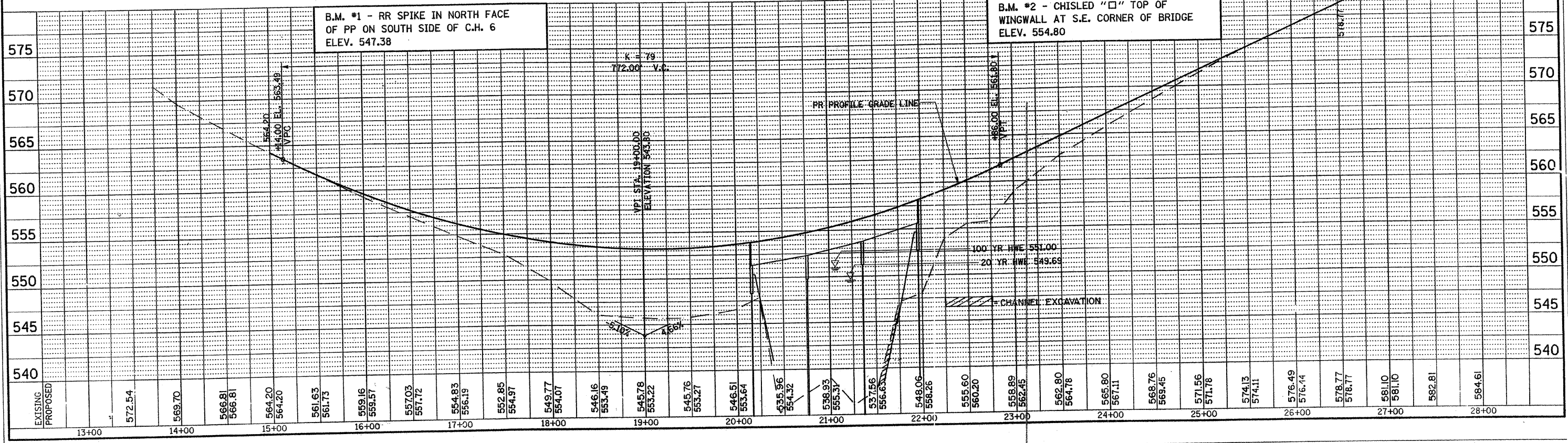

EXISTING	PROPOSED	13+00	14+00	15+00	16+00	17+00	18+00	19+00	20+00	21+00	22+00	23+00	24+00	25+00	26+00	27+00	28+00																																								
		572.54	569.70	566.81	566.81	564.20	564.20	561.63	561.73	559.16	559.57	557.03	557.72	554.83	556.19	552.85	554.97	549.77	554.07	546.16	553.49	545.78	553.22	545.76	553.27	546.51	553.64	535.96	554.32	536.93	555.37	537.56	556.63	548.06	558.26	555.60	560.20	558.89	562.45	562.80	564.78	565.80	567.11	568.76	569.45	571.56	571.78	574.13	574.11	576.49	576.14	578.77	578.77	581.10	581.10	582.81	584.61