

F.A.S.	SECTION	COUNTY	TOTAL SHEETS	SHEET NO.
653	04-00256-00-BR	SHELBY	40	19
STA. 14+50		TO STA. 27+00		
FED. ROAD DIST. NO.	ILLINOIS	FED. AID PROJECT		

Contract No. 95555

**DESCRIPTION OF INTENDED SEQUENCE OF MAJOR CONSTRUCTION ACTIVITIES WHICH WILL DISTURB EARTH AND LEAD TO POSSIBLE EROSION FOR MAJOR PORTIONS OF THE CONSTRUCTION SITE.**

1. PLACEMENT OF PERIMETER EROSION CONTROL FENCE PRIOR TO THE COMMENCEMENT OF ANY ROAD OR BRIDGE WORK. SEE STD. 280001.
2. CONSTRUCTION OF THE REPLACEMENT STRUCTURE.
3. PLACEMENT OF ROADWAY EMBANKMENT TO RAISE THE ROADWAY TO THE PROPOSED GRADE.
4. DRAINAGE STRUCTURES, INCLUDING DITCHES, WILL BE INSTALLED BEFORE AND/OR DURING THE COMPLETION OF THE EMBANKMENT.
5. PLACEMENT AND MAINTENANCE OF TEMPORARY EROSION CONTROL.
6. TIE PROPOSED ROADWAY TO EXISTING ROADWAY AND CONSTRUCT SURFACE.
7. REMOVE EXISTING STRUCTURE.
8. PLACEMENT OF PERMANENT EROSION CONTROL.
9. REMOVAL AND PROPER CLEAN UP OF TEMPORARY EROSION CONTROL.
10. FINAL GRADING AND SHAPING, CLEAN UP AND OTHER MISCELLANEOUS ITEMS OF WORK.

**Note:** THE CONTRACTOR SHALL BE RESPONSIBLE FOR REMOVING ALL MUD, DIRT AND DEBRIS DEPOSITED ON THE ROADWAY FROM VEHICLES EXITING OR ENTERING THE SITE.

EARTH STOCK PILES SHALL BE TEMPORARILY SEEDED IF THEY ARE TO REMAIN UNUSED FOR MORE THAN 14 DAYS.

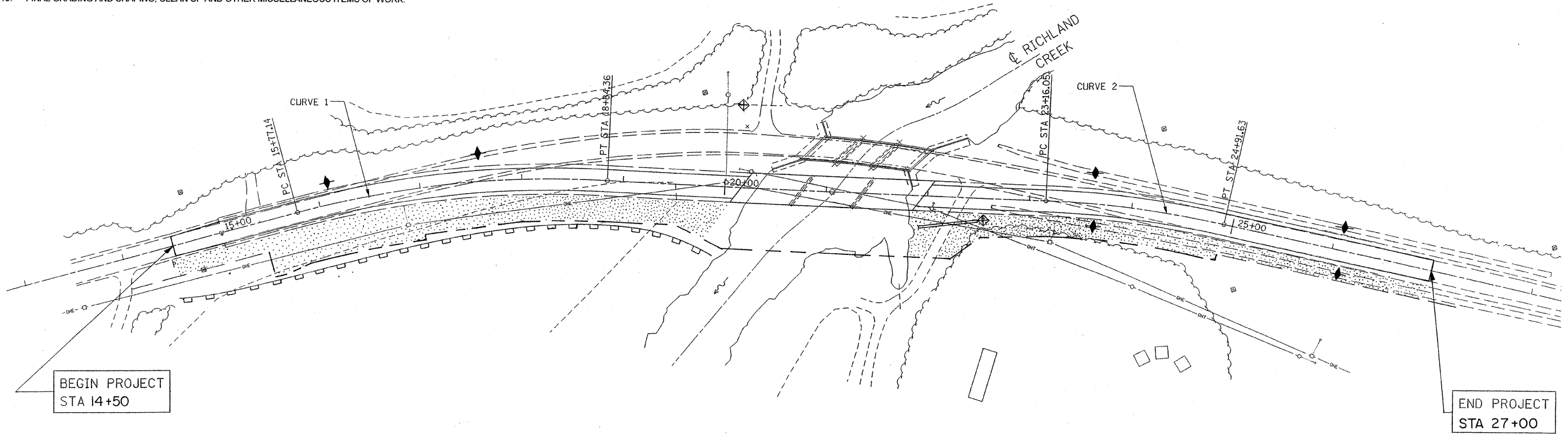
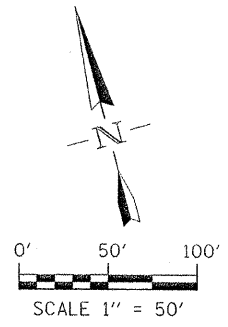

BEGIN PROJECT  
STA 14+50

END PROJECT  
STA 27+00

TEMPORARY EROSION CONTROL	
	PERIMETER EROSION BARRIER
	TEMPORARY DITCH CHECK
	INLET AND PIPE PROTECTION
PERMANENT EROSION CONTROL	
	SEEDING CLASS 2, FERTILIZERS, MULCH METHOD 2

TEMPORARY EROSION CONTROL SCHEDULE				
STA.	LT/RT	OFFSET (FOOT)	TEMP DITCH CHECK (EACH)	INLET & PIPE PROTECTION (EACH)
16+10	LT	20.00	1	
17+16	LT	27.00	1	
23+60	LT	30.00	1	
23+62	RT	23.00	1	
26+10	LT	21.00	1	
26+10	RT	23.00	1	
20+15	LT	80.00		1
22+50	RT	21.00		1
<b>TOTAL</b>			<b>6</b>	<b>2</b>

BILL OF MATERIAL		
ITEM	UNIT	QTY.
TEMPORARY EROSION CONTROL SEEDING	POUND	1600
TEMPORARY DITCH CHECKS	EACH	6
PERIMETER EROSION BARRIER	FOOT	550
INLET AND PIPE PROTECTION	EACH	2

THE ABOVE QUANTITIES ARE ESTIMATES ONLY. ACTUAL QUANTITIES FOR EROSION CONTROL WILL BE DETERMINED BY THE ENGINEER IN THE FIELD AND THERE WILL BE NO ADJUSTMENT IN ANY PRICE DUE TO A CHANGE IN PLAN QUANTITY.

<b>EROSION CONTROL PLAN</b>
SECTION 04-00256-00-BR

FILE: G:\504078\CAD\TO COUNTY\4078PP\02.DWG/2008 11:45:52 AM