

F&P SHEET NO.	SECTION	COUNTY	TOTAL SHEETS	SHEET NO.
	05-00016-03-BR	MADISON	129	31
STA. 38+00		TO STA. 43+50		

CONTRACT NO.: 97351  
ADDENDUM #1 01-02-2009

DATE	7/27/06
BY	J.T.F.
CHECKED	E.S.O.
DATE	7/27/06
NO.	

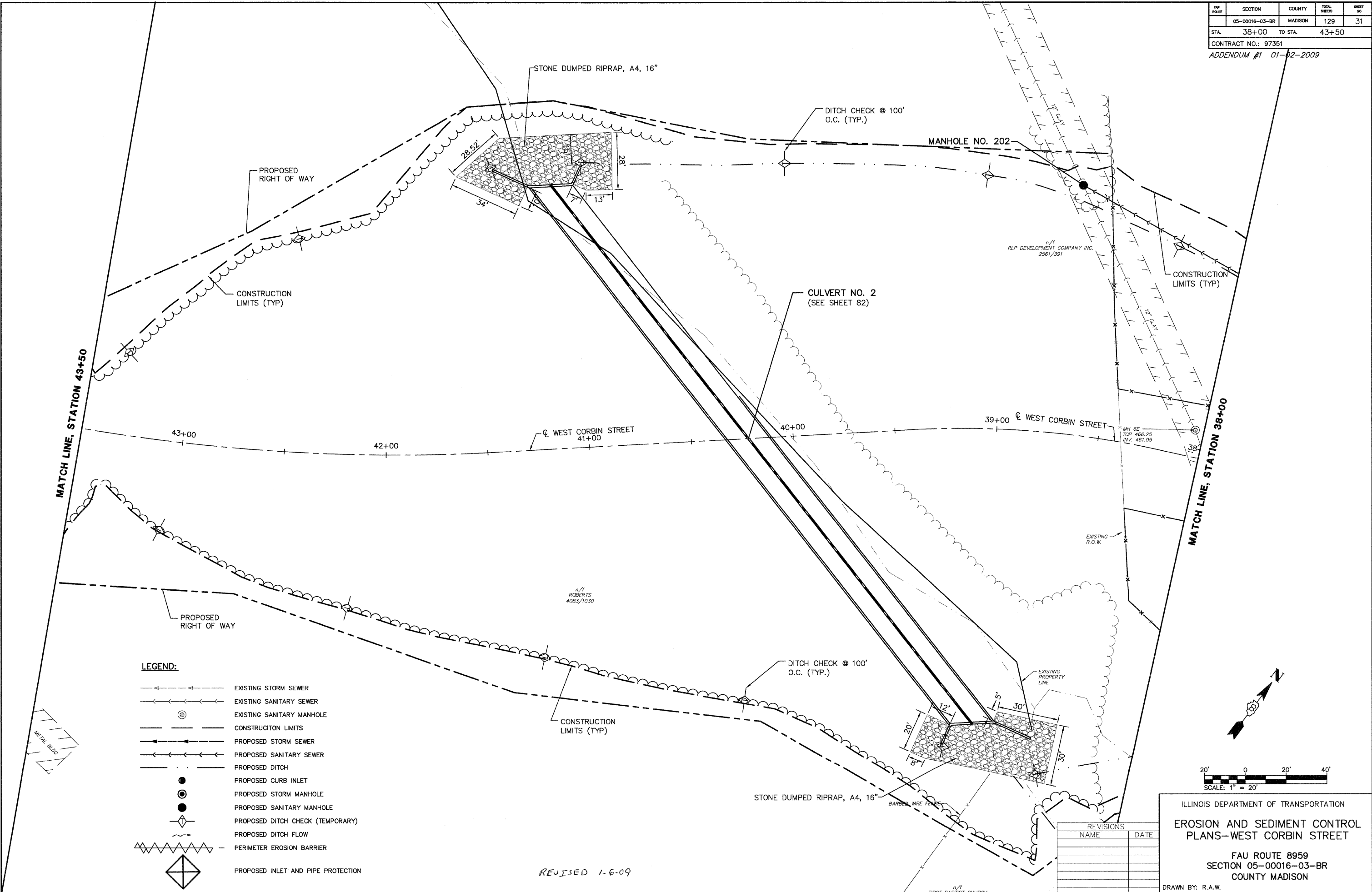

**LEGEND:**

	EXISTING STORM SEWER
	EXISTING SANITARY SEWER
	EXISTING SANITARY MANHOLE
	CONSTRUCTION LIMITS
	PROPOSED STORM SEWER
	PROPOSED SANITARY SEWER
	PROPOSED DITCH
	PROPOSED CURB INLET
	PROPOSED STORM MANHOLE
	PROPOSED SANITARY MANHOLE
	PROPOSED DITCH CHECK (TEMPORARY)
	PROPOSED DITCH FLOW
	PERIMETER EROSION BARRIER
	PROPOSED INLET AND PIPE PROTECTION

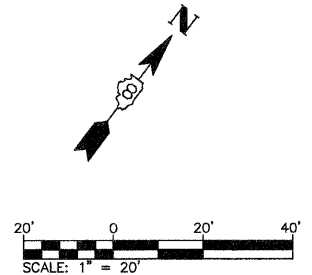

REVISIONS	
NAME	DATE

ILLINOIS DEPARTMENT OF TRANSPORTATION  
**EROSION AND SEDIMENT CONTROL PLANS—WEST CORBIN STREET**  
 FAU ROUTE 8959  
 SECTION 05-00016-03-BR  
 COUNTY MADISON  
 DRAWN BY: R.A.W.

REVISED 1-6-09