

028

01-17-2020 LETTING ITEM 028

F.A.P. RTE.	SECTION	COUNTY	TOTAL SHEETS	SHEET NO.
599	D2 RS 2020-4	ROCK ISLAND	12	1

STATE OF ILLINOIS
DEPARTMENT OF TRANSPORTATION
DIVISION OF HIGHWAYS

**PROPOSED
HIGHWAY PLANS**

FAP ROUTE 599 (US 67)
SECTION D2 RS 2020-4
ROCK ISLAND COUNTY
C-92-008-20

FOR INDEX OF SHEETS, SEE SHEET NO. 2
FOR STATE STANDARDS, SEE SHEET NO. 2

D-92-011-20



LOCATION OF SECTION INDICATED THIS: - [shaded area] -

SECTION BEGINS
STA. 0+00

SECTION ENDS
STA. 10+57

T-18-N

R-2-W

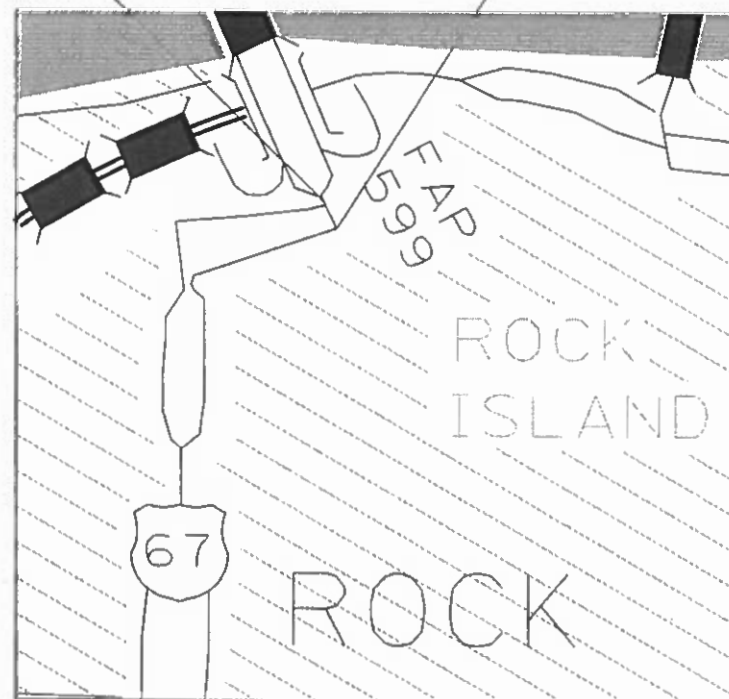

ROCK ISLAND TOWNSHIP,
SECTION 35

J.U.L.I.E.
JOINT UTILITY LOCATION INFORMATION FOR EXCAVATION
1-800-892-0123

SQUAD LEADER: LANCE NICKLAUS 815-284-5407
PROJECT ENGINEER: SCOTT KULLERSTRAND

CONTRACT 64P08

GROSS LENGTH = 1057 LIN. FT. = 0.20 MILES
NET LENGTH = 1057 LIN. FT. = 0.20 MILES

STATE OF ILLINOIS
DEPARTMENT OF TRANSPORTATION
DIVISION OF HIGHWAYS

SUBMITTED Oct 11th 2019

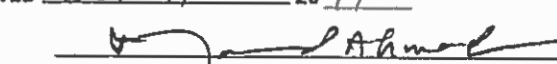
REGION ENGINEER

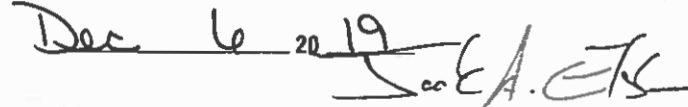
Dec 6 2019

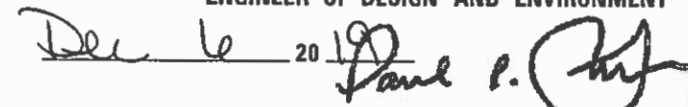
ENGINEER OF DESIGN AND ENVIRONMENT

Dec 6 2019

DIRECTOR OF HIGHWAYS PROJECT IMPLEMENTATION

PRINTED BY THE AUTHORITY
OF THE STATE OF ILLINOIS

INDEX

	STATE STANDARDS	
1	Cover Sheet	701602-10
2	Index of Sheets / State Standards	701606-10
3	General Notes	701701-10
4-5	Summary of Quantities	701901-08
6-8	Schedule Of Quantities	720011-01
9-11	Typicals	728001-01
12	Plan Sheet	729001-01
		780001-05

DISTRICT STANDARDS

94.2	Traffic Control & Protection at Turn Bays (To Remain Open To Traffic)
34.1	Work Zone Sign Details
35.1	Urban Lane Inside Closure, Multilane, 2w, with Mountable Median
41.1	Typical Pavement Markings

SUMMARY OF QUANTITIES

FAP 599 (US 67)
SECTION D2 RS 2020-4
ROCK ISLAND COUNTY
CONTRACT # 64P08
SHEET 4 OF 12

URBAN

100% State
0005

CODE NO.	ITEM	UNIT	TOTAL QUANTITY
40600290	BITUMINOIUS MATERIALS (TACK COAT)	POUND	4780
40600990	TEMPORARY RAMP	SQ YD	366
40600637	LEVELING BINDER (MACHINE METHOD) IL-9.5FG, N70	TON	397
40603390	HOT-MIX ASPHALT SURFACE COURSE, MIX "F", N70	TON	653
44000158	HOT-MIX ASPHALT SURFACE REMOVAL 2 1/4"	SQ YD	7081
60255500	MANHOLES TO BE ADJUSTED WITH NEW TYPE 1 FRAME, CLOSED LID	EACH	11
60266600	VALVE BOXES TO BE ADJUSTED	EACH	3
67100100	MOBILIZATION	L SUM	1
70102625	TRAFFIC CONTROL AND PROTECTION, STANDARD 701606	L SUM	1
70102632	TRAFFIC CONTROL AND PROTECTION, STANDARD 701602	L SUM	1
70102635	TRAFFIC CONTROL AND PROTECTION, STANDARD 701701	L SUM	1
70200100	NIGHTTIME WORK ZONE LIGHTING	L SUM	1
70300100	SHORT TERM PAVEMENT MARKING	FOOT	2859
70300150	SHORT TERM PAVEMENT MARKING REMOVAL	SQ FT	317

* Specialty Items

REV. 12/04/19

SUMMARY OF QUANTITIES

FAP 599 (US 67)
SECTION D2 RS 2020-4
ROCK ISLAND COUNTY
CONTRACT # 64P08
SHEET 5 OF 12

URBAN
100% State
0005

CODE NO.	ITEM	UNIT	TOTAL QUANTITY
* 78000100	THERMOPLASTIC PAVEMENT MARKING - LETTERS AND SYMBOLS	SQ FT	109.2
* 78000200	THERMOPLASTIC PAVEMENT MARKING - LINE 4"	FOOT	2518
* 78000400	THERMOPLASTIC PAVEMENT MARKING - LINE 6"	FOOT	1353
* 78000500	THERMOPLASTIC PAVEMENT MARKING - LINE 8"	FOOT	294
* 78000600	THERMOPLASTIC PAVEMENT MARKING - LINE 12"	FOOT	203
* 78000650	THERMOPLASTIC PAVEMENT MARKING - LINE 24"	FOOT	134
Z0033700	LONGITUDINAL JOINT SEALANT	FOOT	5285

* Specialty Items

REV. 12/04/19

SCHEDULE OF QUANTITIES

FAP 599 (US 67)
SECTION D2 RS 2020-4
ROCK ISLAND COUNTY
CONTRACT #64P08
SHEET 6 of 12

40600290 BITUMINOUS MATERIALS (TACK COAT)

<u>LOCATION</u>	<u>POUND</u>	<u>REMARKS</u>
STA. 0+00 - 10+57	4780	
	<u>4780</u>	

40600990 TEMPORARY RAMP

<u>LOCATION</u>	<u>SQ YD</u>	<u>REMARKS</u>
STA.0+00 - 0+07.5	48	
3rd Ave West	54	7.5'
3rd Ave East	59	7.5'
4th Ave West	43	7.5'
4th Ave East	42	7.5'
5th Ave West	41	7.5'
5th Ave East	40	7.5'
STA. 10+49.5 - 10+57	39	
	<u>366</u>	

40600637 LEVELLING BINDER (MACHINE METHOD) IL - 9.5 FG, N70

<u>LOCATION</u>	<u>TON</u>	<u>REMARKS</u>
STA. 0+00 - 10+57	397	
	<u>397</u>	

40603390 HOT-MIX ASPHALT SURFACE COURSE, MIX "F", N70

<u>LOCATION</u>	<u>TON</u>	<u>REMARKS</u>
STA. 0+00 - 10+57	653	
	<u>653</u>	

44000158 HOT-MIX ASPHALT SURFACE REMOVAL 2 1/4"

<u>LOCATION</u>	<u>SQ YD</u>	<u>REMARKS</u>
STA. 0+00 - 10+57	7081	
	<u>7081</u>	

60255500 MANHOLES TO BE ADJUSTED WITH NEW TYPE 1 FRAME, CLOSED LID

<u>LOCATION</u>	<u>EACH</u>	<u>REMARKS</u>
STA. 0+10	1	RT
STA. 1+02	1	LT
STA. 3+33	1	RT
STA. 3+37	1	RT
STA. 3+32	1	LT
STA. 7+08	1	LT
STA. 7+25	1	RT
STA. 7+36	1	LT
STA. 7+41	1	RT
STA. 10+16	1	RT
STA. 10+18	1	LT
	<u>11</u>	

60266600 VALVE BOXES TO BE ADJUSTED

<u>LOCATION</u>	<u>EACH</u>	<u>REMARKS</u>
STA. 3+44	1	RT
STA. 6+77	1	RT
STA. 10+08	1	RT
	<u>3</u>	

70300100 SHORT TERM PAVEMENT MARKING

(3 Applications)

<u>LOCATION</u>	<u>FOOT</u>	<u>REMARKS</u>
STA. 0+00 - 10+57	317	White Skip
STA. 0+00 - 10+57	317	Yellow Skip
STA. 0+00 - 10+57	317	White Skip
STA. 1+81 - 2+86	312	White Turn Lane
STA. 3+78 - 4+68	270	White Turn Lane
STA. 8+75 - 9+72	291	White Turn Lane
STA. 0+00 - 10+57	657	White Stop Bars
STA. 0+00 - 10+57	378	White Turn Arrows
	<u>2859</u>	

70300150 SHORT TERM PAVEMENT MARKING REMOVAL

<u>LOCATION</u>	<u>SQ FT</u>	<u>REMARKS</u>
STA. 0+00 - 10+57	35	White Skip
STA. 0+00 - 10+57	35	Yellow Skip
STA. 0+00 - 10+57	35	White Skip
STA. 1+81 - 2+86	35	White Turn Lane
STA. 3+78 - 4+68	30	White Turn Lane
STA. 8+75 - 9+72	32	White Turn Lane
STA. 0+00 - 10+57	73	White Stop Bars
STA. 0+00 - 10+57	42	White Turn Arrows
	<u>317</u>	

78000100 THERMOPLASTIC PAVEMENT MARKING - LETTERS AND SYMBOLS

<u>LOCATION</u>	<u>SQ FT</u>	<u>REMARKS</u>
STA. 2+19	15.6	Left Turn Arrow
STA. 2+71	15.6	Left Turn Arrow
STA. 3+94	15.6	Left Turn Arrow
STA. 4+32	15.6	Left Turn Arrow
STA. 8+55	15.6	Left Turn Arrow
STA. 9+05	15.6	Left Turn Arrow
STA. 9+55	15.6	Left Turn Arrow
	<u>109.2</u>	

78000200 THERMOPLASTIC PAVEMENT MARKING - LINE 4"

<u>LOCATION</u>	<u>FOOT</u>	<u>REMARKS</u>
2nd Ave - 3rd Ave	128	White Parking lines
STA. 0+00 - 10+57	380	White Skip / NB & SB
STA. 0+00 - 1+68	334	Yellow Median, Single Line
STA. 1+68 - 2+87	238	Double Yellow
STA. 3+78 - 5+01	246	Double Yellow
TSA. 5+01 - 6+93	772	Double Yellow Median
STA. 7+70 - 9+73	388	Double Yellow
15th & 5th Intersection	32	White Turkey Tracks
	<u>2518</u>	

78000400 THERMOPLASTIC PAVEMENT MARKING - LINE 6"

<u>LOCATION</u>	<u>FOOT</u>	<u>REMARKS</u>
STA. 0+00 - 0+06	113	WHITE CROSS WALKS
15th & 3rd Intersection	502	WHITE CROSS WALKS
15th & 4th Intersection	418	WHITE CROSS WALKS
15th & 5th Intersection	320	WHITE CROSS WALKS
	<u>1353</u>	

78000500 THERMOPLASTIC PAVEMENT MARKING - LINE 8"

<u>LOCATION</u>	<u>FOOT</u>	<u>REMARKS</u>
STA. 1+81 - 2+87	106	White Turn Lane
STA. 3+79 - 4+69	90	White Turn Lane
STA. 8+76 - 9+73	98	White Turn Lane
	<u>294</u>	

78000600 THERMOPLASTIC PAVEMENT MARKING - LINE 12"

<u>LOCATION</u>	<u>FOOT</u>	<u>REMARKS</u>
STA. 0+00 - 1+68	111	Yellow Diagonals
STA. 5+01 - 6+93	92	Yellow Diagonals
	<u>203</u>	

78000650 THERMOPLASTIC PAVEMENT MARKING - LINE 24"

<u>LOCATION</u>	<u>FOOT</u>	<u>REMARKS</u>
STA. 2+88	32	White Stop Bar
STA. 3+78	33	White Stop Bar
STA. 6+91	21	White Stop Bar
STA. 7+79	28	White Stop Bar
STA. 9+73	20	White Stop Bar
	<u>134</u>	

Z0033700 LONGITUDINAL JOINT SEALANT

<u>LOCATION</u>	<u>FOOT</u>	<u>REMARKS</u>
STA. 0+00 - 10+57	5285	Under Surface Course Only
	<u>5285</u>	

US 67 / 15TH STREET
FROM 2ND AVE. - 3RD AVE.

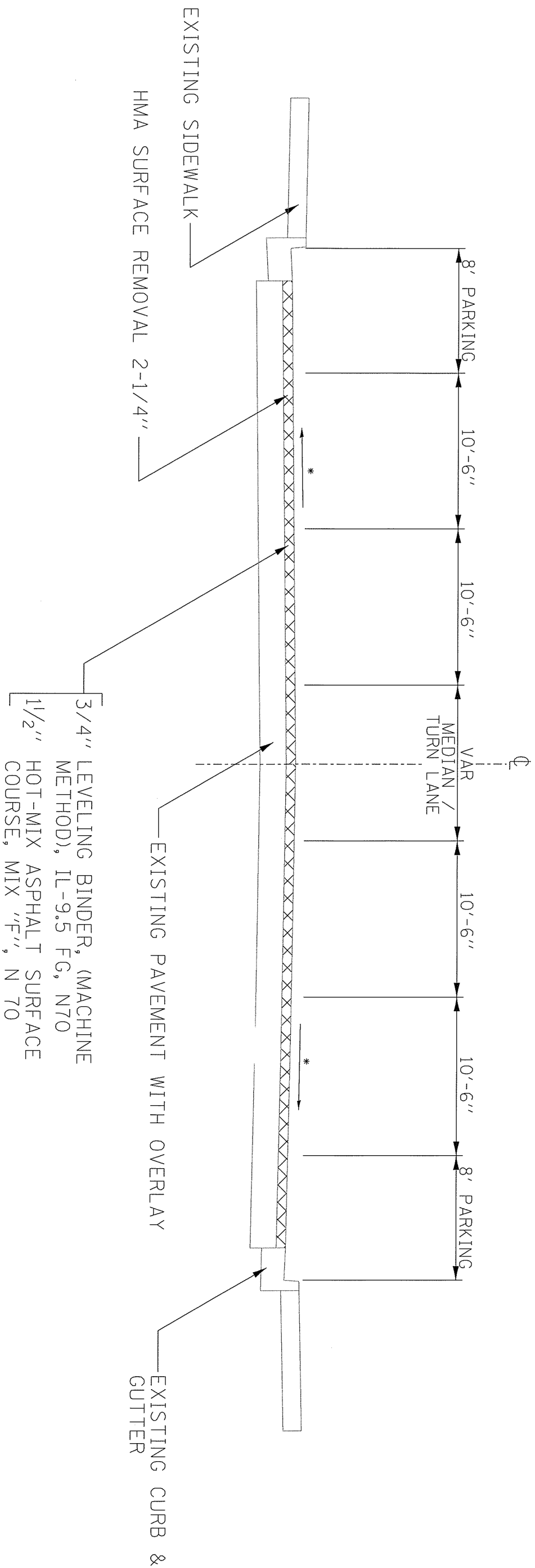

NOTE:
* MAINTAIN EXISTING SLOPE
LONGITUDINAL JOINT SEALANT
PLACED UNDER SURFACE COURSE

USER NAME = Nicklaus	DESIGNED -	REVISED -
PLOT SCALE = 1/2" = 1' / in.	DRAWN -	REVISED -
PLOT DATE = Oct-04-2019 08:24:15 AM	CHECKED -	REVISED -
	DATE -	REVISED -

STATE OF ILLINOIS
DEPARTMENT OF TRANSPORTATION

SCALE: _____	SHEET _____	OF _____	SHEETS	STA. _____	TO STA. _____
--------------	-------------	----------	--------	------------	---------------

F.A.P. NO. 599	SECTION D2 RS 2020-4	COUNTY ROCK ISLAND	TOTAL SHEETS NO. 12
		CONTRACT NO. 64P08	9
ILLINOIS		FED. AID PROJECT	

US 67 / 15TH STREET
FROM 3RD AVE. - 4TH AVE.

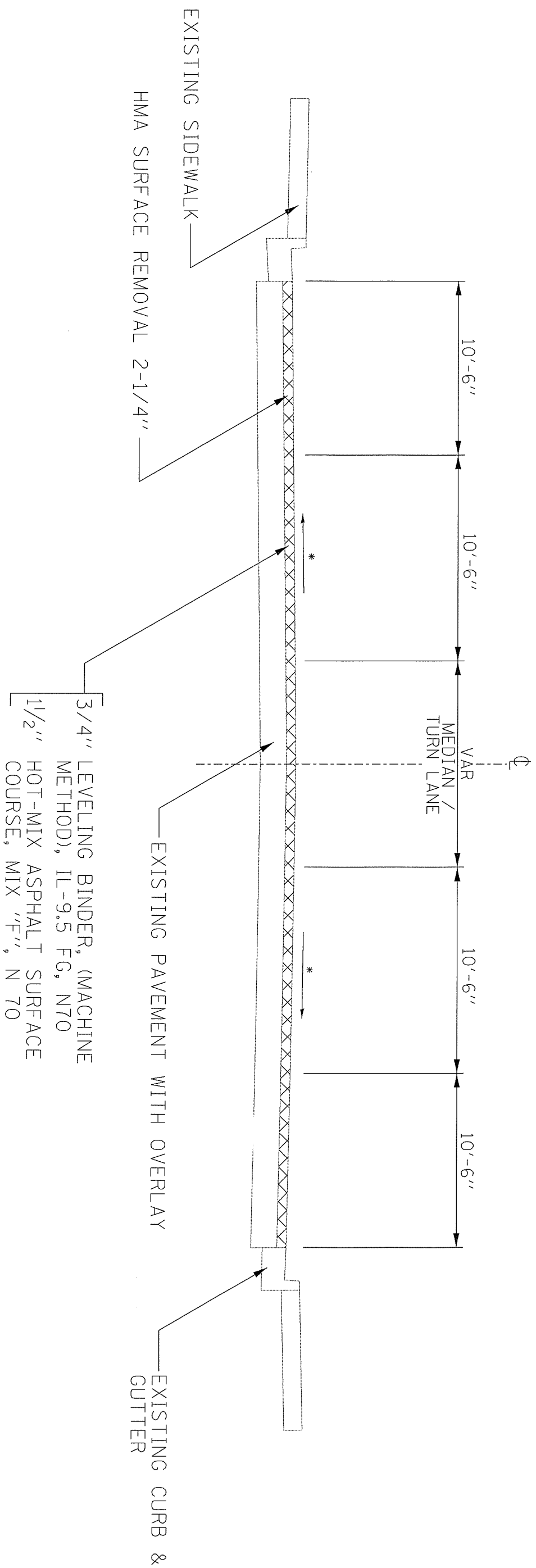

NOTE:
* MAINTAIN EXISTING SLOPE
LONGITUDINAL JOINT SEALANT
PLACED UNDER SURFACE COURSE

USER NAME = Nicklaus	DESIGNED -	REVISIONS
PLOT SCALE = 1/8" = 1' / in.	DRAWN -	REVISIONS
PLOT DATE = 06-04-2019 08:24:32 AM	CHECKED -	REVISIONS
	DATE -	REVISIONS

STATE OF ILLINOIS
DEPARTMENT OF TRANSPORTATION

SCALE:	SHEET	OF	SHEETS	STA.	TO STA.

F.A.P. RTE	SECTION	COUNTY	TOTAL SHEETS	SHEET NO.
599	D2 RS 2020-4	ROCK ISLAND	12	10
ILLINOIS FED. AID PROJECT			CONTRACT NO. 64P08	

US 67 / 15TH STREET
FROM 4TH AVE. - 5TH AVE.

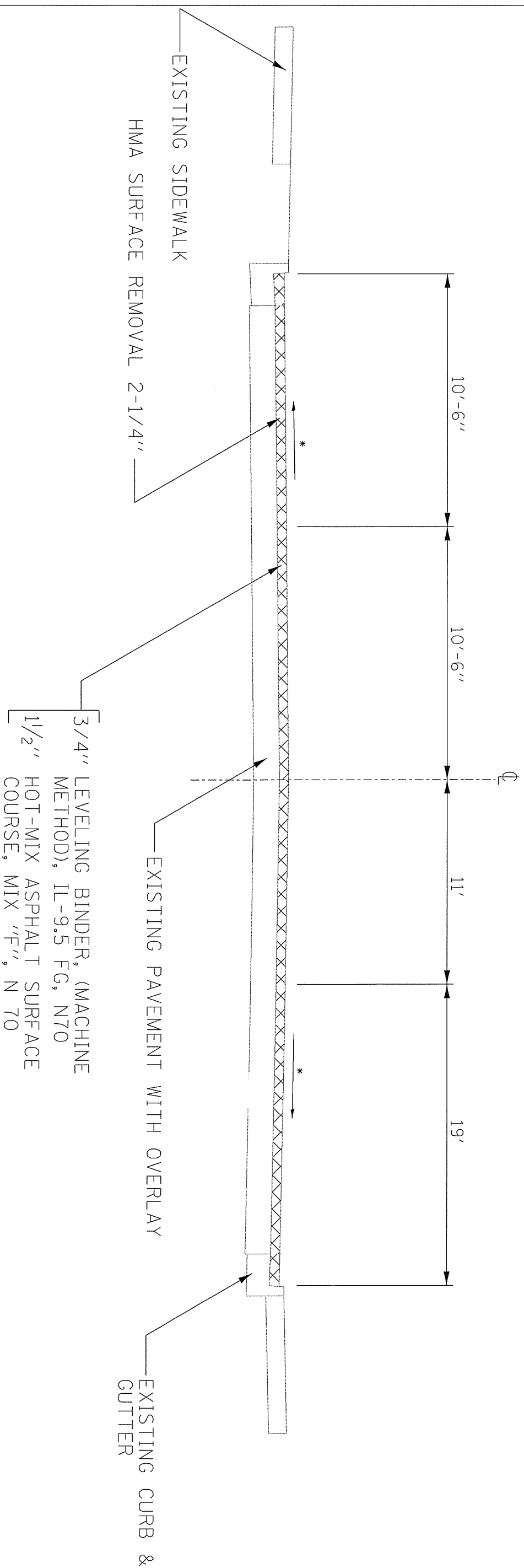

NOTE:
* MAINTAIN EXISTING SLOPE
LONGITUDINAL JOINT SEALANT
PLACED UNDER SURFACE COURSE

USER NAME: * Nicklaus	DESIGNED	REVISIONS
PILOT SCALE = 1" = 17.572' / in.	DRAWN	REVISIONS
PILOT DATE = Oct-04-2019 08:24:48 AM	CHECKED	REVISIONS
	DATE	REVISIONS

STATE OF ILLINOIS
DEPARTMENT OF TRANSPORTATION

SCALE:	SHEET	OF	SHEETS	STA.	TO STA.
--------	-------	----	--------	------	---------

F.A.R. RITE	SECTION	COUNTY	TOTAL SHEET NO.
599	02 RS 2020-4	ROCK ISLAND	12
		CONTRACT NO.	64P08
		ILLINOIS	FED. AID PROJECT

PLAN SHEET

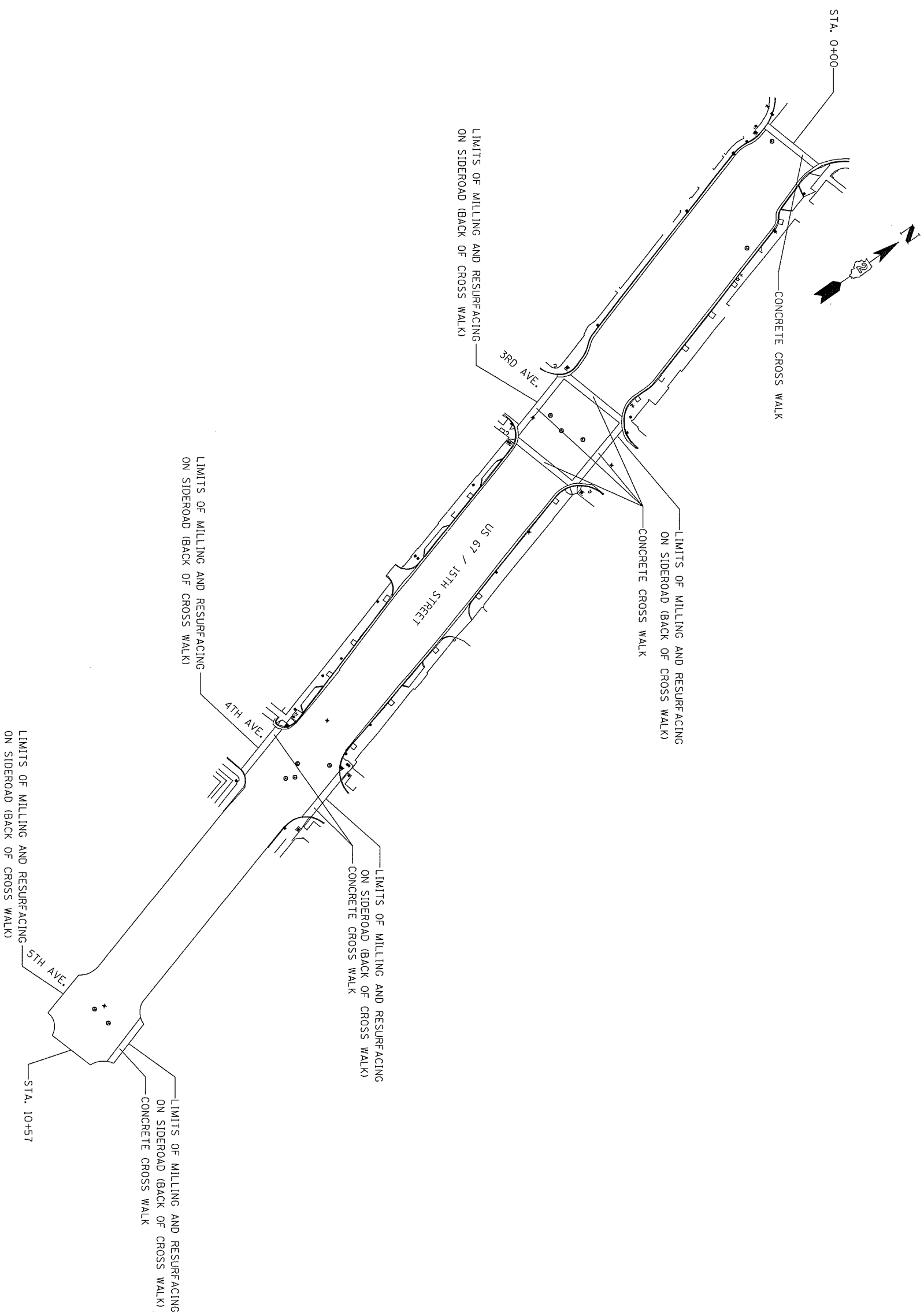

MODEL: Model
 FILE NAME: S:\PL\Nicklaus\FY 20 jobs\Dave SUJS 67 15th St\CADD\2819 TOPO.dgn

USER NAME =	nicklause	DESIGNED -		REVISED -	
PLOT SCALE =	10/324 / in.	DRAWN -		REVISED -	
PLOT DATE =	Oct-04-2019 07:57:19 AM	CHECKED -		REVISED -	
		DATE -		REVISED -	

STATE OF ILLINOIS
DEPARTMENT OF TRANSPORTATION

SCALE:	SHEET	OF	SHEETS	STA.	TO STA.

F.A.P. NO.	SECTION	COUNTY	TOTAL SHEET NO.
599	D2 RS 2020-4	ROCK ISLAND	12
		CONTRACT NO.	64P08
		ILLINOIS	FED. AID PROJECT