

NOTE : SEE SHEETS 5 & 6 FOR DETAILS AND ROW REQUIREMENTS FOR THE ROADSIDE DITCH ALONG THE NORTH SIDE OF ROUTE 125.

PROPOSED ROADSIDE DITCH IMPROVEMENT FROM 3 MILE LANE, EAST TO THE EXISTING 36" RCP'S

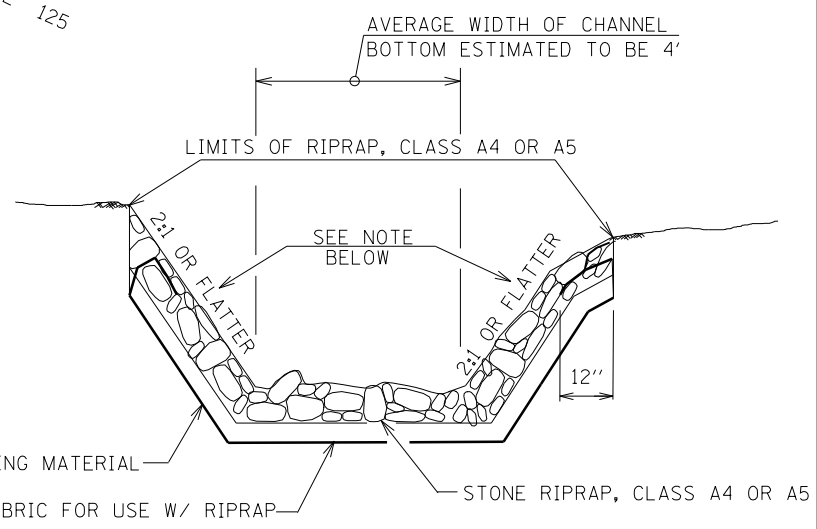
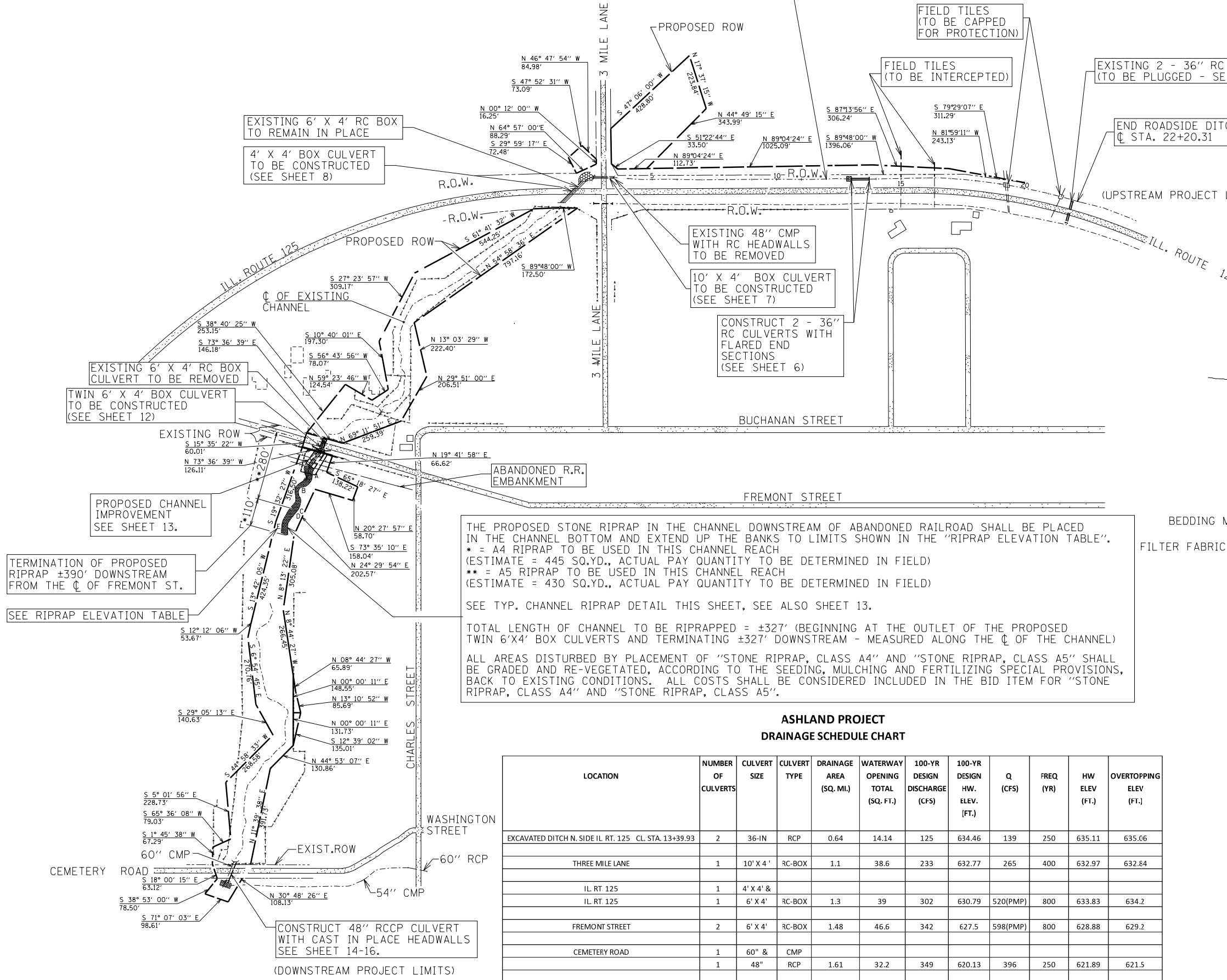
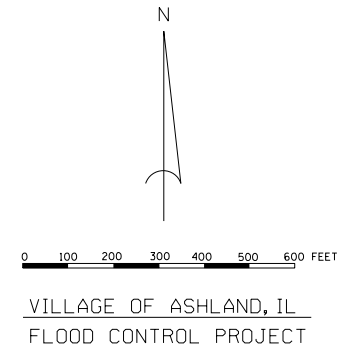

TYPICAL CHANNEL RIPRAP DETAIL

NOTE: ALL CHANNEL BANKS WITH A SLOPE STEEPER THAN 2:1 (H:V) SHALL BE EXCAVATED AND REGRADED TO 2:1 (H:V). THE COST OF EXCAVATING AND REGRADING CHANNEL BANKS SHALL BE CONSIDERED INCLUDED IN "STONE RIPRAP, CLASS A4" AND "STONE RIPRAP, CLASS A5"

THE PROPOSED STONE RIPRAP IN THE CHANNEL DOWNSTREAM OF ABANDONED RAILROAD SHALL BE PLACED IN THE CHANNEL BOTTOM AND EXTEND UP THE BANKS TO LIMITS SHOWN IN THE "RIPRAP ELEVATION TABLE".
 * = A4 RIPRAP TO BE USED IN THIS CHANNEL REACH (ESTIMATE = 445 SQ.YD., ACTUAL PAY QUANTITY TO BE DETERMINED IN FIELD)
 ** = A5 RIPRAP TO BE USED IN THIS CHANNEL REACH (ESTIMATE = 430 SQ.YD., ACTUAL PAY QUANTITY TO BE DETERMINED IN FIELD)

SEE TYP. CHANNEL RIPRAP DETAIL THIS SHEET, SEE ALSO SHEET 13.
 TOTAL LENGTH OF CHANNEL TO BE RIPRAPPED = ±327' (BEGINNING AT THE OUTLET OF THE PROPOSED TWIN 6'X4' BOX CULVERTS AND TERMINATING ±327' DOWNSTREAM - MEASURED ALONG THE CL OF THE CHANNEL)

ALL AREAS DISTURBED BY PLACEMENT OF "STONE RIPRAP, CLASS A4" AND "STONE RIPRAP, CLASS A5" SHALL BE GRADED AND RE-VEGETATED, ACCORDING TO THE SEEDING, MULCHING AND FERTILIZING SPECIAL PROVISIONS, BACK TO EXISTING CONDITIONS. ALL COSTS SHALL BE CONSIDERED INCLUDED IN THE BID ITEM FOR "STONE RIPRAP, CLASS A4" AND "STONE RIPRAP, CLASS A5".

ASHLAND PROJECT
DRAINAGE SCHEDULE CHART

LOCATION	NUMBER OF CULVERTS	CULVERT SIZE	CULVERT TYPE	DRAINAGE AREA (SQ. MI.)	WATERWAY OPENING TOTAL (SQ. FT.)	100-YR DESIGN DISCHARGE (CFS)	100-YR DESIGN HW. ELEV. (FT.)	Q (CFS)	FREQ (YR)	HW ELEV (FT.)	OVERTOPPING ELEV (FT.)
EXCAVATED DITCH N. SIDE IL RT. 125 CL STA. 13+39.93	2	36-IN	RCP	0.64	14.14	125	634.46	139	250	635.11	635.06
THREE MILE LANE	1	10' X 4'	RC-BOX	1.1	38.6	233	632.77	265	400	632.97	632.84
IL RT 125	1	4' X 4' &									
IL RT 125	1	6' X 4'	RC-BOX	1.3	39	302	630.79	520(PMP)	800	633.83	634.2
FREMONT STREET	2	6' X 4'	RC-BOX	1.48	46.6	342	627.5	598(PMP)	800	628.88	629.2
CEMETERY ROAD	1	60" &	CMP								
	1	48"	RCP	1.61	32.2	349	620.13	396	250	621.89	621.5

RIPRAP ELEVATION TABLE

SECTION *** (TRAVERSE STA.)	TOP OF RIPRAP OFFSET FROM TRAV. LINE & ELEVATION (LOOKING DOWNSTREAM)	
	LT. BANK	RT. BANK
A - STA. 57+99.5	55.03', 623.33	22.88', 624.42
B - STA. 58+56	23.61', 622.23	6.94', 625.12
C - STA. 59+25	46.49', 623.81	18.61', 623.81
D - STA. 59+59	37.47', 623.25	8.77', 623.25
E - STA. 60+35	31.44', 621.95	6.17', 621.95

*** = SEE SHEET 13 FOR TRAVERSE LINE INFORMATION

BILL OF MATERIAL

STONE RIPRAP, CLASS A4	SQ.YD.	445
STONE RIPRAP, CLASS A5	SQ.YD.	430
FILTER FABRIC	SQ.YD.	875

O:\Owr\Proj\mpl\Projects\ASHLAND\Plan Sheets\sheet 4.dgn
 5:04:23 PM
 12/13/2012
 TMM
 Checked By RLP
 GMS
 Drawn By SIN