

**SECTION A-A**

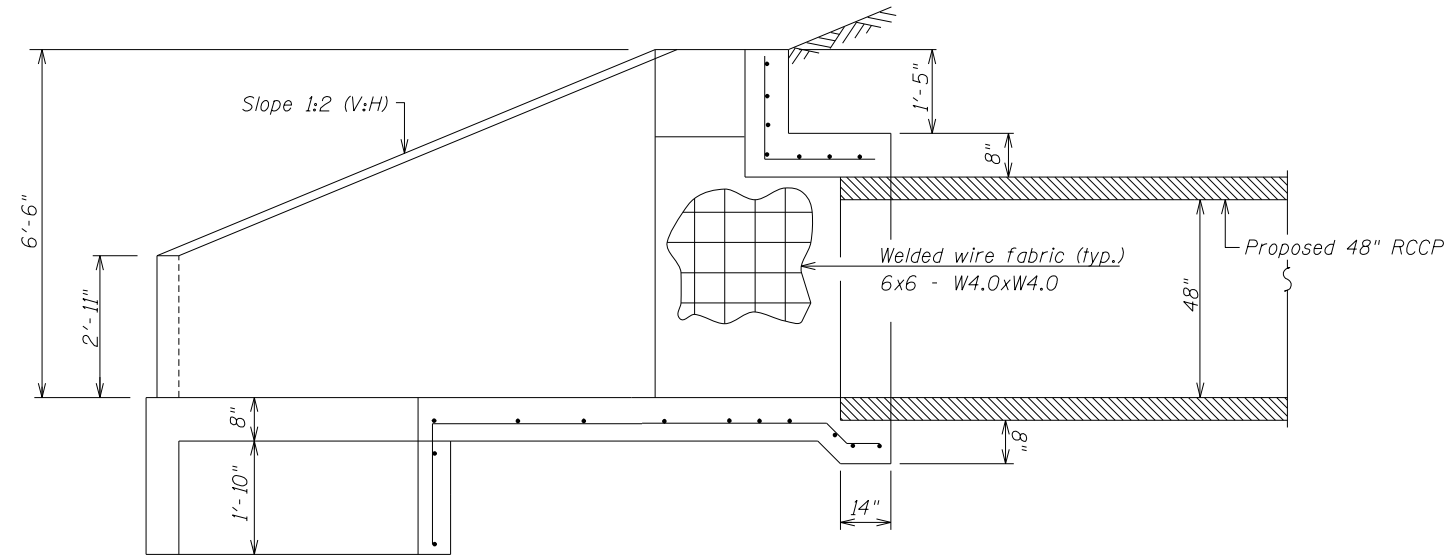

**SECTION B-B**

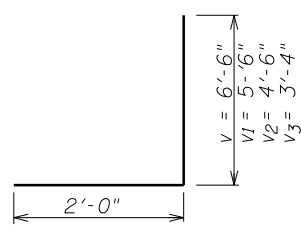

**BARS v to v3**

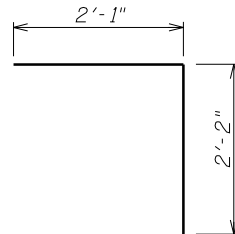

**BAR d**

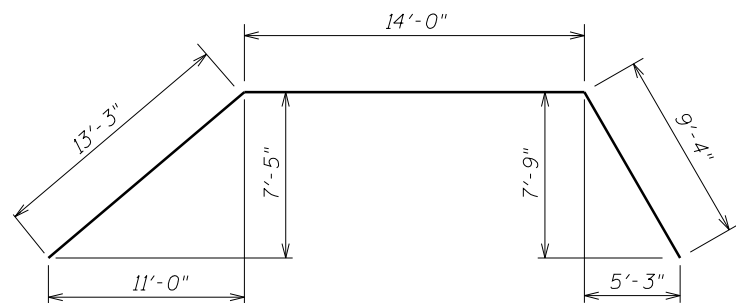

**BAR h**

**GENERAL NOTES**

All slope ratios are expressed as units of vertical displacement to units of horizontal displacement (V:H).

All dimensions are in inches unless otherwise shown.

All exposed edges of concrete shall be beveled <sup>3</sup>/<sub>4</sub>".

Class SI Concrete shall be used throughout.

Reinforcement Bars shall conform to the requirements of A.A.S.H.T.O. M-31, or M-322, Grade 60.

**\*BILL OF MATERIAL**

Bar	No.	Size	Length	Shape
a	16	#5	1'-6"	
b3	4	#5	15'-3"	
b7	2	#4	17'-2"	
b9	2	#5	20'-5"	
b12	2	#4	23'-8"	
b13	2	#4	26'-11"	
b14	4	#4	29'-6"	
d	38	#4	4'-3"	
h	4	#5	36'-7"	
h14	4	#4	8'-3"	
h15	4	#4	12'-6"	
v	12	#4	8'-6"	
v1	10	#4	7'-6"	
v2	12	#4	6'-6"	
v3	14	#4	5'-4"	
w	4	#4	4'-0"	

REINFORCEMENT BARS, EPOXY COATED	POUND	**907
CONCRETE BOX CULVERTS	CU YD	23.9

\* Bill of Material accounts for both End Sections.

\*\* 57 lbs. of Welded Wire Fabric is included in this quantity.

O:\OwrProj\proj\Projects\ASHLAND\Plan Sheets\sheet 16.dgn

12/3/2012 5:32:59 PM

Designed By TMM  
Checked By RLP

Drawn By SIN