

SIGN LEGEND

<p>① RAMP CLOSED AHEAD TS-9-4860</p>	<p>② THIS RAMP WILL BE CLOSED TS-4-4860 (SEE NOTE 2)</p>	<p>③ R3-2-36 (SEE NOTE 1)</p>	<p>④ DETOUR TOLL WEST M4-8(O)-2412 M4-15-2412 M3-4-2412 88 M1-1-24 M5-1R(O)-2115</p>	<p>⑤ DETOUR TOLL WEST M4-8(O)-2412 M4-15-2412 M3-4-2412 88 M1-1-24 M6-1-2115</p>
<p>⑥ DETOUR TOLL WEST M4-8(O)-2412 M4-15-2412 M3-4-2412 88 M1-1-24 M5-1L(O)-2115</p>	<p>⑦ DETOUR TOLL WEST M4-8(O)-2412 M4-15-2412 M3-4-2412 88 M1-1-24 M6-1-2115</p>	<p>⑧ NOT USED</p>	<p>⑨ DETOUR TOLL WEST M4-8(O)-2412 M4-15-2412 M3-4-2412 88 M1-1-24 M6-1-2115</p>	
<p>⑩ PORTABLE CHANGEABLE MESSAGE SIGN</p> <p>188 WEST RAMP CLOSED PHASE I 3-SEC DISPLAY (18" LETTERS)</p> <p>FOLLOW MARKED DETOUR PHASE II 3-SEC DISPLAY (18" LETTERS)</p>		<p>⑪ DETOUR AHEAD W20-2(O)-48</p>	<p>⑫ END DETOUR TOLL WEST M4-8A(O)-2418 M4-15-2412 M3-4-2412 88 M1-1-24</p>	

NOTES

- SEE MAINTENANCE OF TRAFFIC PLANS FOR SIGN LOCATION DETAIL.
- PLACE TS-4 SIGN ADJACENT TO WESTBOUND RAMP ENTRANCE SIGNAGE FOR NORTHBOUND DIRECTION ONLY. DATES FOR BOTTOM TWO LINES ON TS-4 SIGN SHALL BE DETERMINED BY THE ENGINEER AND PLACED AT LEAST ONE (1) WEEK PRIOR TO RAMP CLOSURES OR AS OTHERWISE DIRECTED BY THE ENGINEER.

MATCH LINE SEE SHEET 6 OF 8

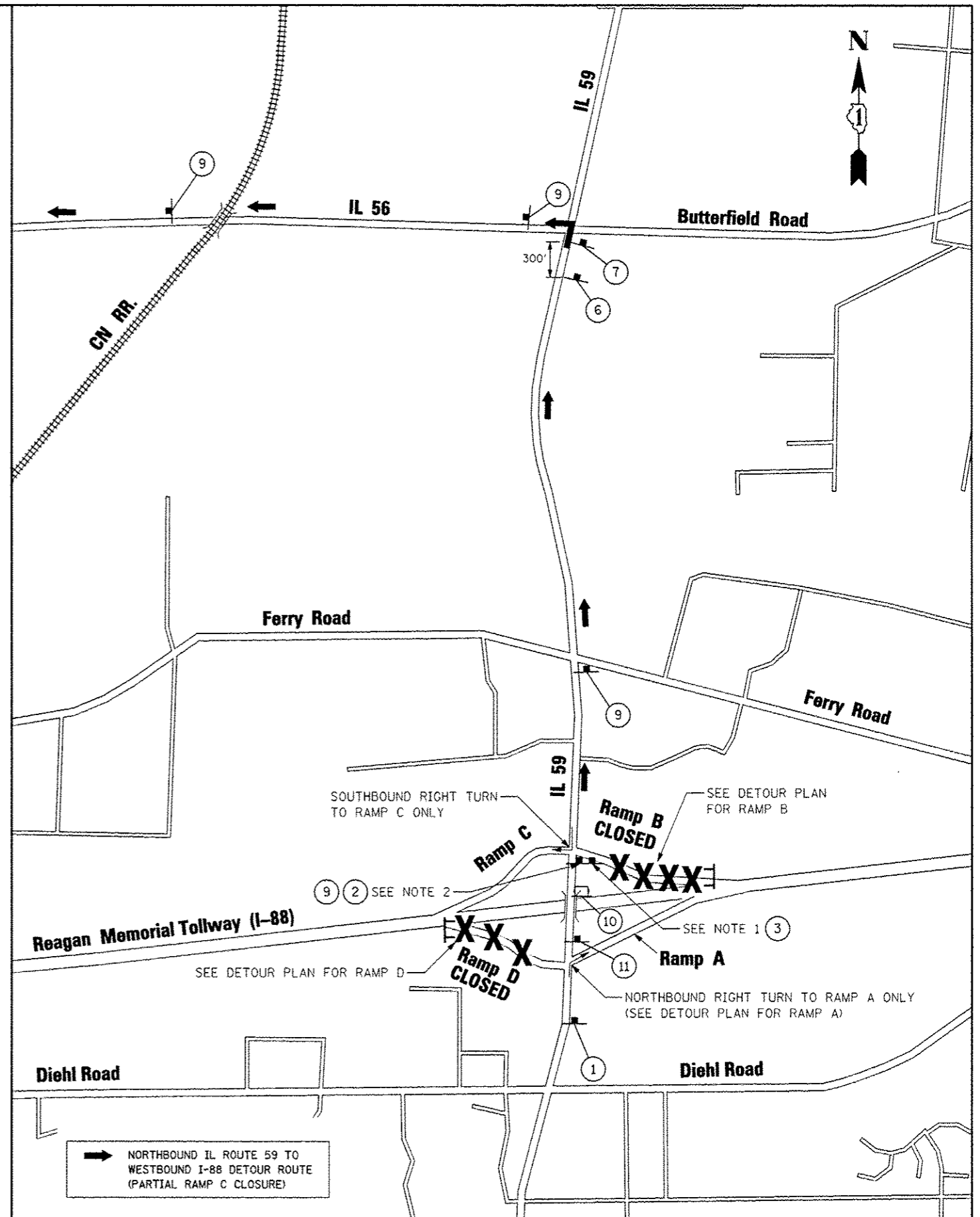

FILE NAME *	USER NAME = #USER*	DESIGNED <i>PJO</i>	REVISED -ADDENDUM A 12/17/2012
#FILE#		DRAWN <i>KES</i>	REVISED -
		CHECKED <i>JCM</i>	REVISED -
		DATE <i>10/15/2012</i>	REVISED -

**STATE OF ILLINOIS
DEPARTMENT OF TRANSPORTATION**

**DETOUR PLAN FOR RAMP C (1 OF 2)
NORTHBOUND IL ROUTE 59 TO WESTBOUND I-88**

SCALE: N.T.S. SHEET NO. 5 OF 8 SHEETS STA. TO STA.

F.A.P. RTE.	SECTION	COUNTY	TOTAL SHEETS	SHEET NO.
338	(112 & 113) WRS-5	DUPAGE	963	91
CONTRACT NO. 60131			ILLINOIS FED. AID PROJECT	