

DATE	
BY	
DESIGNED	
DRAWN	
CHECKED	
DATE	

DATE	
BY	
DESIGNED	
DRAWN	
CHECKED	
DATE	

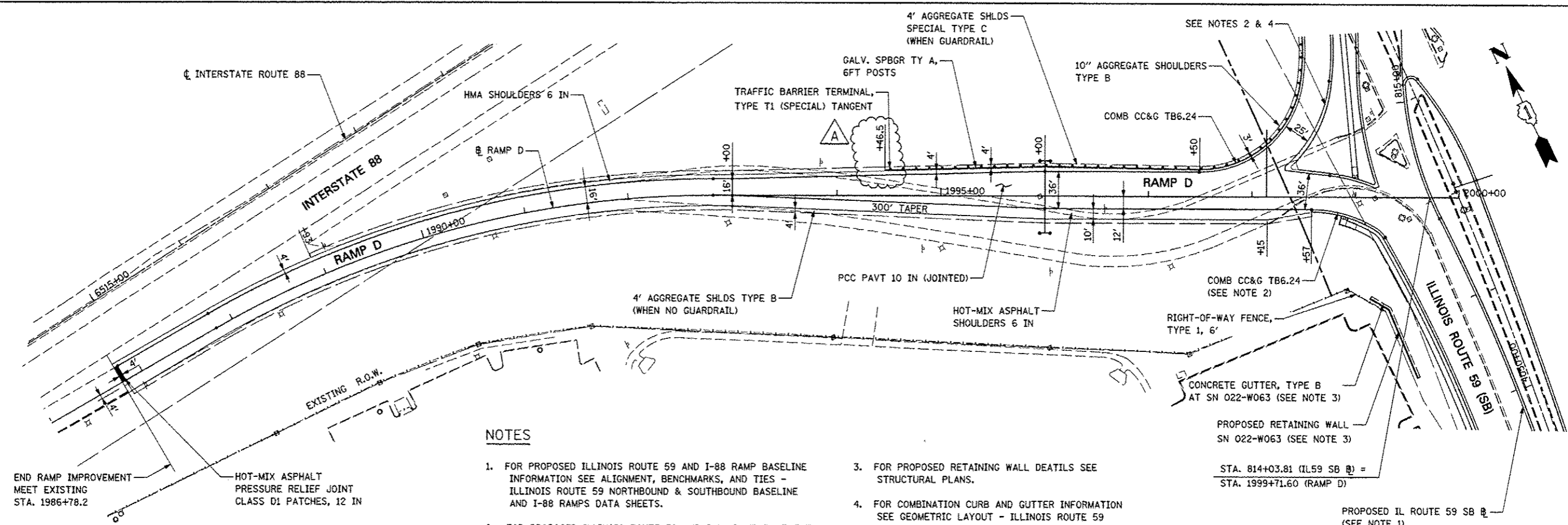

**NOTES**

- FOR PROPOSED ILLINOIS ROUTE 59 AND I-88 RAMP BASELINE INFORMATION SEE ALIGNMENT, BENCHMARKS, AND TIES - ILLINOIS ROUTE 59 NORTHBOUND & SOUTHBOUND BASELINE AND I-88 RAMPS DATA SHEETS.
- FOR PROPOSED ILLINOIS ROUTE 59 AND I-88 RAMP PAVEMENT GEOMETRY INFORMATION SEE GEOMETRIC LAYOUT - ILLINOIS ROUTE 59 AND GEOMETRIC LAYOUT - I-88 RAMPS SHEETS.
- FOR PROPOSED RETAINING WALL DETAILS SEE STRUCTURAL PLANS.
- FOR COMBINATION CURB AND GUTTER INFORMATION SEE GEOMETRIC LAYOUT - ILLINOIS ROUTE 59 CHANNELIZATION ISLAND DETAILS SHEET.
- FOR EDGE OF PAVEMENT ELEVATIONS SEE PAVEMENT JOINTING AND ELEVATION PLANS.

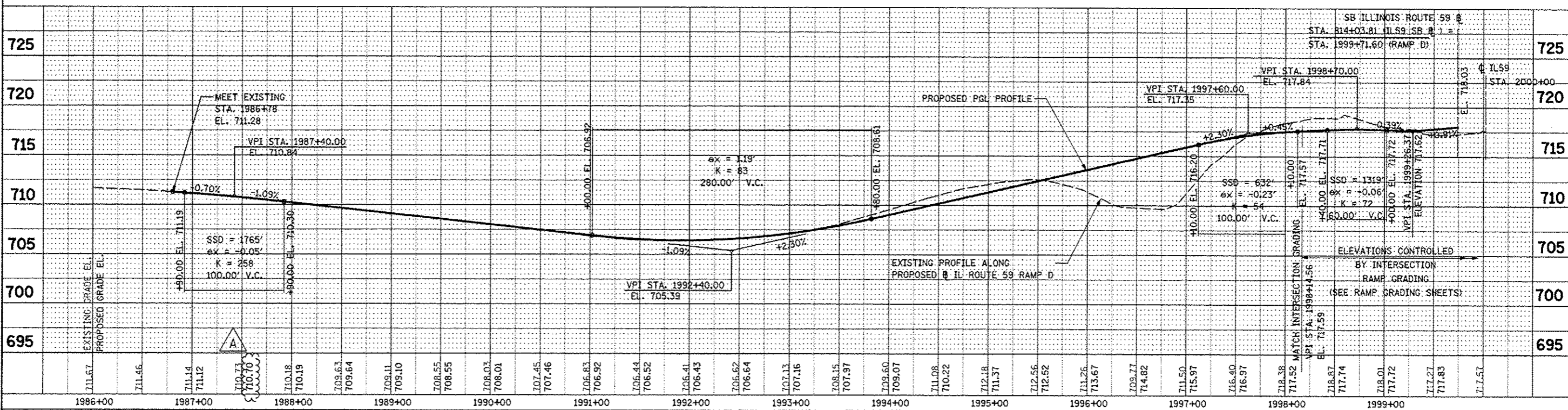
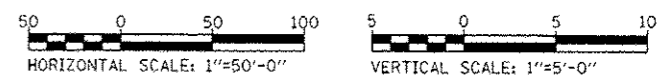

FILE NAME	USER NAME	DESIGNED	REVISED	F.A.P. RTE.	SECTION	COUNTY	TOTAL SHEETS	SHEET NO.	
#FILE#	#USER#	PJO	-ADDENDUM A 12/17/2012	338	(112 & 113) WRS-5	DUPAGE	963	261	
		DRAWN		SCALE: AS SHOWN				SHEET NO. 17 OF 18 SHEETS	STA. 1991+40 TO STA. 2000+00
		CHECKED		FED. ROAD DIST. NO.				ILLINOIS FED. AID PROJECT	CONTRACT NO. 60131
		DATE	10/15/2012						

**STATE OF ILLINOIS  
DEPARTMENT OF TRANSPORTATION**

**PLAN AND PROFILE - RAMP D**