

**NOTES**  
 1. HIGH MAST LIGHT TOWER, CCTV CAMERA AND CONDUIT FROM HANDHOLE TO LIGHT TOWER ARE SHOWN FOR INFORMATIONAL PURPOSES ONLY. SEE LIGHTING PLANS FOR DETAILS.

RESTORATION OF WORK AREA. RESTORATION OF THE TRAFFIC SIGNAL WORK AREA SHALL BE INCIDENTAL TO THE RELATED PAY ITEM SUCH AS FOUNDATION, CONDUIT, HANDHOLE, TRENCH AND BACKFILL, ETC., AND NO EXTRA COMPENSATION SHALL BE ALLOWED. ALL ROADWAY SURFACES SUCH AS SHOULDERS, MEDIANS, SIDEWALKS, PAVEMENT, ETC. SHALL BE REPLACED IN KIND. ALL DAMAGE TO MOWED LAWNS SHALL BE REPLACED WITH AN APPROVED SOD, AND ALL DAMAGE TO UNMOWED FIELDS SHALL BE SEEDED IN ACCORDANCE WITH STANDARD SPECIFICATIONS 252 AND 250 RESPECTIVELY.

THE TRAFFIC SIGNAL CONTROLLER EQUIPMENT SHALL BE "ECONOLITE" TO MATCH THE EXISTING ADJACENT SYSTEM.

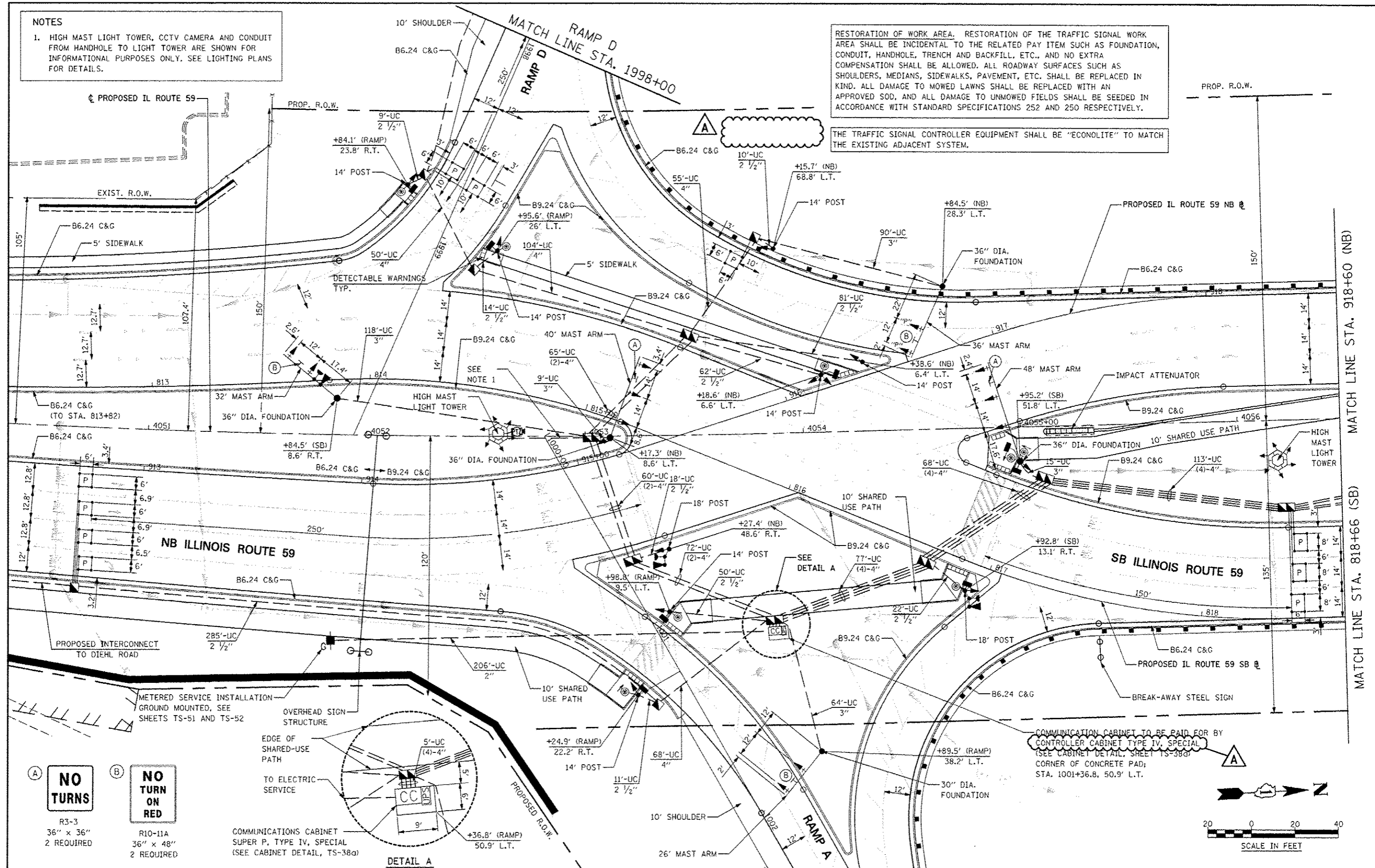

**(A) NO TURNS**  
 R3-3  
 36" x 36"  
 2 REQUIRED

**(B) NO TURN ON RED**  
 R10-11A  
 36" x 48"  
 2 REQUIRED

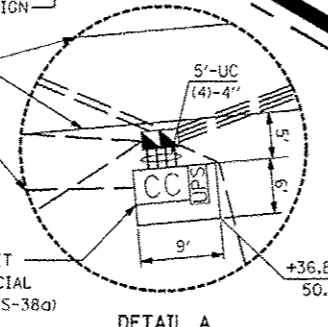

|                   |                   |                  |                                |   |  |  |  |                 |                           |               |                    |               |
|-------------------|-------------------|------------------|--------------------------------|---|--|--|--|-----------------|---------------------------|---------------|--------------------|---------------|
| FILE NAME: #FILE# | USER NAME: #USER# | DESIGNED: MJM    | REVISED: ADDENDUM A 12/17/2012 | STATE OF ILLINOIS<br>DEPARTMENT OF TRANSPORTATION |  | PROPOSED TRAFFIC SIGNAL PLAN<br>IL ROUTE 59 AND I-88 SOUTH RAMPS |  | F.A.P. RTE. 338 | SECTION (112 & 113) WRS-5 | COUNTY DUPAGE | TOTAL SHEETS 963   | SHEET NO. 448 |
|                   |                   | DRAWN: KES       | REVISED:                       |   |  | SCALE: AS SHOWN  |  |                 |                           |               | CONTRACT NO. 60131 |               |
|                   |                   | CHECKED: JCM     | REVISED:                       |   |  | SHEET NO. 33 OF 53 SHEETS  |  | STA.            | TO STA.                   |               |                    |               |
|                   |                   | DATE: 10/15/2012 | REVISED:                       |   |  |  |  |                 |                           |               |                    |               |