

NOTE:
 1. THE EXISTING POSTED SPEED LIMIT IS 40 MPH.
 2. "WORKERS" SIGN SHALL BE THE SYMBOLIC VERSION AND SHALL BE REMOVED WHEN NO WORKERS ARE PRESENT.

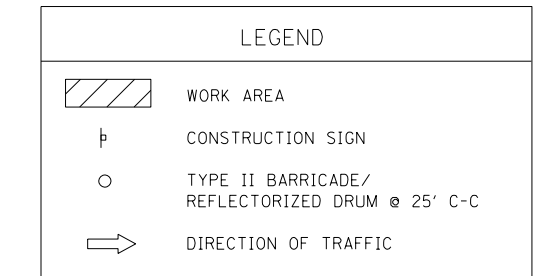

I:\6710\671018 - McCarthy at Walker Intersection_imp\CADD\CADD SHEETS\60L79-ht-staging-1-McCarthy.dgn

FILE NAME =	USER NAME = r9011	DESIGNED - RG	REVISED -
		DRAWN - RG	REVISED -
	PLOT SCALE = 100.0000' / in.	CHECKED - MGR	REVISED -
	PLOT DATE = 10/19/2012	DATE - MARCH, 2012	REVISED -

**STATE OF ILLINOIS
DEPARTMENT OF TRANSPORTATION**

**STAGING PLANS
McCARTHY ROAD
STAGE I**

SCALE:	SHEET NO.	OF SHEETS	STA.	TO STA.
--------	-----------	-----------	------	---------

F.A.U. RTE.	SECTION	COUNTY	TOTAL SHEETS	SHEET NO.
1587	3098-R	COOK	95	33
CONTRACT NO. 60L79				
ILLINOIS FED. AID PROJECT				