

**PAVEMENT MARKING LEGEND**

- ① THPL PAVT MK, 4" DOUBLE YELLOW LINE, 11" C-C (TYP.)
- ② THPL PAVT MK, 4" WHITE EDGE LINE (TYP.)
- ③ THPL PAVT MK, 4" YELLOW LINE (TYP.)
- ④ THPL PAVT MK, 4" YELLOW LINE (30' SKIP 10' DASH) (TYP.)
- ⑤ THPL PAVT MK, 6" WHITE LINE (TYP.)
- ⑥ THPL PAVT MK, LETTERS & SYMBOLS (TYP.)
- ⑦ THPL PAVT MK, 24" WHITE STOP BAR (TYP.)
- ⑧ THPL PAVT MK, 6" WHITE DOTTED LINE (6' SKIP 2' DASH) (TYP.)
- ⑨ THPL PAVT MK, 12" WHITE CROSSWALK LINE (TYP.)
- ⑩ THPL PAVT MK, 12" YELLOW DIAGONALS (TYP.), (SEE TC-13 FOR SPACING)
- ⑪ THPL PAVT MK, 8" WHITE LINE (TYP.)
- ⑫

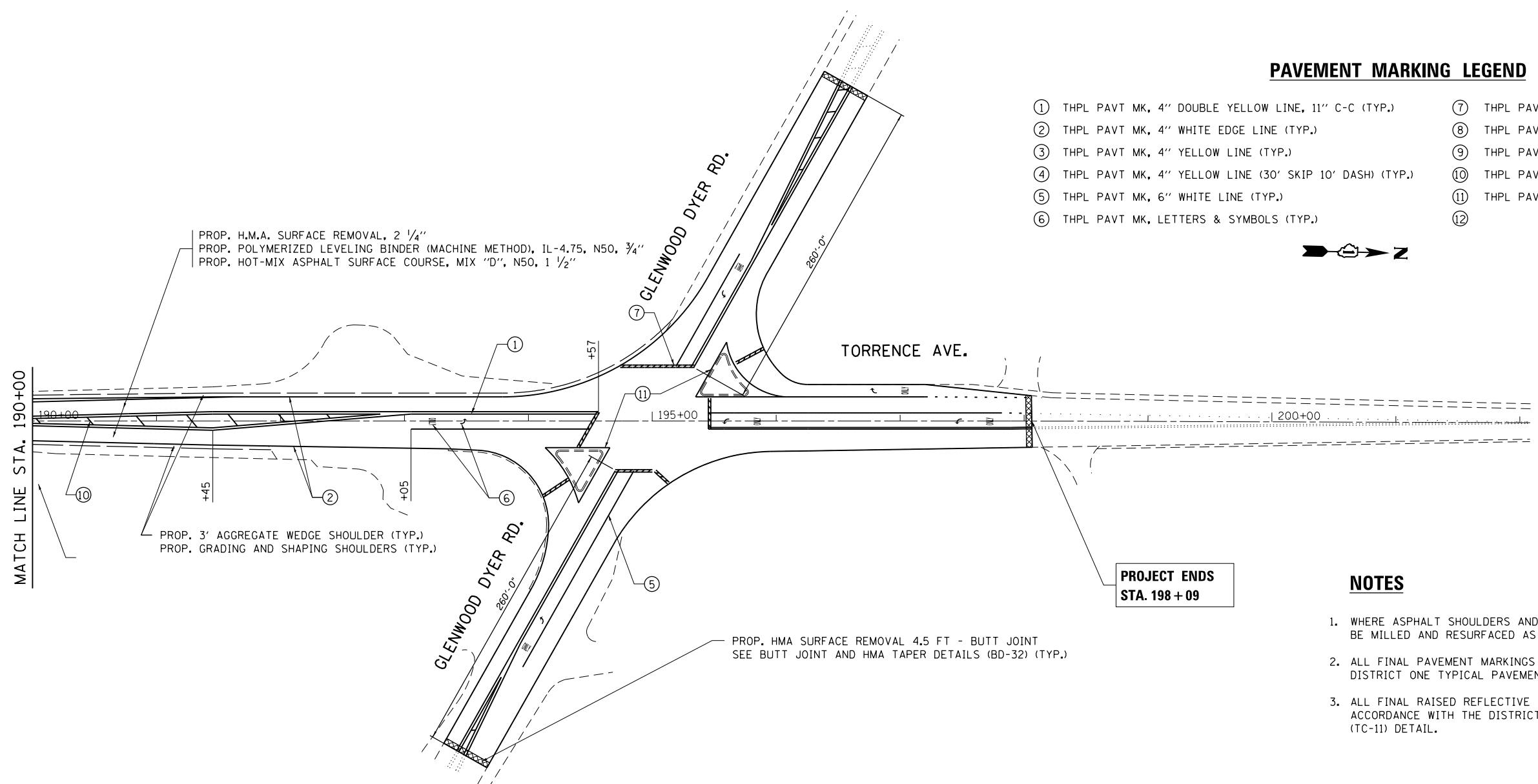

PROP. H.M.A. SURFACE REMOVAL, 2 1/4"  
 PROP. POLYMERIZED LEVELING BINDER (MACHINE METHOD), IL-4.75, N50, 3/4"  
 PROP. HOT-MIX ASPHALT SURFACE COURSE, MIX "D", N50, 1 1/2"

PROP. 3' AGGREGATE WEDGE SHOULDER (TYP.)  
 PROP. GRADING AND SHAPING SHOULDERS (TYP.)

PROP. HMA SURFACE REMOVAL 4.5 FT - BUTT JOINT  
 SEE BUTT JOINT AND HMA TAPER DETAILS (BD-32) (TYP.)

**NOTES**

1. WHERE ASPHALT SHOULDERS AND / OR MAILBOX TURNOUTS EXIST, THEY SHALL BE MILLED AND RESURFACED AS DETERMINED BY THE ENGINEER.
2. ALL FINAL PAVEMENT MARKINGS SHALL BE PLACED IN ACCORDANCE WITH DISTRICT ONE TYPICAL PAVEMENT MARKINGS (TC-13) DETAIL.
3. ALL FINAL RAISED REFLECTIVE PAVEMENT MARKERS SHALL BE PLACED IN ACCORDANCE WITH THE DISTRICT ONE RAISED REFLECTIVE PAVEMENT MARKERS (TC-11) DETAIL.

FILE NAME =	USER NAME = pughst	DESIGNED -	REVISED -	<b>STATE OF ILLINOIS DEPARTMENT OF TRANSPORTATION</b>	<b>TORRENCE AVE. (IL RTE. 83 (GLENWOOD DYER RD.) TO STEGER RD.) ROADWAY AND PAVEMENT MARKING PLAN</b>	F.A.U. RTE. =	SECTION	COUNTY	TOTAL SHEETS	SHEET NO.	
ci:\pwork\pwork\pughst\02246874\01111111\sh1-plan.dgn	PLOT SCALE = 100.0000' / 1in.	CHECKED -	REVISED -			2937	2010-112-R5	COOK	32	16	
PLOT DATE = 10/22/2012	DATE -	REVISED -	REVISED -			CONTRACT NO. 60M44					
						SCALE: 1"=50'	SHEET NO. 7 OF 7 SHEETS	STA. 175+00 TO STA. 195+30	ILLINOIS FED. AID PROJECT		