

FINAL	DATE
REVISION	BY
NO. 1	
NO. 2	
NO. 3	
NO. 4	
NO. 5	
NO. 6	
NO. 7	
NO. 8	
NO. 9	
NO. 10	

ORIGINAL	DATE
SURVEY	BY
NO. 1	
NO. 2	
NO. 3	
NO. 4	
NO. 5	
NO. 6	
NO. 7	
NO. 8	
NO. 9	
NO. 10	

PLOT DRIVER = whp_dcf_1147.plotter.g
 FILE NAME = S:\p\p\m\1147\1147.dwg
 DISTRICT ITCAD\1147.dwg
 SHEETS\1147\1147.dwg
 SHEET NO. 2 OF 7 SHEETS
 STA. 1455+00.00 TO STA. 1457+00.00

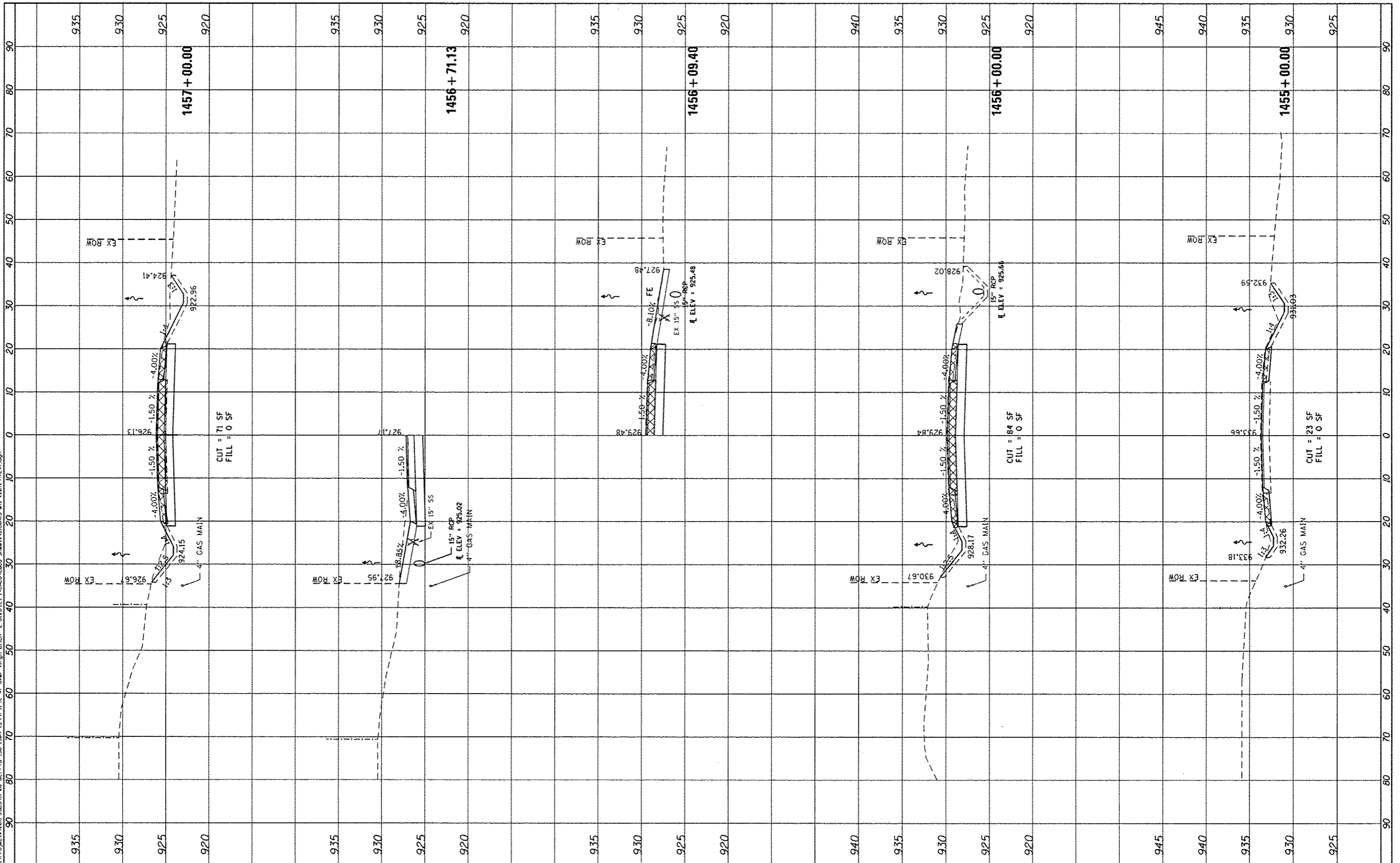

USER NAME	amona
DESIGNED	MCV
DRAWN	CMM
CHECKED	MTM
DATE	10/12
REVISION	
REVISION	
REVISION	
REVISION	

DESIGNED	MCV
DRAWN	CMM
CHECKED	MTM
DATE	10/12
REVISION	
REVISION	
REVISION	
REVISION	

STATE OF ILLINOIS
 DEPARTMENT OF TRANSPORTATION

IL ROUTE 47 OVER VIRGIL DITCH #2
 CROSS SECTIONS

SCALE: 10H : 5V SHEET NO. 2 OF 7 SHEETS STA. 1455+00.00 TO STA. 1457+00.00

F.A.P. RTE.	SECTION	COUNTY	TOTAL SHEETS	SHEET NO.
326	106X-B	KANE	87	81
				CONTRACT NO. 60N13
ILLINOIS FED. AID PROJECT				