

DATE	
BY	
DESIGNED	
DRAWN	
CHECKED	
DATE	

DATE	
BY	
DESIGNED	
DRAWN	
CHECKED	
DATE	

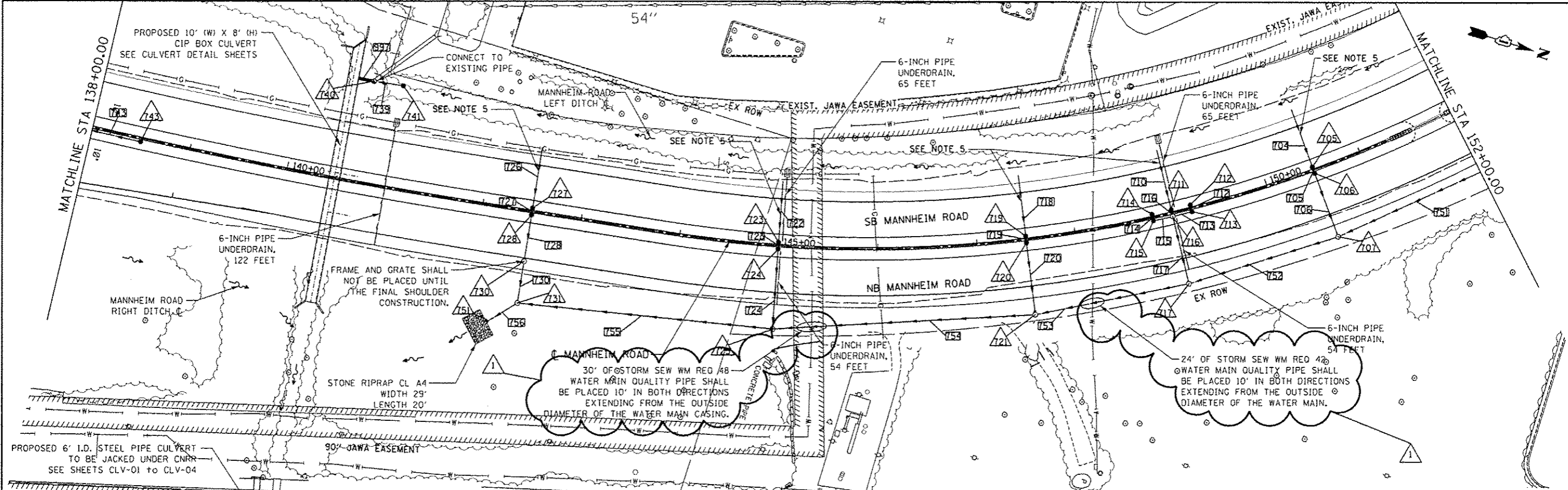

**NOTES:**

1. ALL DIMENSIONS ARE IN FEET UNLESS OTHERWISE NOTED.
2. ALL STATIONING AND OFFSET MEASUREMENTS ARE OFF C MANNHEIM RD.
3. ALL PIPE DIAMETERS ARE IN INCHES (IN) UNLESS OTHERWISE NOTED.
4. REFER TO ROADWAY PROFILE PLANS FOR ALL ROADWAY PROFILE SLOPE AND CURVE GEOMETRY.
5. STORM SEWERS THAT WILL HAVE A FUTURE CONNECTION TO A DRAINAGE STRUCTURE CONSTRUCTED AS PART OF FUTURE IMPROVEMENTS ARE TO HAVE A TEMPORARY BULKHEAD PLACED AT THE END OF THE PIPE. THE COST AND WORK TO CONSTRUCT THE BULKHEAD IS INCLUDED IN THE PRICE FOR THE PIPE.
6. ALL PIPE UNDERDRAINS SHOULD BE PLACED 30-INCHES DEEP.

**DRAINAGE LEGEND**

- PROPOSED STORM SEWER
- PROPOSED SUMMIT
- PROPOSED DITCH
- PROPOSED SWALE
- PROPOSED CATCH BASIN
- PROPOSED MANHOLE
- ▲ PRECAST REINFORCED CONC. FLARED END SECTION
- PROPOSED INLET

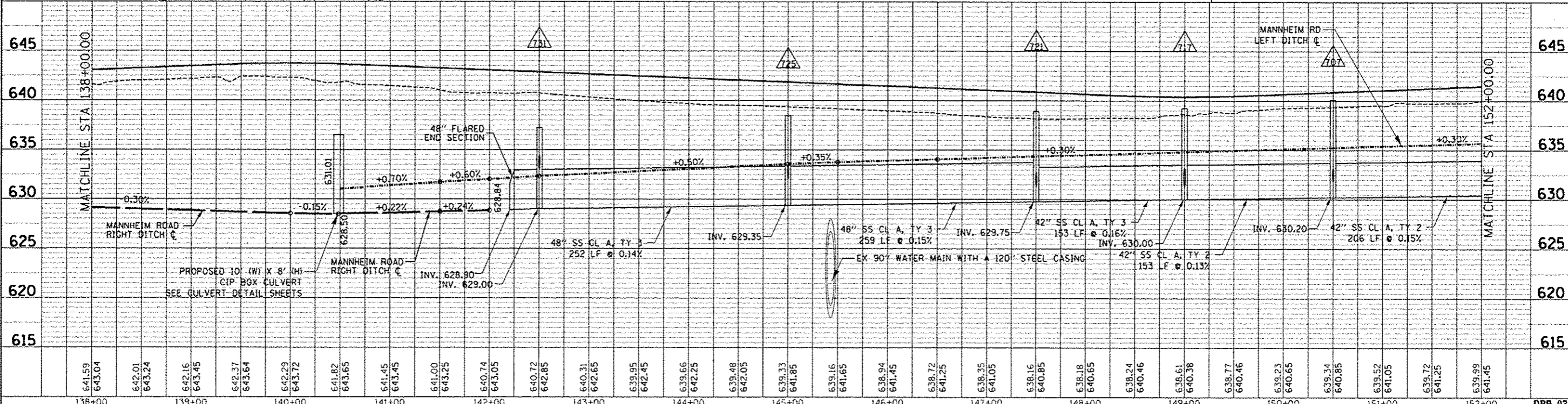

FILE NAME :	USER NAME :	DESIGNED :	REVISED :	STATE OF ILLINOIS DEPARTMENT OF TRANSPORTATION		PROPOSED DRAINAGE MANNHEIM ROAD PLAN AND PROFILE		F.A. RTE.	SECTION	COUNTY	TOTAL SHEETS	SHEET NO.
#FILE# :		DRAWN :	REVISED :	12/27/2012 HDU		SCALE: HORIZ. 1"=50' VERT. 1"=5'		0105-WRS	COOK	517	180	
		CHECKED :	REVISED :			STA. 138+00.00 TO STA. 152+00.00		CONTRACT NO. 60P35		ILLINOIS FED. AID PROJECT		
		DATE :	REVISED :	10/19/12								

TENG TENG & ASSOCIATES, INC. ENGINEERS/ARCHITECTS/PLANNERS CHICAGO, ILLINOIS

DPP-03