

MAINTENANCE OF TRAFFIC LEGEND

| | | | | | | | | | |
|--|---|--|---|--|-------------------------------|--|---------------------------|--|---|
| | WORK AREA | | TRAFFIC DIRECTION | | ARROW BOARD | | 1 PVT MK - LINE 4" WHITE | | 7 PVT MK - LINE 24" WHITE |
| | TEMPORARY PAVEMENT (TO BE CONSTRUCTED IN CURRENT STAGE) | | BARRICADE, TYPE III, W/ TYPE A BI-DIRECTIONAL FLASHING LIGHT | | DOUBLE VERTICAL PANEL | | 2 PVT MK - LINE 4" YELLOW | | 8 PVT MK - LINE 8" WHITE |
| | | | TYPE II BARRICADES OR DRUMS W/ TYPE C STEADY BURN LIGHT | | PROPOSED SIGN | | 3 PVT MK - DBL 4" YELLOW | | T TEMP PVT MK (SEE GENERAL NOTES SHT G-03) |
| | | | TYPE B MONO-DIRECTIONAL FLASHING LIGHT | | TEMPORARY CONCRETE BARRIER | | 4 PVT MK - LINE 6" WHITE | | W WET REF TEM TAPE T3 (SEE GENERAL NOTES SHT G-03) |
| | | | | | RAMP CLOSED | | 5 PVT MK - LINE 12" | | P PERM PVT MK (SEE PVT MK PLANS) |

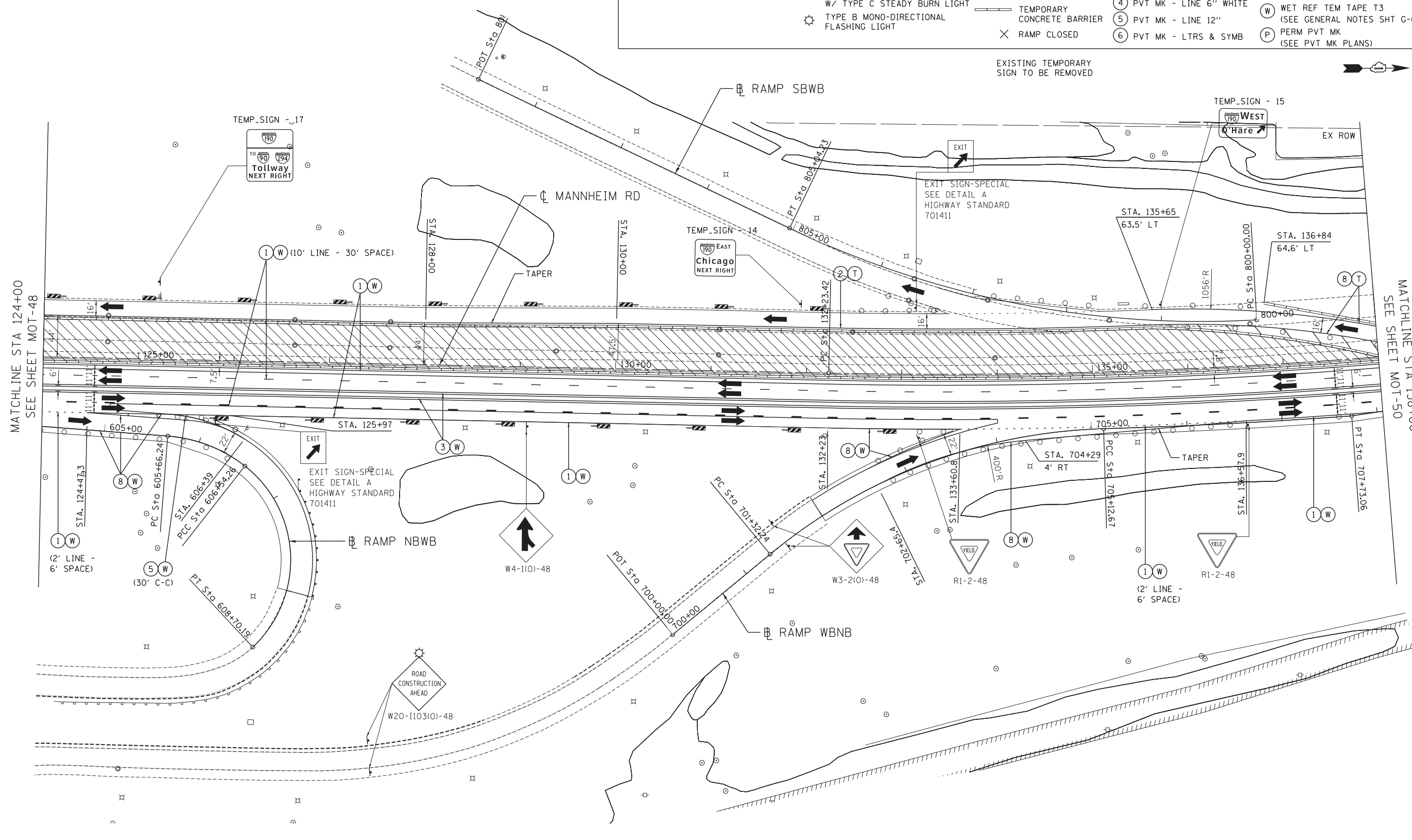

MATCHLINE STA 124+00
SEE SHEET MOT-48

MATCHLINE STA 138+00
SEE SHEET MOT-50

\D:\60P35-ALIGNMENT.DGN, \D:\60P35-LAYOUT.DGN, \D:\60P35-TOPO2.DGN, \D:\60P35-ROW.DGN, \D:\60P35-STAGING2.DGN, \D:\60P35-BORDEXT.DGN, \D:\60P35-STAGING.DGN, \D:\60P35-MOT_GUIDE.DGN, \D:\60P35-STAGING.DGN, \D:\60P35-MOT-1.DGN, \D:\60P35-MOT-2.DGN, \D:\60P35-MOT-3.DGN, \D:\60P35-MOT-4.DGN, \D:\60P35-MOT-5.DGN, \D:\60P35-MOT-6.DGN, \D:\60P35-MOT-7.DGN, \D:\60P35-MOT-8.DGN, \D:\60P35-MOT-9.DGN, \D:\60P35-MOT-10.DGN, \D:\60P35-MOT-11.DGN, \D:\60P35-MOT-12.DGN, \D:\60P35-MOT-13.DGN, \D:\60P35-MOT-14.DGN, \D:\60P35-MOT-15.DGN, \D:\60P35-MOT-16.DGN, \D:\60P35-MOT-17.DGN, \D:\60P35-MOT-18.DGN, \D:\60P35-MOT-19.DGN, \D:\60P35-MOT-20.DGN, \D:\60P35-MOT-21.DGN, \D:\60P35-MOT-22.DGN, \D:\60P35-MOT-23.DGN, \D:\60P35-MOT-24.DGN, \D:\60P35-MOT-25.DGN, \D:\60P35-MOT-26.DGN, \D:\60P35-MOT-27.DGN, \D:\60P35-MOT-28.DGN, \D:\60P35-MOT-29.DGN, \D:\60P35-MOT-30.DGN, \D:\60P35-MOT-31.DGN, \D:\60P35-MOT-32.DGN, \D:\60P35-MOT-33.DGN, \D:\60P35-MOT-34.DGN, \D:\60P35-MOT-35.DGN, \D:\60P35-MOT-36.DGN, \D:\60P35-MOT-37.DGN, \D:\60P35-MOT-38.DGN, \D:\60P35-MOT-39.DGN, \D:\60P35-MOT-40.DGN, \D:\60P35-MOT-41.DGN, \D:\60P35-MOT-42.DGN, \D:\60P35-MOT-43.DGN, \D:\60P35-MOT-44.DGN, \D:\60P35-MOT-45.DGN, \D:\60P35-MOT-46.DGN, \D:\60P35-MOT-47.DGN, \D:\60P35-MOT-48.DGN, \D:\60P35-MOT-49.DGN, \D:\60P35-MOT-50.DGN, \D:\60P35-MOT-51.DGN, \D:\60P35-MOT-52.DGN, \D:\60P35-MOT-53.DGN, \D:\60P35-MOT-54.DGN, \D:\60P35-MOT-55.DGN, \D:\60P35-MOT-56.DGN, \D:\60P35-MOT-57.DGN, \D:\60P35-MOT-58.DGN, \D:\60P35-MOT-59.DGN, \D:\60P35-MOT-60.DGN, \D:\60P35-MOT-61.DGN, \D:\60P35-MOT-62.DGN, \D:\60P35-MOT-63.DGN, \D:\60P35-MOT-64.DGN, \D:\60P35-MOT-65.DGN, \D:\60P35-MOT-66.DGN, \D:\60P35-MOT-67.DGN, \D:\60P35-MOT-68.DGN, \D:\60P35-MOT-69.DGN, \D:\60P35-MOT-70.DGN, \D:\60P35-MOT-71.DGN, \D:\60P35-MOT-72.DGN, \D:\60P35-MOT-73.DGN, \D:\60P35-MOT-74.DGN, \D:\60P35-MOT-75.DGN, \D:\60P35-MOT-76.DGN, \D:\60P35-MOT-77.DGN, \D:\60P35-MOT-78.DGN, \D:\60P35-MOT-79.DGN, \D:\60P35-MOT-80.DGN, \D:\60P35-MOT-81.DGN, \D:\60P35-MOT-82.DGN, \D:\60P35-MOT-83.DGN, \D:\60P35-MOT-84.DGN, \D:\60P35-MOT-85.DGN, \D:\60P35-MOT-86.DGN, \D:\60P35-MOT-87.DGN, \D:\60P35-MOT-88.DGN, \D:\60P35-MOT-89.DGN, \D:\60P35-MOT-90.DGN, \D:\60P35-MOT-91.DGN, \D:\60P35-MOT-92.DGN, \D:\60P35-MOT-93.DGN, \D:\60P35-MOT-94.DGN, \D:\60P35-MOT-95.DGN, \D:\60P35-MOT-96.DGN, \D:\60P35-MOT-97.DGN, \D:\60P35-MOT-98.DGN, \D:\60P35-MOT-99.DGN, \D:\60P35-MOT-100.DGN

| | | | |
|-------------|----------------------|-----------------|-----------|
| FILE NAME = | USER NAME = *USER* | DESIGNED - BRH | REVISED - |
| *FILEL* | | DRAWN - JZP | REVISED - |
| | PLOT SCALE = *SCALE* | CHECKED - KDA | REVISED - |
| | PLOT DATE = *DATE* | DATE - 10/19/12 | REVISED - |

**STATE OF ILLINOIS
DEPARTMENT OF TRANSPORTATION**

**MAINTENANCE OF TRAFFIC
STAGE 2**

SCALE: 1"=50' SHEET NO. OF SHEETS STA. 124+00 TO STA. 138+00

| | | | | |
|---------------------------|----------|--------|--------------|-----------|
| F.A. RTE. | SECTION | COUNTY | TOTAL SHEETS | SHEET NO. |
| | 0105-WRS | COOK | 537 | 130 |
| CONTRACT NO. 60P35 | | | | |
| ILLINOIS FED. AID PROJECT | | | | |