



**NOTES**

- 1) PER IDOT DISTRICT ONE STANDARD TC-8 OVERLAY "RAMP CLOSED" ON EXISTING GROUND MOUNT AND TRUSS MOUNTED ADVANCE GUIDE SIGNS ALONG WB I-190 FOR SB MANNHEIM ROAD.
- 2) ONE CHANGEABLE MESSAGE SIGN (CMS) SHALL BE FURNISHED AND PLACED AT LOCATION AS DIRECTED BY THE ENGINEER TO ADVISE MOTORISTS OF THE RAMP CLOSURE. THE CMS SHALL BE IN OPERATION FROM TWO WEEKS PRIOR TO THE RAMP CLOSURE UNTIL THE RAMP IS REOPENED TO TRAFFIC.

**LEGEND:**

- DETOUR** M4-8 (O) 24X12 (TYP)
- EAST** M3-2 (O) 24X12 (TYP)
- 12** M1-4 (B/W) 24X24 (TYP)
- SOUTH** M3-3 (O) 24X12 (TYP)
- 45** M1-4 (B/W) 24X24 (TYP)
- M5-2(R)(O) 21X15
- M6-2(R)(O) 21X15
- M5-1(L)(O) 21X15
- M6-1(L)(O) 21X15
- M6-3(O) 21X15

- M5-1(R)(O) 21X15
- M6-1(R)(O) 21X15

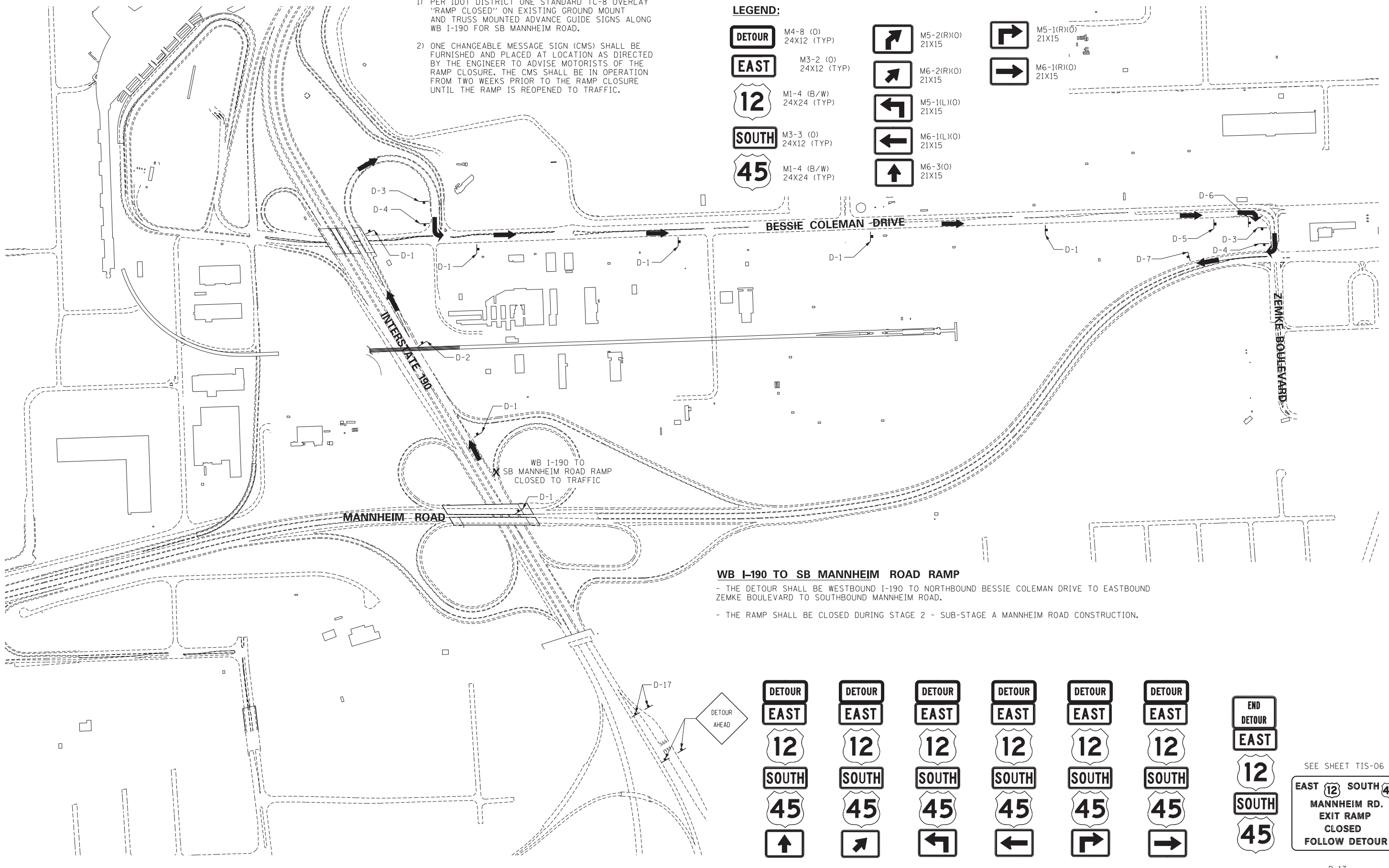

**WB I-190 TO SB MANNHEIM ROAD RAMP**

- THE DETOUR SHALL BE WESTBOUND I-190 TO NORTHBOUND BESSIE COLEMAN DRIVE TO EASTBOUND ZEMKE BOULEVARD TO SOUTHBOUND MANNHEIM ROAD.
- THE RAMP SHALL BE CLOSED DURING STAGE 2 - SUB-STAGE A MANNHEIM ROAD CONSTRUCTION.

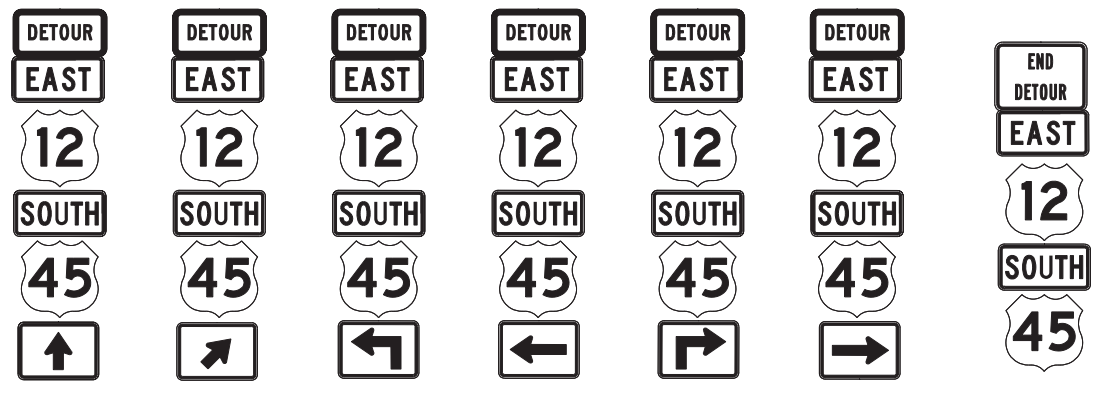

SEE SHEET TIS-06

**EAST 12 SOUTH 45**

**MANNHEIM RD. EXIT RAMP CLOSED FOLLOW DETOUR**

\\N190-MASTER.TOP\DDN...N160P35-SHT-DETOUR\_04.DGN  
 10-05-2012 15:13:28 BAJZEKJ F:\DOC\EXP\CHI-00012584-02\COMMON\SET\TEMP\SHEET\T160P35-SHT-DETOUR\_06.DGN

FILE NAME =	USER NAME = *USER*	DESIGNED - JZP	REVISED -
*FILEL*		DRAWN - JZP	REVISED -
	PLOT SCALE = *SCALE*	CHECKED - MCD	REVISED -
	PLOT DATE = *DATE*	DATE - 10/19/12	REVISED -

**STATE OF ILLINOIS**  
**DEPARTMENT OF TRANSPORTATION**

DETOUR PLAN			
WB I-190 TO SB MANNHEIM ROAD			
SCALE: 1"=300'	SHEET NO.	OF SHEETS	STA. TO STA.

F.A. RTE.	SECTION	COUNTY	TOTAL SHEETS	SHEET NO.
	0105-WRS	COOK	537	164
CONTRACT NO. 60P35				
ILLINOIS FED. AID PROJECT				



DTR-03