

**TYPICAL TRUSS UNIT**

Note: For Section B-B and Section C-C, see Base Sheet OSC-A-3.

There are twice as many horizontal diagonals as there are vertical diagonals.

**TRUSS UNIT TABLE**

Truss Type	Dimension "a"	Dimension "b"	Dimension "s"	Limits for Panel Spacing (P)*	Up. & Low. Chord		Verticals; Horizontals; Vertical, Horizontal, and Interior Diagonals	
					O.D.	Wall	O.D.	Wall
I-C-A	24"	54"	16"	36" min. to 48" max.	5"	5/16"	2 1/2"	5/16"
II-C-A	36"	66"	21"	42" min. to 54" max.	6 1/2"	5/16"	3 1/4"	5/16"
III-C-A (35' Max.)	36"	84"	21"	48" min. to 66" max.	7"	3/8"	3 1/2"	3/8"
III-C-A (>35' to 40')	36"	84"	21"	48" min. to 66" max.	8"	3/8"	3 1/2"	3/8"

$$*P = \frac{L - s - 3''}{\# \text{ Panels}}$$

Structure Number	Station	Truss Type	Design Length (L)	Number of Panels Per Unit	Panel Length (P)*
10016U045R006.2	122+00	II-C-A	28'-10"	6	4'-5 5/8"

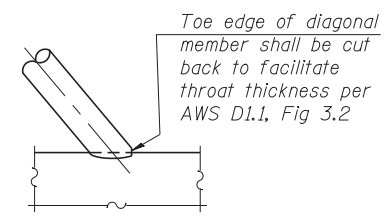
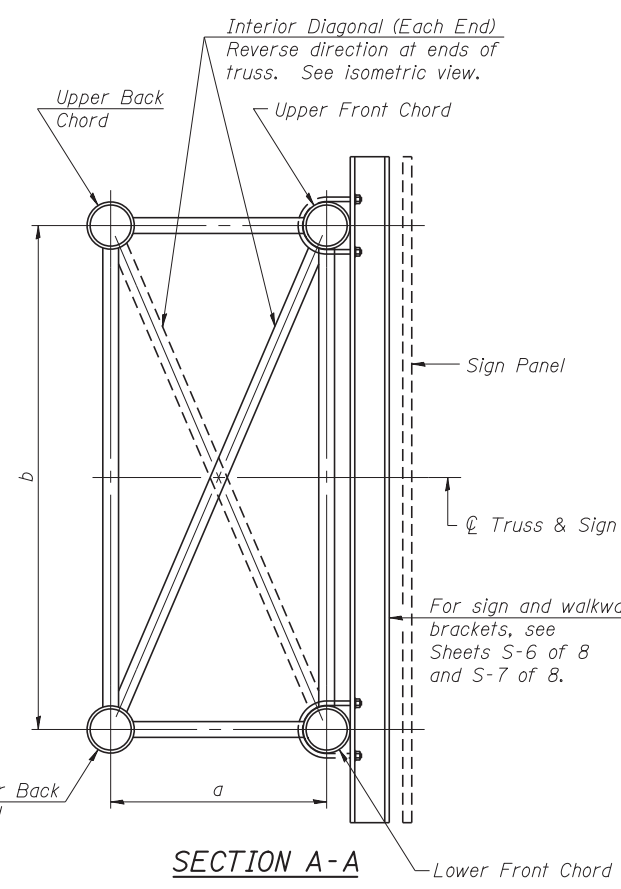

**DETAIL A**

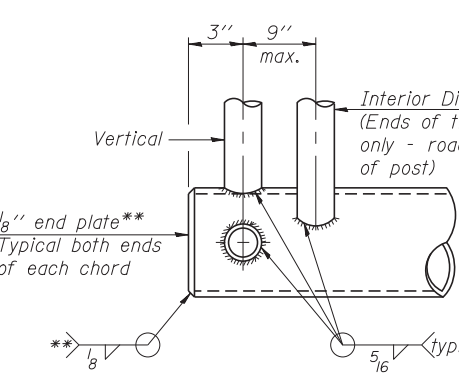

**CANTILEVER END JOINT DETAIL**

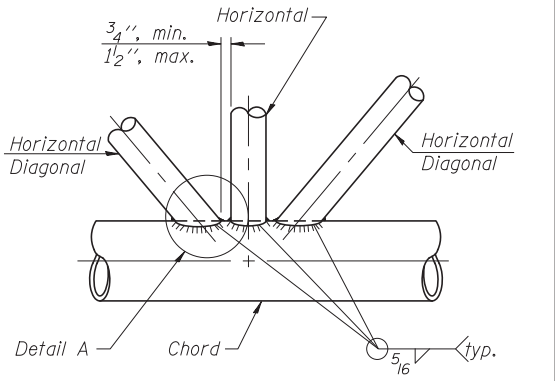

**TRUSS INTERIOR JOINT DETAIL**

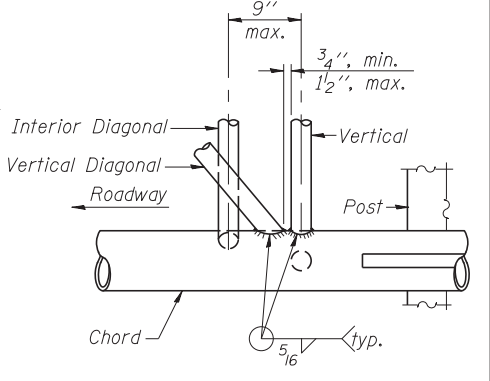

**POST END JOINT DETAIL**

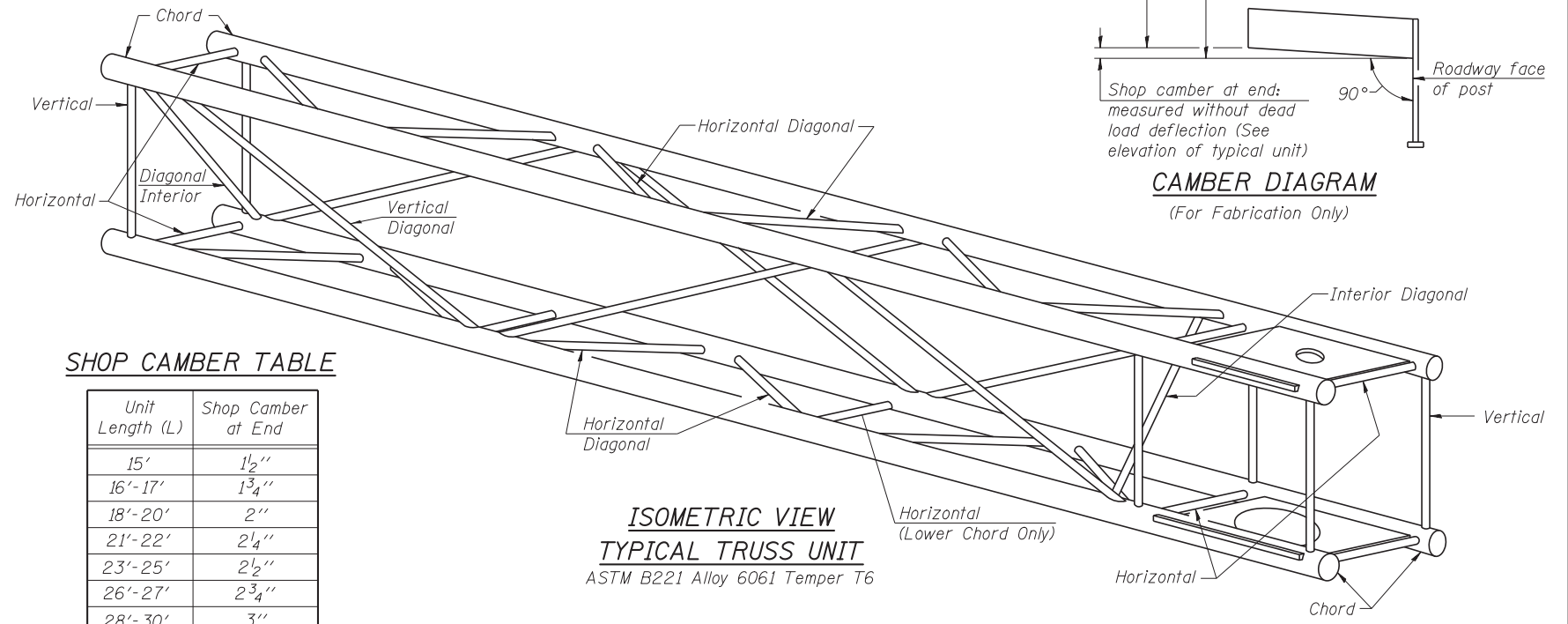

**SHOP CAMBER TABLE**

Unit Length (L)	Shop Camber at End
15'	1 1/2"
16'-17'	1 3/4"
18'-20'	2"
21'-22'	2 1/4"
23'-25'	2 1/2"
26'-27'	2 3/4"
28'-30'	3"
31'-32'	3 1/4"
33'-35'	3 1/2"
36'-37'	4"
38'-40'	4 1/2"

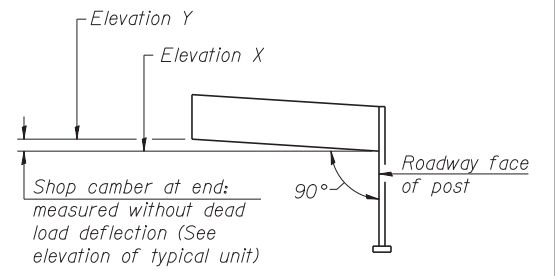

**CAMBER DIAGRAM**

OSC-A-2

9-15-11



USER NAME = lkalite	DESIGNED PCA	REVISED
CHECKED MRI	REVISIONS	REVISED
PLOT SCALE = 0.883333:1	DRAWN LK	REVISED
PLOT DATE = 09-OCT-2012	DATE 10/19/12	REVISED

**STATE OF ILLINOIS**  
**DEPARTMENT OF TRANSPORTATION**

**CANTILEVER SIGN STRUCTURES - TRUSS DETAILS**  
**ALUMINUM TRUSS & STEEL POST**

SHEET NO. S-2 OF 8 SHEETS

F.A. RTE.	SECTION	COUNTY	TOTAL SHEETS	SHEET NO.
330	0105-WRS	COOK	537	219
CONTRACT NO. 60P35				

ILLINOIS FED. AID PROJECT