

SEE MATCHLINE STATION 182 + 00

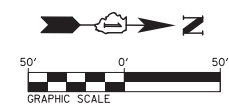
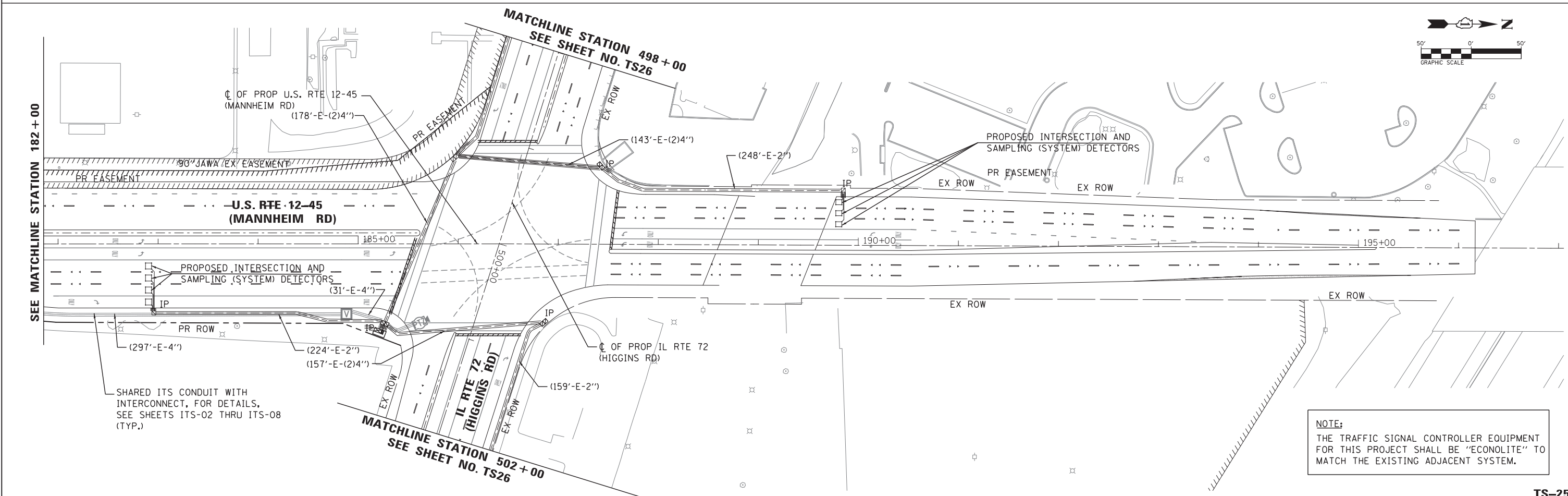

SEE MATCHLINE STATION 182 + 00

MATCHLINE STATION 498 + 00  
SEE SHEET NO. TS26

MATCHLINE STATION 502 + 00  
SEE SHEET NO. TS26

**NOTE:**  
THE TRAFFIC SIGNAL CONTROLLER EQUIPMENT FOR THIS PROJECT SHALL BE "ECONOLITE" TO MATCH THE EXISTING ADJACENT SYSTEM.



USER NAME = rmmucod	DESIGNED JA	REVISED -
	DRAWN RM	REVISED -
PLOT SCALE = *SCALE*	CHECKED HS	REVISED -
PLOT DATE = 11/29/2012	DATE 10/19/2012	REVISED -

**STATE OF ILLINOIS  
DEPARTMENT OF TRANSPORTATION**

**INTERCONNECT PLAN  
US RTE 12-45 (MANNHEIM RD) FROM ZEMKE BLVD  
TO IL 72 (HIGGINS RD) (SHEET 1 OF 2)**

SCALE:	SHEET NO.	OF SHEETS	STA.	TO STA.
--------	-----------	-----------	------	---------

F.A.P. RTE.	SECTION	COUNTY	TOTAL SHEETS	SHEET NO.
330	0105-WRS	COOK	537	258
CONTRACT NO. 60P35				
ILLINOIS FED. AID PROJECT				

TS-25

FILE NAME = c:\cadd\lib\p\m\mucod2\p\great.lakes\dms47849\0160P35-sht.1.ts29.dgn