

**AUXILIARY LANE MARKINGS**

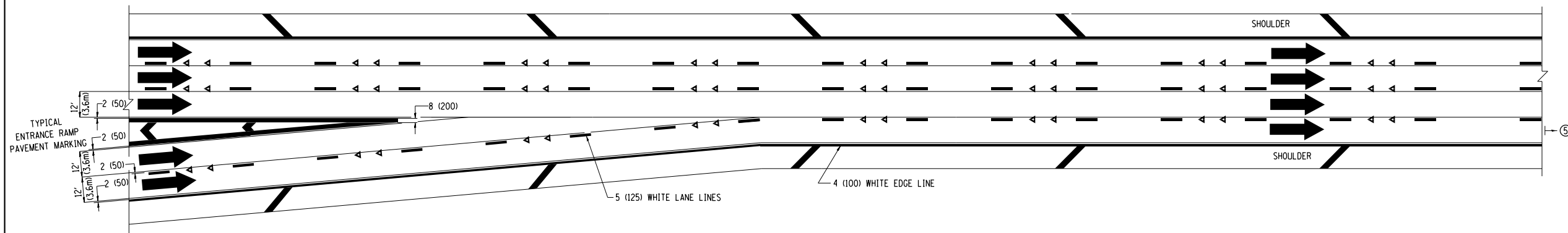

**TWO LANE ENTRANCE RAMP WITH MERGE MARKINGS**

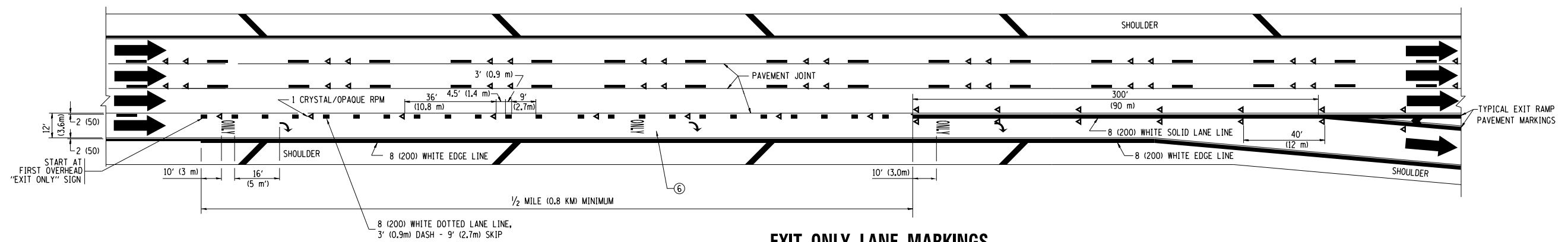

**EXIT ONLY LANE MARKINGS**

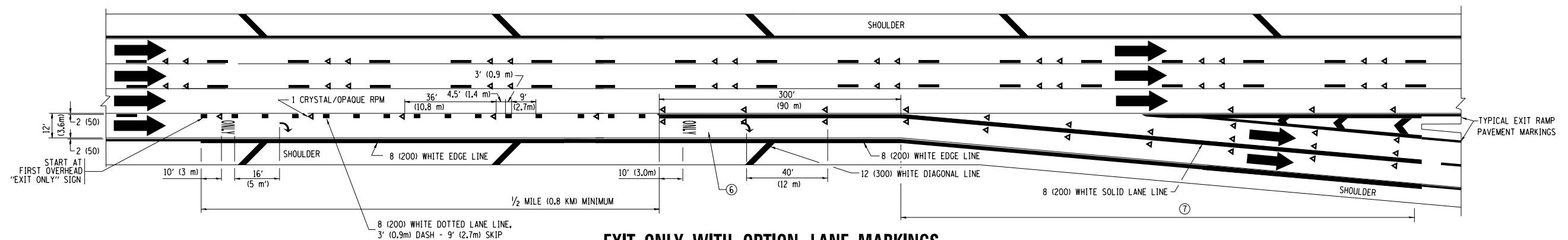

**EXIT ONLY WITH OPTION LANE MARKINGS**

- NOTES**
- ③ OMIT WHEN LENGTH OF AUXILIARY LANE IS LESS THAN 500' (150 m).
  - ④ 8-INCH WIDE DOTTED LANE LINE MARKINGS SHALL BE USED WHEN THE LENGTH OF THE AUXILIARY LANE IS 2 MILES OR LESS.
  - ⑤ FOR TWO-LANE ENTRANCE RAMP, IF RIGHT LANE ENDS, USE TYPICAL ENTRANCE RAMP PAVEMENT MARKINGS.
  - ⑥ ONLY AND ARROWS EQUALLY SPACED, 500' (150 m) MAXIMUM SPACING. FULL SIZE LETTERS AND ARROW SHALL BE USED.
  - ⑦ CONTINUE 8" SOLID LANE LINE THROUGH EXIT TO END OF PAVED GORE.

FILE NAME =	USER NAME = rodriguezma	DESIGNED - D.W.S.	REVISED - D.W.S. 07-96
ei:\pw\work\p1dot\rodriguezma\d0299718\01stStd.dgn		DRAWN -	REVISED - J.A.F. 02-06
	PLOT SCALE = 100.0000' / in.	CHECKED -	REVISED - S.P.B. 01-07
	PLOT DATE = 10/18/2012	DATE - 01-90	REVISED - S.P.B. 01-10

**STATE OF ILLINOIS  
DEPARTMENT OF TRANSPORTATION**

MULTI-LANE FREEWAY PAVEMENT MARKING DETAILS			
SCALE: NONE	SHEET NO. 2 OF 2 SHEETS	STA.	TO STA.

F.A.I. RTE.	SECTION	COUNTY	TOTAL SHEETS	SHEET NO.
190	(0101.6&0102.5)RS-2	COOK	85	69
TC-12		CONTRACT NO. 60T33		
FED. ROAD DIST. NO. 1 ILLINOIS FED. AID PROJECT				