

DECK PLAN

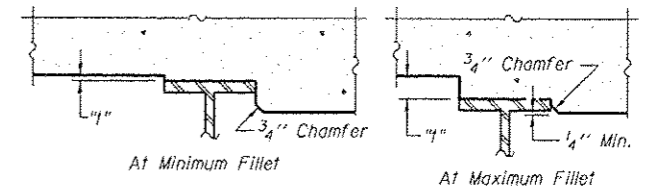

To determine "f": After all structural steel has been erected, elevations of the top flanges of the beams shall be taken at intervals shown below. These elevations subtracted from the "Theoretical Grade Elevations Adjusted for Dead Load Deflection" shown below, minus slab thickness, equals the fillet heights "f" above top flange of beams.

FILLET HEIGHTS

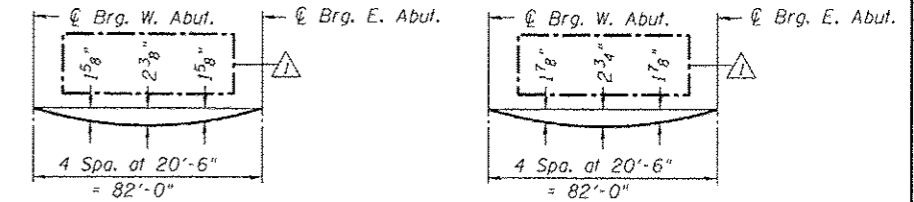

INTERIOR BEAM DEAD LOAD DEFLECTION DIAGRAM

(Includes weight of concrete only.)

Note:
The above deflections are not to be used in the field if the Engineer is working from the grade elevations adjusted for dead load deflection as shown below and on sheets 7 and 8 of 30.
Offsets are measured perpendicular from the centerline of Willow Road.

FACE OF NORTH PARAPET

Location	Station	Offset	Theoretical Grade Elevations	Theoretical Grade Elevations Adjusted For Dead Load Deflection
Bk. W. Abut.	714+45.19	-35.00	633.09	633.09
☉ Brg. W. Abut.	714+46.44	-35.00	633.09	633.09
A	714+56.44	-35.00	633.13	633.22
B	714+66.44	-35.00	633.16	633.32
C	714+76.44	-35.00	633.17	633.38
D	714+86.44	-35.00	633.17	633.40
E	714+96.44	-35.00	633.17	633.39
F	715+06.44	-35.00	633.15	633.32
G	715+16.44	-35.00	633.12	633.22
☉ Brg. E. Abut.	715+28.44	-35.00	633.07	633.07
Bk. E. Abut.	715+29.69	-35.00	633.06	633.06

BEAM 1

Location	Station	Offset	Theoretical Grade Elevations	Theoretical Grade Elevations Adjusted For Dead Load Deflection
Bk. W. Abut.	714+45.19	-33.75	633.07	633.07
☉ Brg. W. Abut.	714+46.44	-33.75	633.07	633.07
A	714+56.44	-33.75	633.11	633.19
B	714+66.44	-33.75	633.14	633.29
C	714+76.44	-33.75	633.15	633.35
D	714+86.44	-33.75	633.15	633.37
E	714+96.44	-33.75	633.15	633.36
F	715+06.44	-33.75	633.13	633.30
G	715+16.44	-33.75	633.10	633.20
☉ Brg. E. Abut.	715+28.44	-33.75	633.05	633.05
Bk. E. Abut.	715+29.69	-33.75	633.04	633.04

BEAM 2

Location	Station	Offset	Theoretical Grade Elevations	Theoretical Grade Elevations Adjusted For Dead Load Deflection
Bk. W. Abut.	714+45.19	-27.00	632.93	632.93
☉ Brg. W. Abut.	714+46.44	-27.00	632.93	632.93
A	714+56.44	-27.00	632.97	633.06
B	714+66.44	-27.00	633.00	633.16
C	714+76.44	-27.00	633.01	633.22
D	714+86.44	-27.00	633.01	633.24
E	714+96.44	-27.00	633.01	633.23
F	715+06.44	-27.00	632.99	633.16
G	715+16.44	-27.00	632.96	633.06
☉ Brg. E. Abut.	715+28.44	-27.00	632.91	632.91
Bk. E. Abut.	715+29.69	-27.00	632.90	632.90

12/19/2012 4:37:35 PM - G:\CH\059\Bridges\CAD\Drawings\022814-0160135-06-51\BEL\dwg



USER NAME : jrmokow	DESIGNED - JRM	REVISED - 12/19/2012 JRM
PLOT SCALE = 16:0.8228 1/4" = 1'	CHECKED - MDS	REVISED -
PLOT DATE = 12/19/2012	DRAWN - DMG	REVISED -
	CHECKED - MDS	REVISED -

**STATE OF ILLINOIS
DEPARTMENT OF TRANSPORTATION**

**TOP OF SLAB ELEVATIONS
STRUCTURE NO. 016-2844**

SHEET NO. 6 OF 30 SHEETS

F.A.P. RTE.	SECTION	COUNTY	TOTAL SHEETS	SHEET NO.
0305	(1920.01,1518,2022&1922,401R)	COOK	919	456
CONTRACT NO. 60T35			ILLINOIS FED. AID PROJECT	