

DATE	
BY	
PLAN	
SURVEYED	
ALIGNMENT CHECKED	
RT. OF WAY CHECKED	
NOTE BOOK NO.	
CADD FILE NAME	

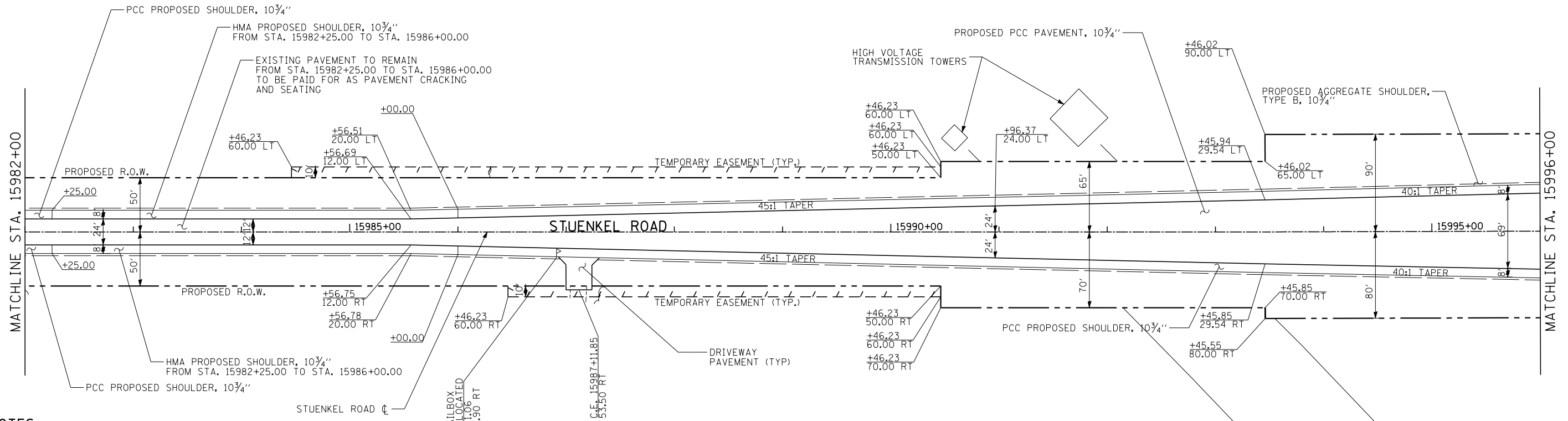

- NOTES:**
- FOR DRIVEWAY DETAILS SEE SCHEDULE OF QUANTITIES
 - EXISTING ROW LINEWORK HAS BEEN OMITTED FOR CLARITY

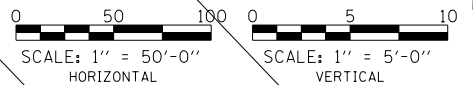

DATE	
BY	
PROFILE	
SURVEYED	
GRADES CHECKED	
B.M. NOTED	
STRUCTURE NOTATIONS CHKD	
NOTE BOOK NO.	

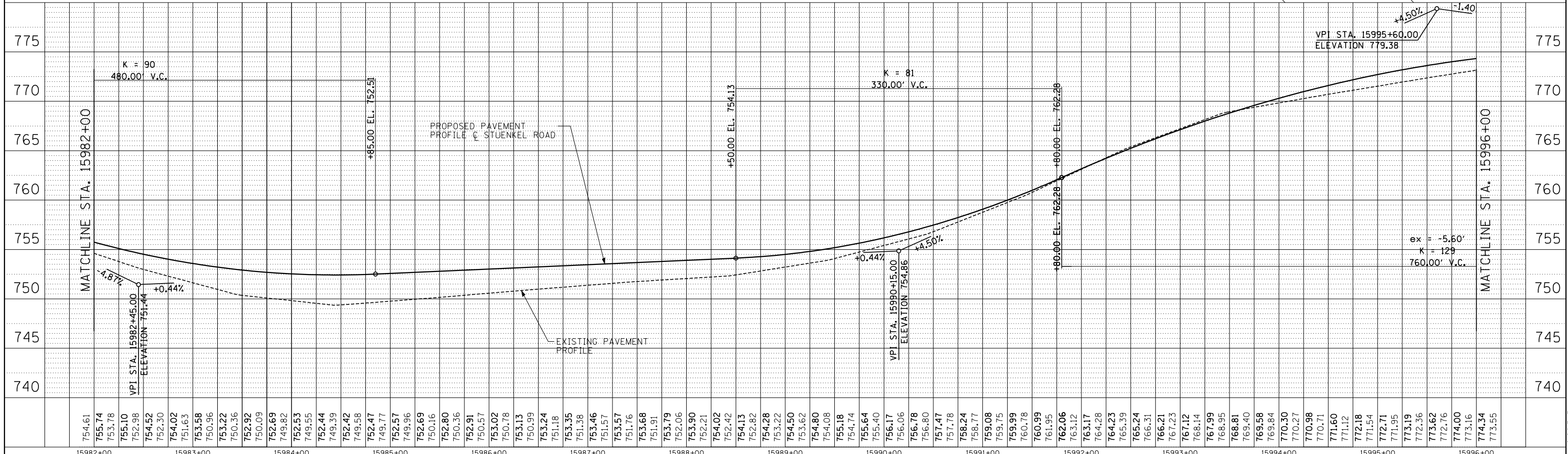

TYLIN INTERNATIONAL USER NAME = PLOT SCALE = PLOT DATE =	DESIGNED - DPS	REVISED -	STATE OF ILLINOIS DEPARTMENT OF TRANSPORTATION STUENKEL ROAD AT I-57 (HARLEM AVENUE TO RIDGELAND AVENUE) STUENKEL ROAD PROPOSED PLAN AND PROFILE	F.A.I. RTE. 57	SECTION 2012-048R	COUNTY WILL	TOTAL SHEETS 206	SHEET NO. 35
	DRAWN - DPS	REVISED -		CONTRACT NO. 60V41				
	CHECKED - JPM	REVISED -		ILLINOIS FED. AID PROJECT				
	DATE - 9/19/2012	REVISED - 11/2/2012						