

PLAN	SURVEYED	DATE
	ALIGNMENT CHECKED	
	RT. OF WAY CHECKED	
	NO. _____	
	FILE NAME	

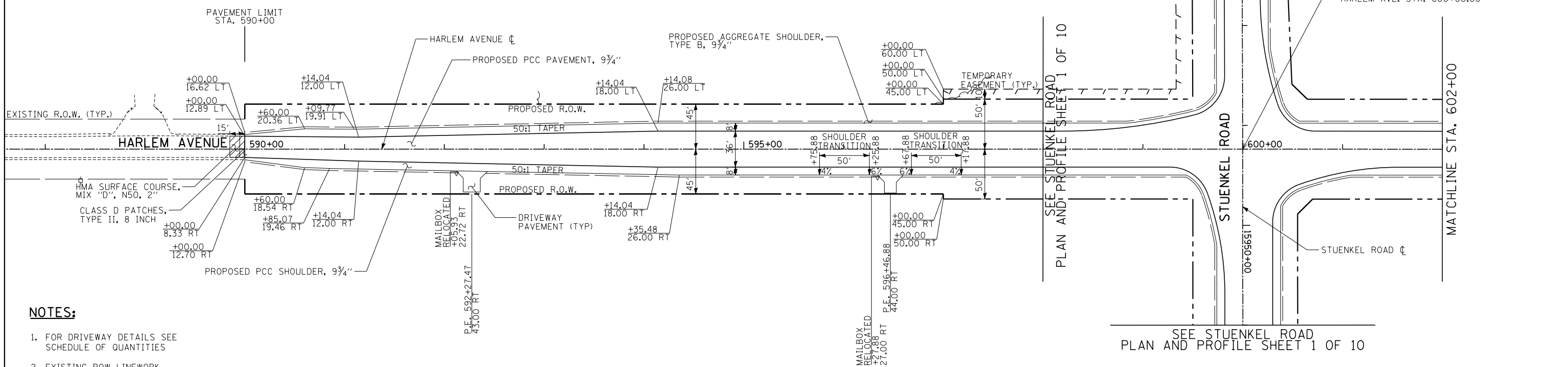

NOTES:

- FOR DRIVEWAY DETAILS SEE SCHEDULE OF QUANTITIES
- EXISTING ROW LINWORK HAS BEEN OMITTED FOR CLARITY

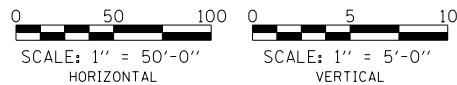

PROFILE	SURVEYED	DATE
	GRADES CHECKED	
	B.M. NOTED	
	STRUCTURE NOTATIONS CHKD	
	NO. _____	

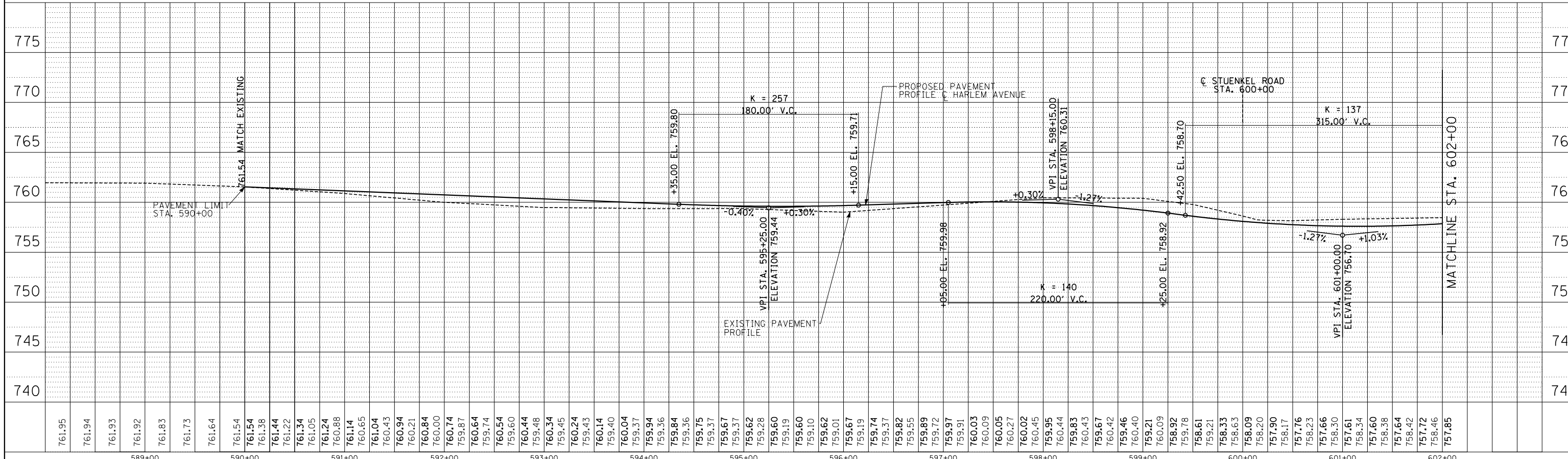

761.95	761.94	761.93	761.92	761.83	761.73	761.64	761.54	761.54	761.38	761.44	761.22	761.34	761.05	761.24	760.88	761.14	760.65	761.04	760.43	760.94	760.21	760.84	760.74	759.87	760.64	759.74	760.54	759.60	760.44	759.48	759.45	759.43	759.40	760.04	759.37	759.94	759.36	759.84	759.36	759.75	759.37	759.67	759.37	759.62	759.28	759.60	759.19	759.60	759.10	759.62	759.01	759.67	759.19	759.74	759.37	759.82	759.55	759.89	759.72	759.97	759.91	760.03	760.09	760.05	760.27	760.02	760.45	759.95	760.44	759.83	760.43	759.67	760.42	759.46	760.40	759.21	760.09	758.92	759.78	758.61	759.21	758.33	758.63	758.09	758.20	757.90	758.17	757.76	758.23	757.66	758.30	757.61	758.34	757.60	757.64	758.42	757.72	758.46	757.85
589+00		590+00		591+00		592+00		593+00		594+00		595+00		596+00		597+00		598+00		599+00		600+00		601+00		602+00																																																																									

TYLIN INTERNATIONAL

USER NAME =	DESIGNED - DPS	REVISED -
PLOT SCALE =	DRAWN - DPS	REVISED -
PLOT DATE =	CHECKED - JPM	REVISED -
	DATE - 9/19/2012	REVISED - 11/2/2012

**STATE OF ILLINOIS
DEPARTMENT OF TRANSPORTATION**

**STUENKEL ROAD AT I-57 (HARLEM AVENUE TO RIDGELAND AVENUE)
HARLEM AVENUE PROPOSED PLAN AND PROFILE**

F.A.I. RTE.	SECTION	COUNTY	TOTAL SHEETS	SHEET NO.
57	2012-048R	WILL	206	37
CONTRACT NO. 60V41			ILLINOIS FED. AID PROJECT	