

PLAN	SURVEYED	DATE
	ALIGNED	BY
	RT. OF WAY CHECKED	
	NO. _____	
	PAID FILE NAME	

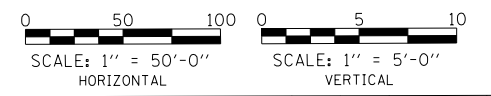

PROFILE	SURVEYED	DATE
	PLOTTED	BY
	STRUCTURE NOTATED	
	NO. _____	

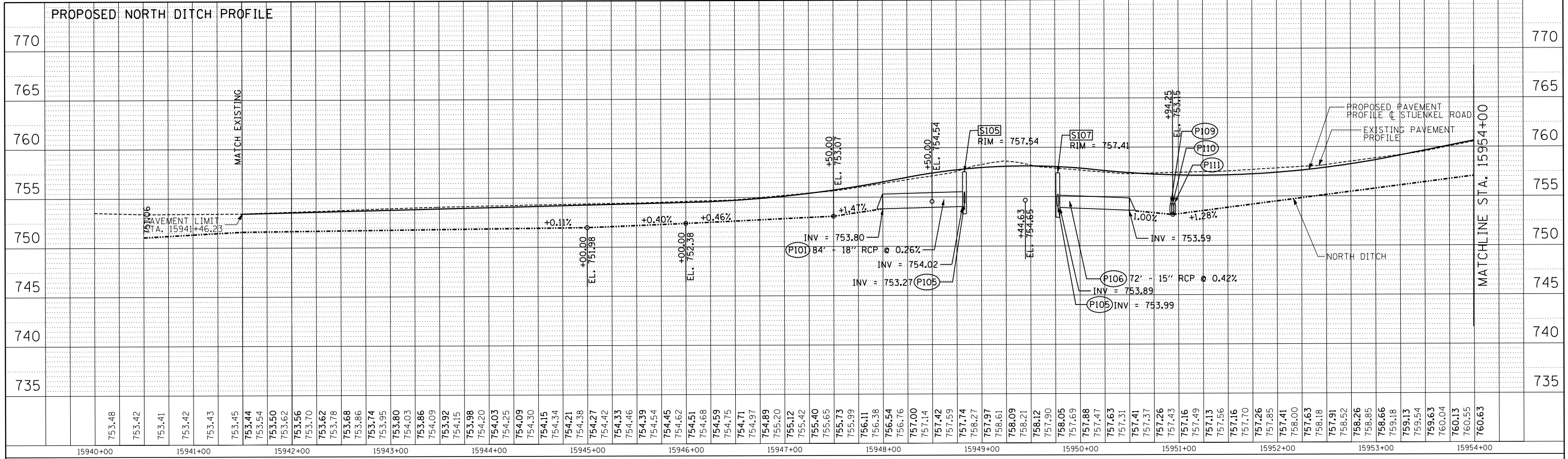
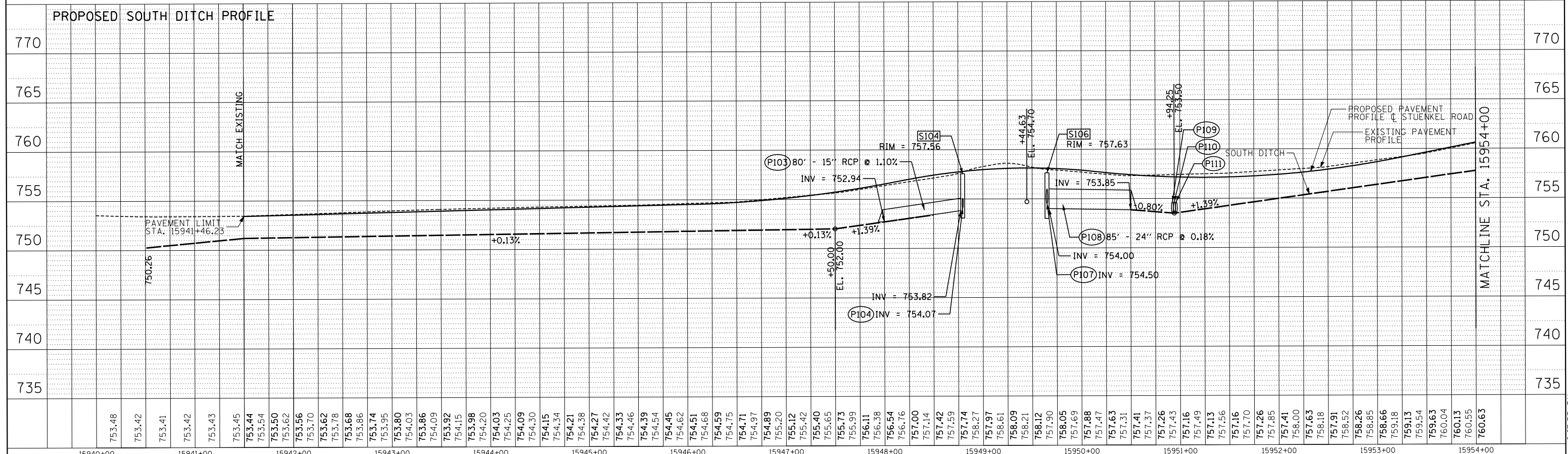

TYLIN INTERNATIONAL USER NAME = PLOT SCALE = PLOT DATE =	DESIGNED - PP	REVISED -	STATE OF ILLINOIS DEPARTMENT OF TRANSPORTATION STUENKEL ROAD AT I-57 (HARLEM AVENUE TO RIDGELAND AVENUE) PROPOSED DRAINAGE PROFILE (STUENKEL ROAD) SCALE: 1" = 50' SHEET 2 OF 9 SHEETS STA. 15940+00 TO STA. 15954+00	F.A.I. RTE. = 57	SECTION = 2012-048R	COUNTY = WILL	TOTAL SHEETS = 206	SHEET NO. = 66
	CHECKED - JPM	REVISED -		CONTRACT NO. 60V41				
	DATE - 9/19/2012	REVISED - 11/2/2012		ILLINOIS FED. AID PROJECT				
	11/27/2012							