

PLAN	SURVEYED	BY	DATE
	ALIGNED		
	NOTED		
	RT. OF WAY CHECKED		
	CADD FILE NAME		
	NO.		

PROFILE	SURVEYED	BY	DATE
	GRADES CHECKED		
	B.M. NOTED		
	STRUCTURE NOTATIONS CHKD		
	NO.		

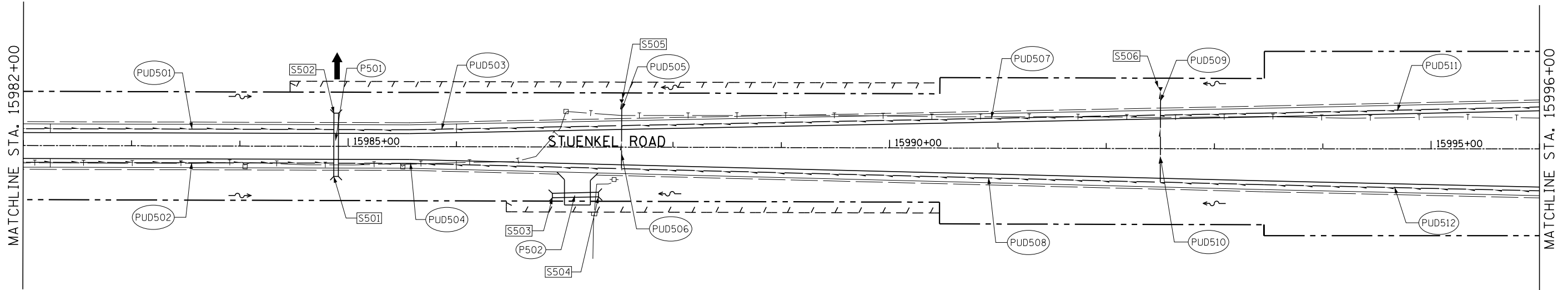

**NOTES:**

- EXISTING ROW LINEWORK HAS BEEN OMITTED FOR CLARITY.
- PROPOSED PIPE UNDERDRAINS HAVE BEEN OFFSET FOR CLARITY.

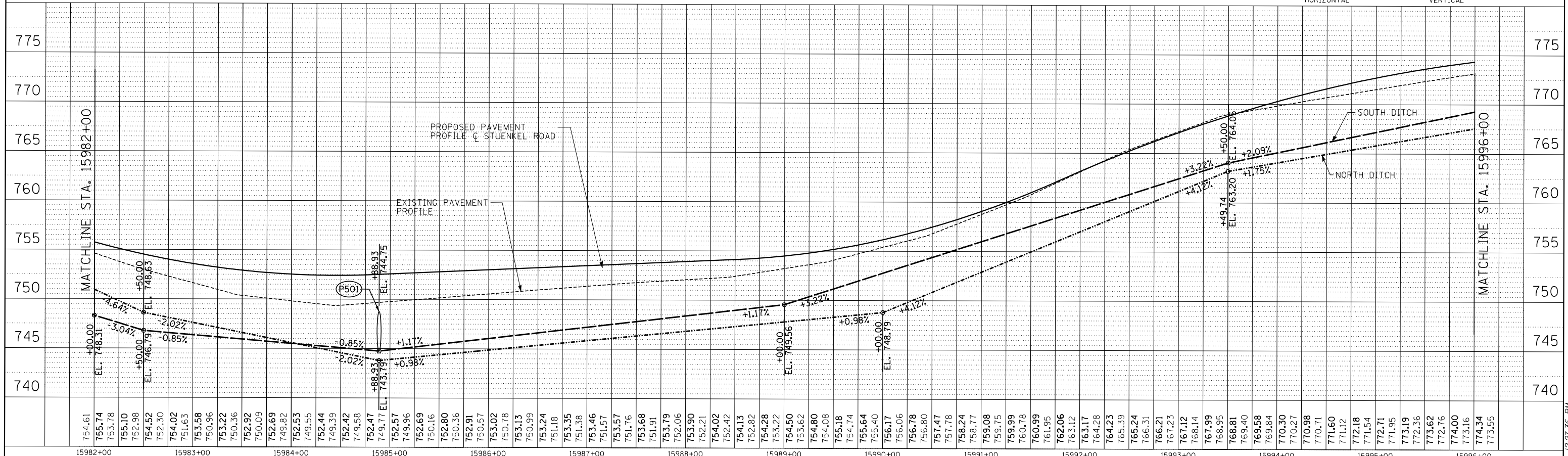

<b>TYLIN INTERNATIONAL</b> PLOT SCALE = PLOT DATE =	USER NAME =	DESIGNED - PP	REVISED -	<b>STATE OF ILLINOIS</b> <b>DEPARTMENT OF TRANSPORTATION</b> <b>STUENKEL ROAD AT I-57 (HARLEM AVENUE TO RIDGELAND AVENUE)</b> <b>PROPOSED DRAINAGE PLAN AND PROFILE (STUENKEL ROAD)</b> SCALE: 1" = 50' SHEET 5 OF 9 SHEETS STA. 15982+00 TO STA. 15996+00	F.A.I. RTE. 57	SECTION 2012-048R	COUNTY WILL	TOTAL SHEETS 206	SHEET NO. 69
	DRAWN - PP	CHECKED - JPM	REVISED -		CONTRACT NO. 60V41				
	DATE - 9/19/2012	REVISED - 11/2/2012	ILLINOIS FED. AID PROJECT						