

DATE	
BY	
SURVEYED	
PLOTTED	
TEMPLATE	
AREAS	
CHECKED	
FINAL SURVEY	
NOTE BOOK	
NO.	

DATE	
BY	
SURVEYED	
PLOTTED	
TEMPLATE	
AREAS	
CHECKED	
ORIGINAL SURVEY	
NOTE BOOK	
NO.	

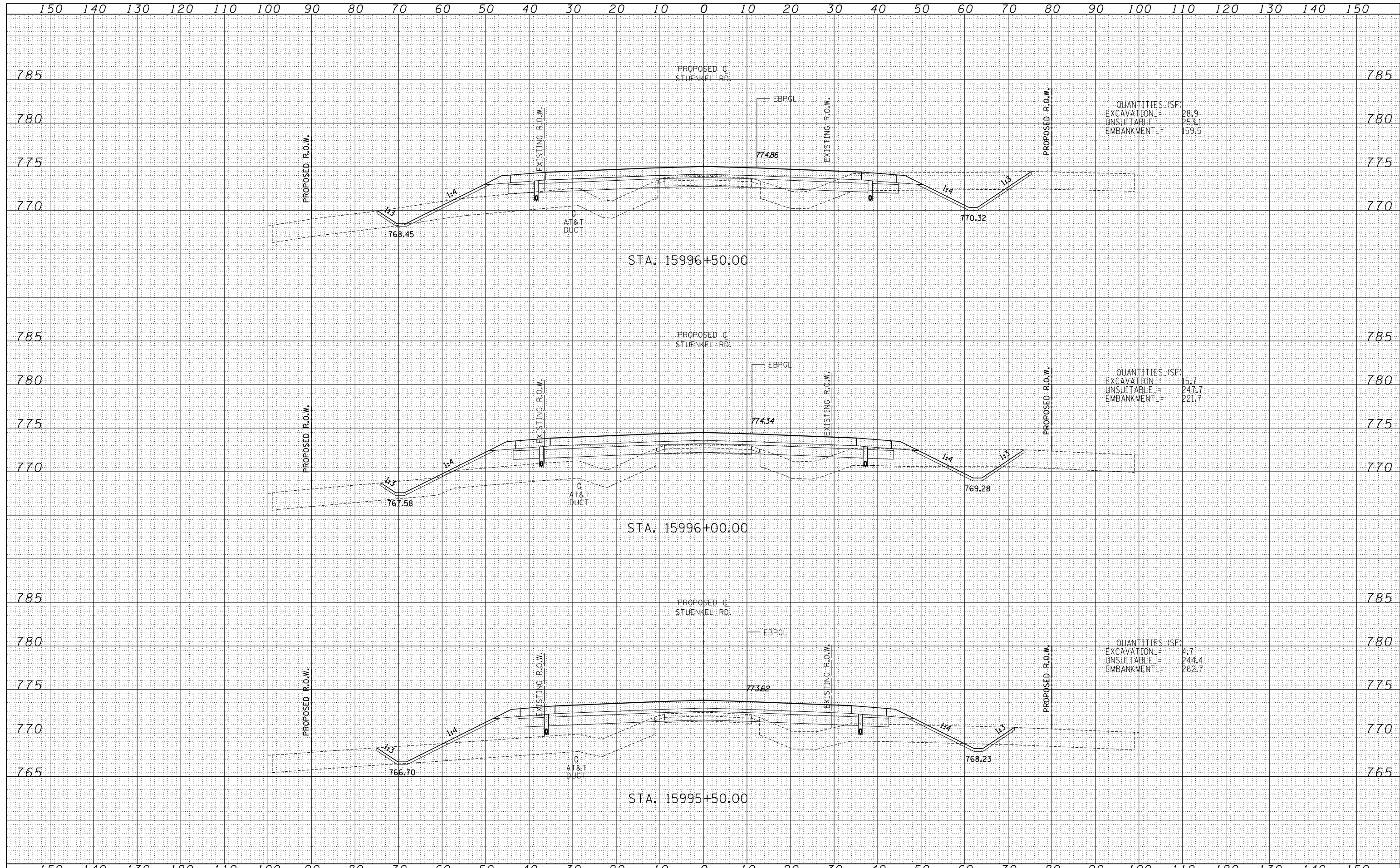

TYLIN INTERNATIONAL	USER NAME =	DESIGNED - JDF	REVISED -	STATE OF ILLINOIS DEPARTMENT OF TRANSPORTATION	STUENKEL ROAD AT I-57 (HARLEM AVE. TO RIDGELAND AVE.) PROPOSED STUENKEL ROAD CROSS SECTIONS		F.A.I. RTE. = 57	SECTION = 2012-048R	COUNTY = WILL	TOTAL SHEETS = 206	SHEET NO. = 166
	PLOT SCALE =	CHECKED - JPM	REVISED -		SCALE: 1" = 100' H	SHEET NO. OF SHEETS	STA. 15995+50.00 TO STA. 15996+50.00	CONTRACT NO. 60V41		ILLINOIS FED. AID PROJECT	
	PLOT DATE =	DATE = 9/19/2012	REVISED -								

P:\602612(I-57 @ Stuenkel)\Road\C_2(Interchange)\C2.Stuenkel.50XS.F_SHT.dgn