

DATE	
BY	
FINISHED SURVEY	
PLOTTED	
TEMPLATE	
AREAS CHECKED	
NO.	

DATE	
BY	
ORIGINAL SURVEY	
PLOTTED	
TEMPLATE	
AREAS CHECKED	
NO.	

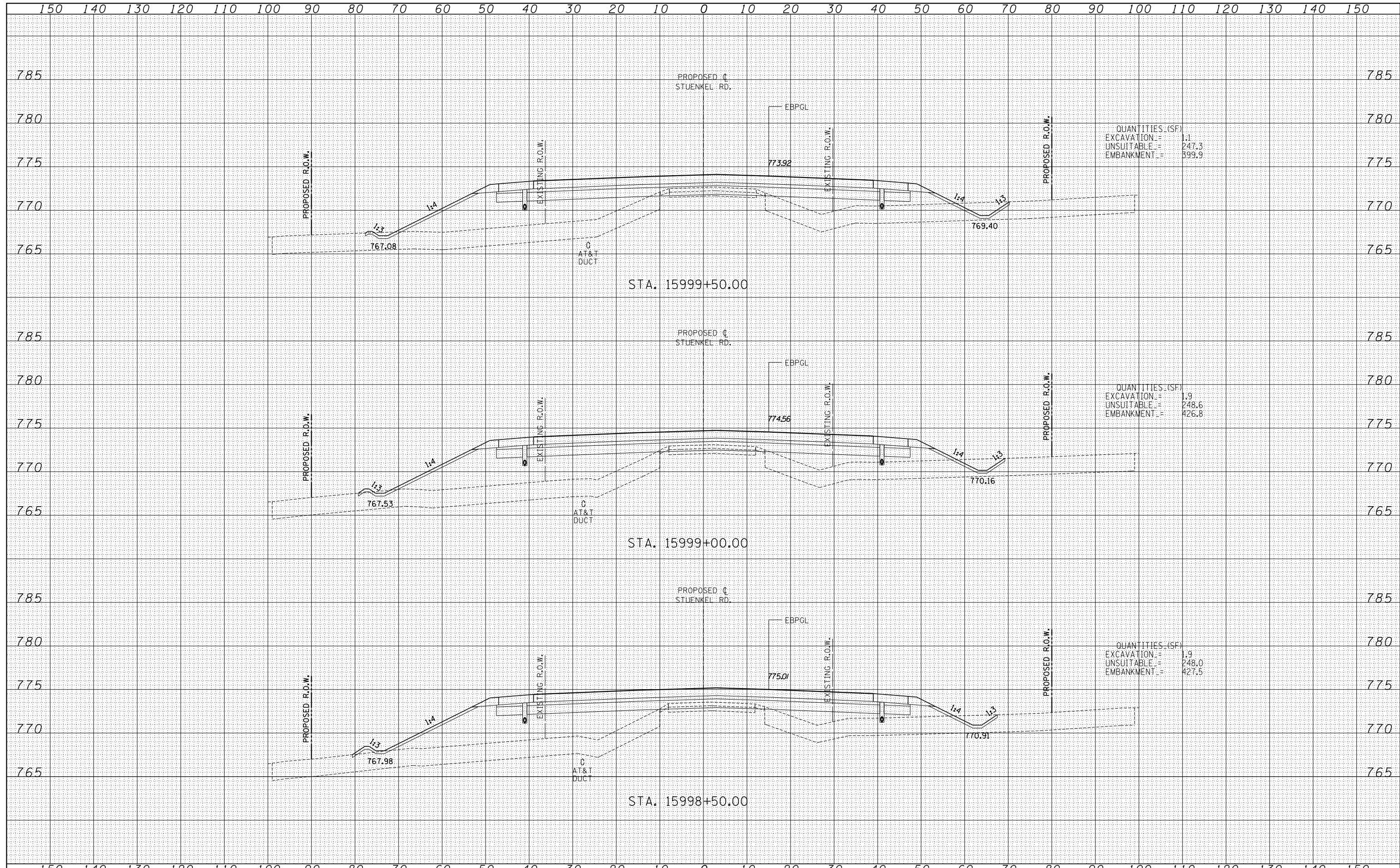

TYLINT INTERNATIONAL

USER NAME =	DESIGNED - JDF	REVISED -
	DRAWN - JDF	REVISED -
PLOT SCALE =	CHECKED - JPM	REVISED -
PLOT DATE =	DATE - 9/19/2012	REVISED -

STATE OF ILLINOIS
DEPARTMENT OF TRANSPORTATION

STUENKEL ROAD AT I-57 (HARLEM AVE. TO RIDGELAND AVE.)
PROPOSED STUENKEL ROAD CROSS SECTIONS

SCALE: 1" = 100' V^H

F.A.I. RTE.	SECTION	COUNTY	TOTAL SHEETS	SHEET NO.
57	2012-048R	WILL	206	168
				CONTRACT NO. 60V41
FED. ROAD DIST. NO.		ILLINOIS FED. AID PROJECT		

P:\602612(I-57_e.Stuenkel)\Road\C_2(Interchange)\C2.Stuenkel.50XS.F_SHT.dgn