

DATE	
BY	
SURVEYED	
PLOTTED	
TEMPLATE	
AREAS	
CHECKED	
NO.	

DATE	
BY	
SURVEYED	
PLOTTED	
TEMPLATE	
AREAS	
CHECKED	
NO.	

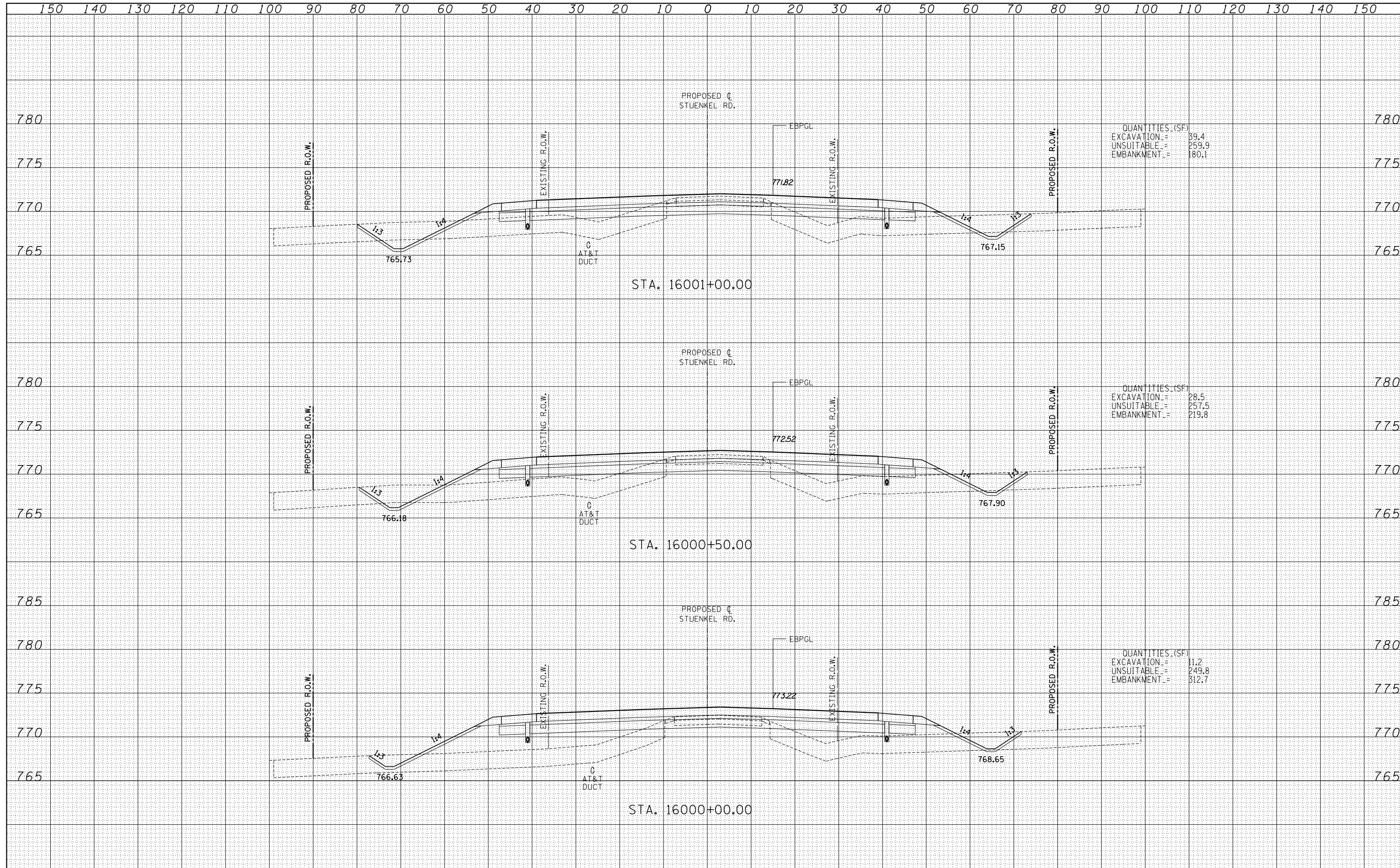

TYLIN INTERNATIONAL USER NAME = PLOT SCALE = PLOT DATE =	DESIGNED - JDF DRAWN - JDF CHECKED - JPM DATE - 9/19/2012	REVISED - REVISED - REVISED - REVISED -	STATE OF ILLINOIS DEPARTMENT OF TRANSPORTATION STUENKEL ROAD AT I-57 (HARLEM AVE. TO RIDGELAND AVE.) PROPOSED STUENKEL ROAD CROSS SECTIONS	F.A.I. RTE. = 57 SECTION = 2012-048R COUNTY = WILL ILLINOIS FED. AID PROJECT	TOTAL SHEETS = 206 SHEET NO. = 169 CONTRACT NO. = 60V41
	SCALE: 1" = 100' H SHEET NO. OF SHEETS STA. 16000+00.00 TO STA. 16001+00.00	REVISED -		STA. 16000+00.00 TO STA. 16001+00.00	

P:\602612(I-57_e_Stuenkel)\Road\C_2(Interchange)\C2.Stuenkel.50XS.F_SHT.dgn