

FOR INFORMATION ONLY

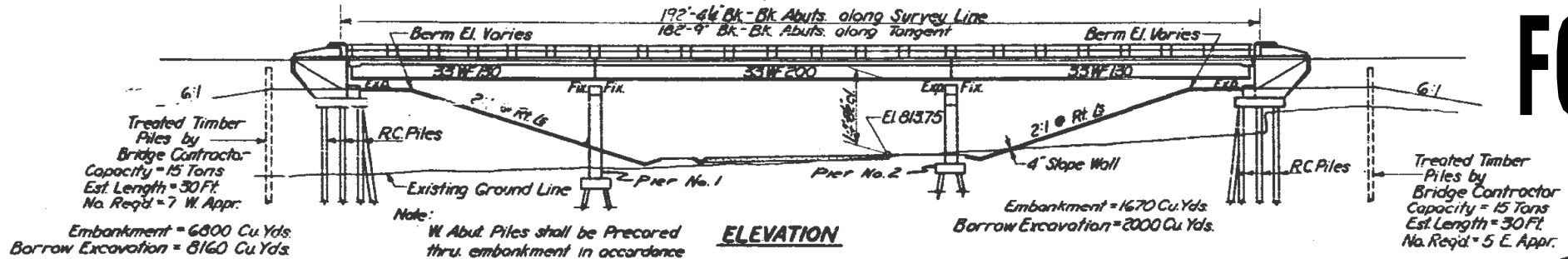

ELEVATION

Note: W. Abut. Piles shall be Precored thru. embankment in accordance with Art. 60.9 (c) of the Standard Specifications.

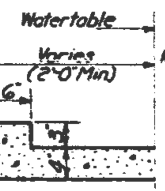

SEC. A-A

NOTE: 3185 Cu. Yds. Earth Excavation from Detour Road to be used in Embankment. See Sheet No. 3. Total Borrow Excavation 6,975 Cu. Yds.

FA RT. 6 W. BOUND

CURVE DATA	
Δ	16°-8'
D	2'-00"
T	406.05
L	806.67
E	28.63
R	2865.0'
P.C. Sta	26+02.83
P.I. Sta	30+08.88
P.T. Sta	34+09.50
S	.0321ft. 50 MPH

RAMP E

CURVE DATA	
Δ	47°-3'
D	8'-42.84'
T	286.25
L	539.94
E	59.61
R	657.55
P.C.C. Sta	5+54.32
P.I. Sta	8+40.57
P.T. Sta	10+94.26
S	.0831ft

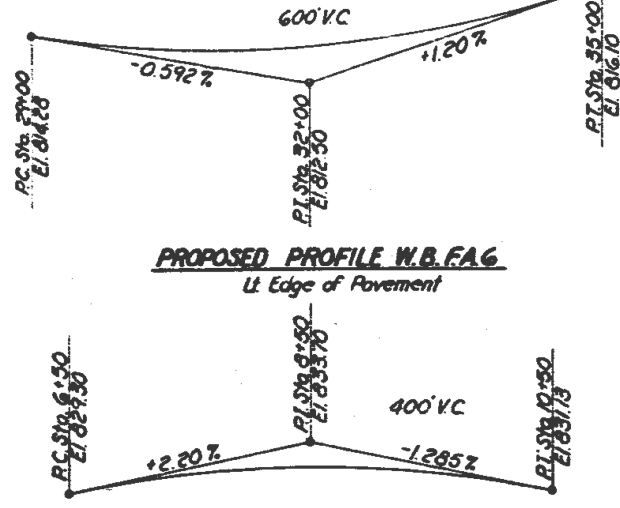

PROPOSED PROFILE W.B. FA 6

PROPOSED PROFILE RAMP E



STATION 31+70.17
BUILT 196 BY
STATE OF ILLINOIS
FA RT. 6 SEC. 08-HB-1
FA PROJECT F-613(B)
LOADING H20-S16

LETTERING FOR NAME PLATE
See Standard 2113

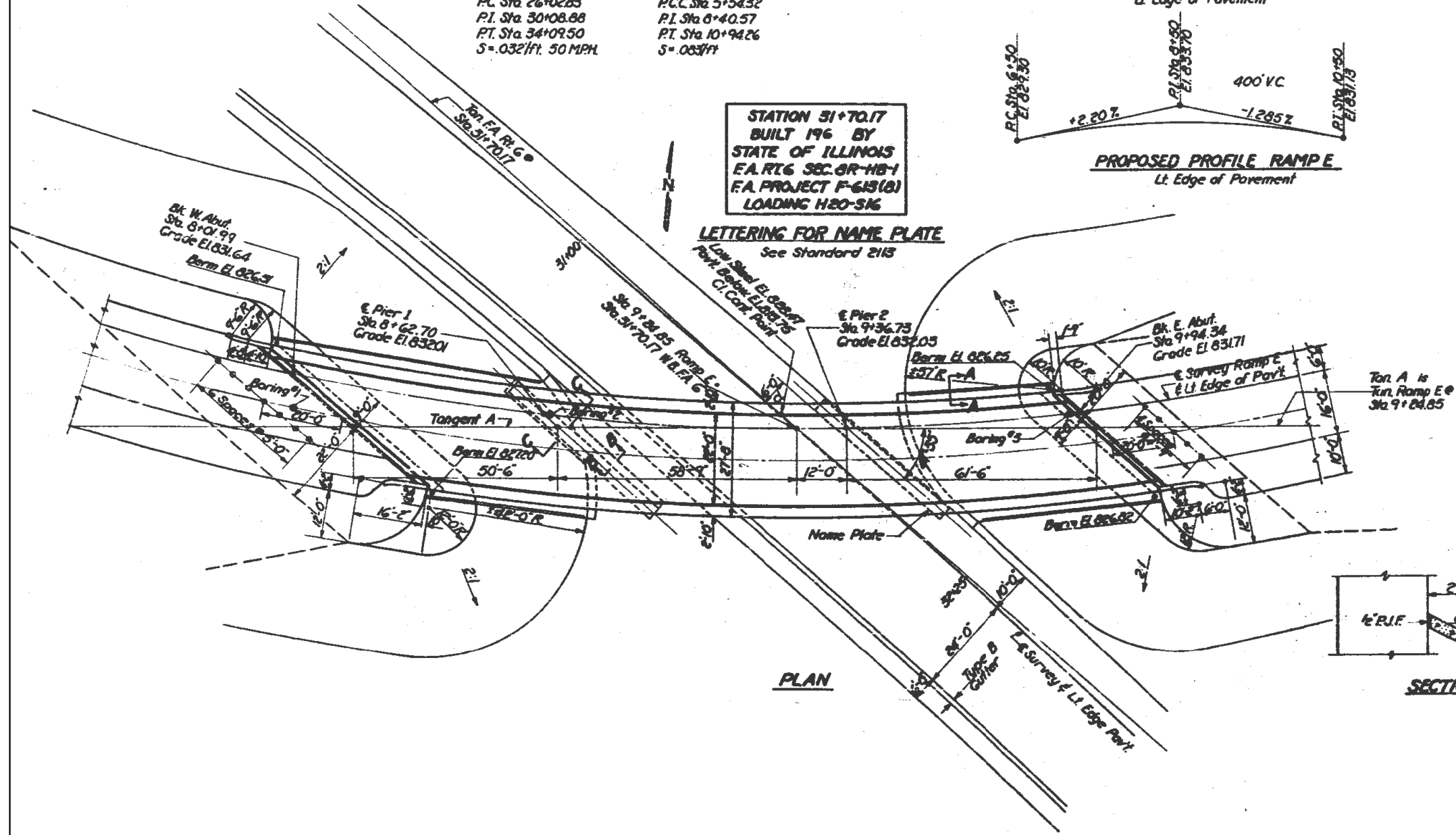

PLAN

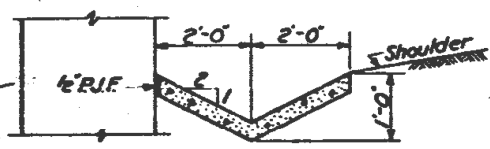

SECTION B-B

FILE NAME =	USER NAME = honga	DESIGNED -	REVISED -	STATE OF ILLINOIS DEPARTMENT OF TRANSPORTATION	SN 045-0008 PLAN AND ELEVATION	F.A.P. RTE.	SECTION	COUNTY	TOTAL SHEETS	SHEET NO.	
et:\pwork\pwork\honga\0319419\0109013	sht-plan.dgn	DRAWN -	REVISED -			345	2012-077BP	COOK & KANE	19	13	
\$MODELNAME\$	PLOT SCALE = 100.0000' / in.	CHECKED -	REVISED -			CONTRACT NO. 60V88					
	PLOT DATE = 11/9/2012	DATE -	REVISED -			ILLINOIS FED. AID PROJECT					