

DATE
BY
SURVEYED
PLOTTED
TEMPLATE
AREAS CHECKED

DATE
BY
SURVEYED
PLOTTED
TEMPLATE
AREAS CHECKED

FILE NAME = ... \D06001-SHT-VSC-Rail.dgn

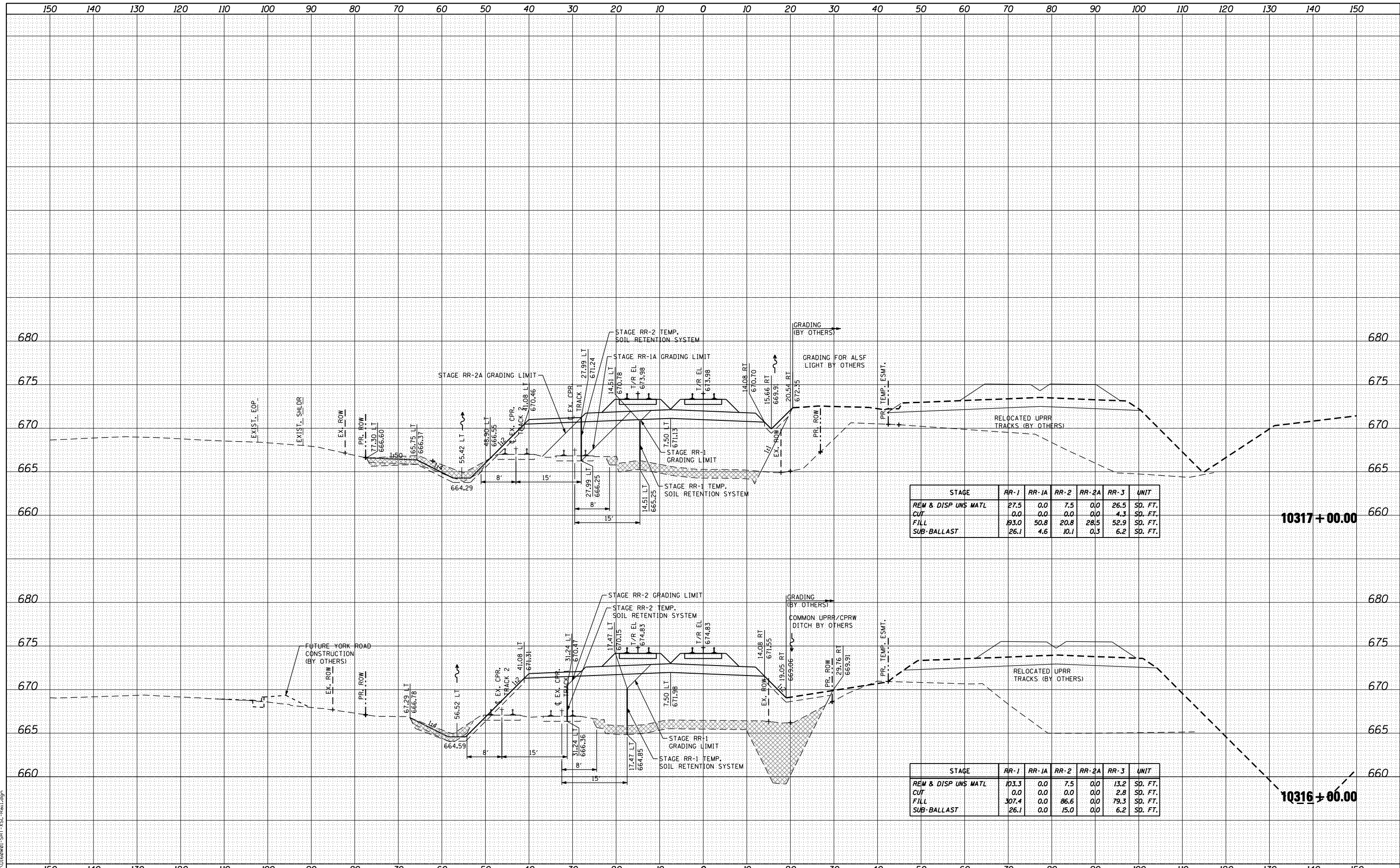

STAGE	RR-1	RR-1A	RR-2	RR-2A	RR-3	UNIT
REM & DISP UNS MATL	27.5	0.0	7.5	0.0	26.5	SD. FT.
CUT	0.0	0.0	0.0	0.0	4.3	SD. FT.
FILL	193.0	50.8	20.8	28.5	52.9	SD. FT.
SUB-BALLAST	26.1	4.6	10.1	0.3	6.2	SD. FT.

10317+00.00

STAGE	RR-1	RR-1A	RR-2	RR-2A	RR-3	UNIT
REM & DISP UNS MATL	103.3	0.0	7.5	0.0	13.2	SD. FT.
CUT	0.0	0.0	0.0	0.0	2.8	SD. FT.
FILL	307.4	0.0	86.6	0.0	79.3	SD. FT.
SUB-BALLAST	26.1	0.0	15.0	0.0	6.2	SD. FT.

10316+00.00



USER NAME = natterm
DESIGNED - NMR
DRAWN - NMR
CHECKED - MPH
DATE - 11-02-2012

REVISÉ -
REVISÉ -
REVISÉ -
REVISÉ -

STATE OF ILLINOIS
DEPARTMENT OF TRANSPORTATION

CANADIAN PACIFIC RAILWAY
CROSS SECTIONS

SCALE: SHEET NO. 23 OF 28 SHEETS STA. 10316+00.00 TO STA. 10317+00.00

F.A.U. RTE.	SECTION	COUNTY	TOTAL SHEETS	SHEET NO.
1321	32VB	DUPAGE	388	383
CONTRACT NO. 60W01				
ILLINOIS FED. AID PROJECT				