

NOTES:

- 1. REFER TO INTERSECTION DETAILS (SHEETS 26 & 27) FOR CIRCULATING LANE, OUTSIDE CURB, AND SPLITTER ISLAND BASELINES AT ROUNDABOUT.
- 2. REFER TO CONSTRUCTION DETAIL FOR SPLITTER ISLAND LAYOUT AND DETAIL.
- 3. ALL STATIONS AND OFFSETS ARE BASED ON CENTER LINES ON MONAVILLE ROAD OR CEDAR LAKE ROAD, UNLESS OTHERWISE NOTED.
- 4. ALL CURB AND GUTTER AT CIRCULATING LANE AND TRUCK APRON SHOULD BE REVERSE PITCHED TO DRAIN AWAY FROM CENTER OF ROUNDABOUT.
- 5. ALL SIDEWALK RAMPS SHOULD BE BUILT PER IDOT STD. 424001 UNLESS OTHERWISE DETAILED.

MATCHLINE STA. 103+50.00

MATCHLINE STA. 109+50.00

REFER TO SHEET 24
MATCHLINE STA. 72+00.00

MATCHLINE STA. 70+00.00
REFER TO SHEET 23

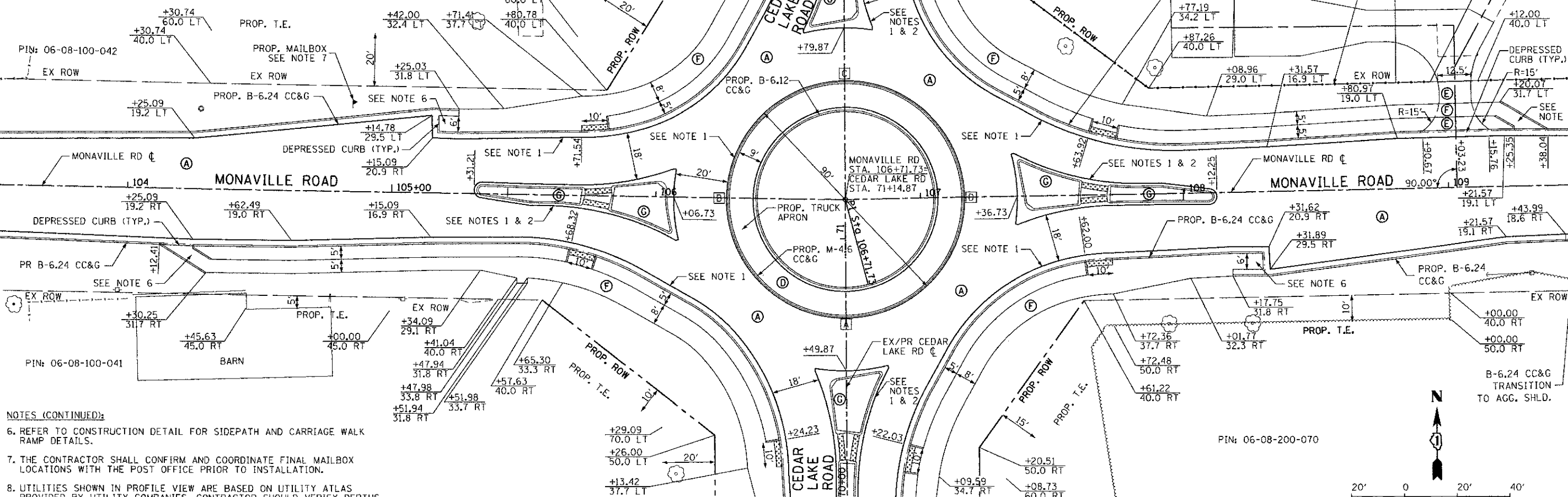

NOTES (CONTINUED):

- 6. REFER TO CONSTRUCTION DETAIL FOR SIDEPATH AND CARRIAGE WALK RAMP DETAILS.
- 7. THE CONTRACTOR SHALL CONFIRM AND COORDINATE FINAL MAILBOX LOCATIONS WITH THE POST OFFICE PRIOR TO INSTALLATION.
- 8. UTILITIES SHOWN IN PROFILE VIEW ARE BASED ON UTILITY ATLAS PROVIDED BY UTILITY COMPANIES. CONTRACTOR SHOULD VERIFY DEPTHS PRIOR TO CONSTRUCTION.

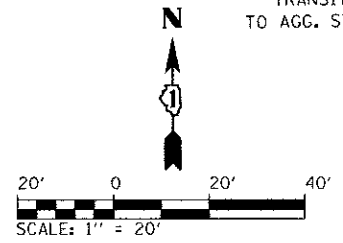

PLAN	SURVEYED	DATE
	ALIGNED	
	NOTED	
	CHECKED	
	BY	
	NO.	
	DATE	

PROFILE	SURVEYED	DATE
	NOTED	
	CHECKED	
	BY	
	NO.	
	DATE	

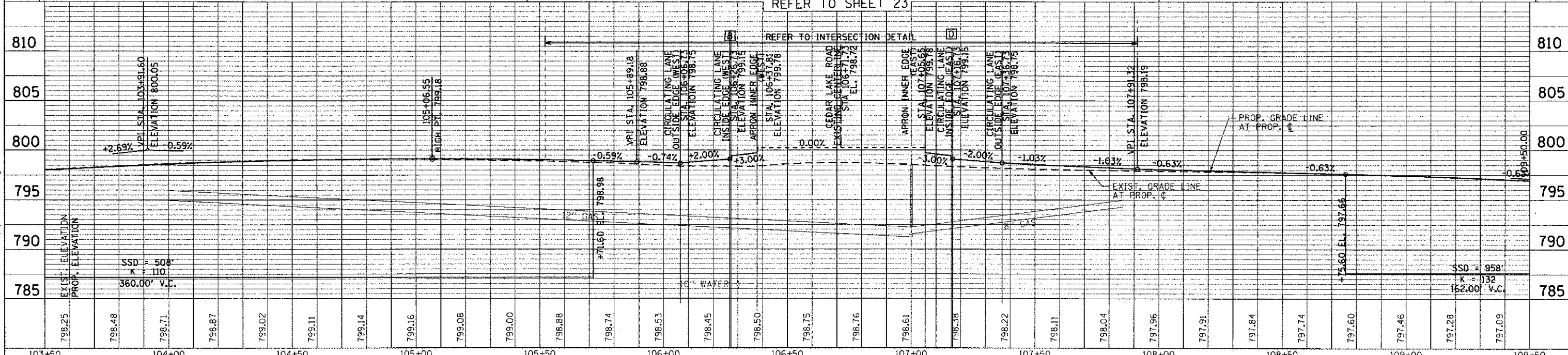

CMT
CRAWFORD, MURPHY & TILLY, INC.
CONSULTING ENGINEERS
License No. 164-000613

USER NAME = Jeff Sedig	DESIGNED -	REVISED -
PLOT SCALE = 40.0000' / 1"	DRAWN -	REVISED -
PLOT DATE = 11/12/2012	CHECKED -	REVISED -
	DATE -	REVISED -

**STATE OF ILLINOIS
DEPARTMENT OF TRANSPORTATION**

**PROPOSED ROADWAY PLAN & PROFILE
MONAVILLE ROAD**

SCALE: 20H:5V SHEET NO. 2 OF 5 SHEETS STA. 103+50.00 TO STA. 109+50.00

F.A.U. RTE. 0192	SECTION 06-00153-07-CH	COUNTY LAKE	TOTAL SHEETS 120	SHEET NO. 21
FED. ROAD DIST. NO. (ILLINOIS) FED. AID PROJECT				CONTRACT NO. 63682

FILE NAME: L:\LAKEDCO112248\Draw\CADD_Sheet\Prop_2_monaville.dwg