

DATE: \_\_\_\_\_  
 BY: \_\_\_\_\_  
 SURVEYED \_\_\_\_\_  
 PLOTTED \_\_\_\_\_  
 TEMPLATE \_\_\_\_\_  
 AREAS \_\_\_\_\_  
 CHECKED \_\_\_\_\_

DATE: \_\_\_\_\_  
 BY: \_\_\_\_\_  
 SURVEYED \_\_\_\_\_  
 PLOTTED \_\_\_\_\_  
 TEMPLATE \_\_\_\_\_  
 AREAS \_\_\_\_\_  
 CHECKED \_\_\_\_\_

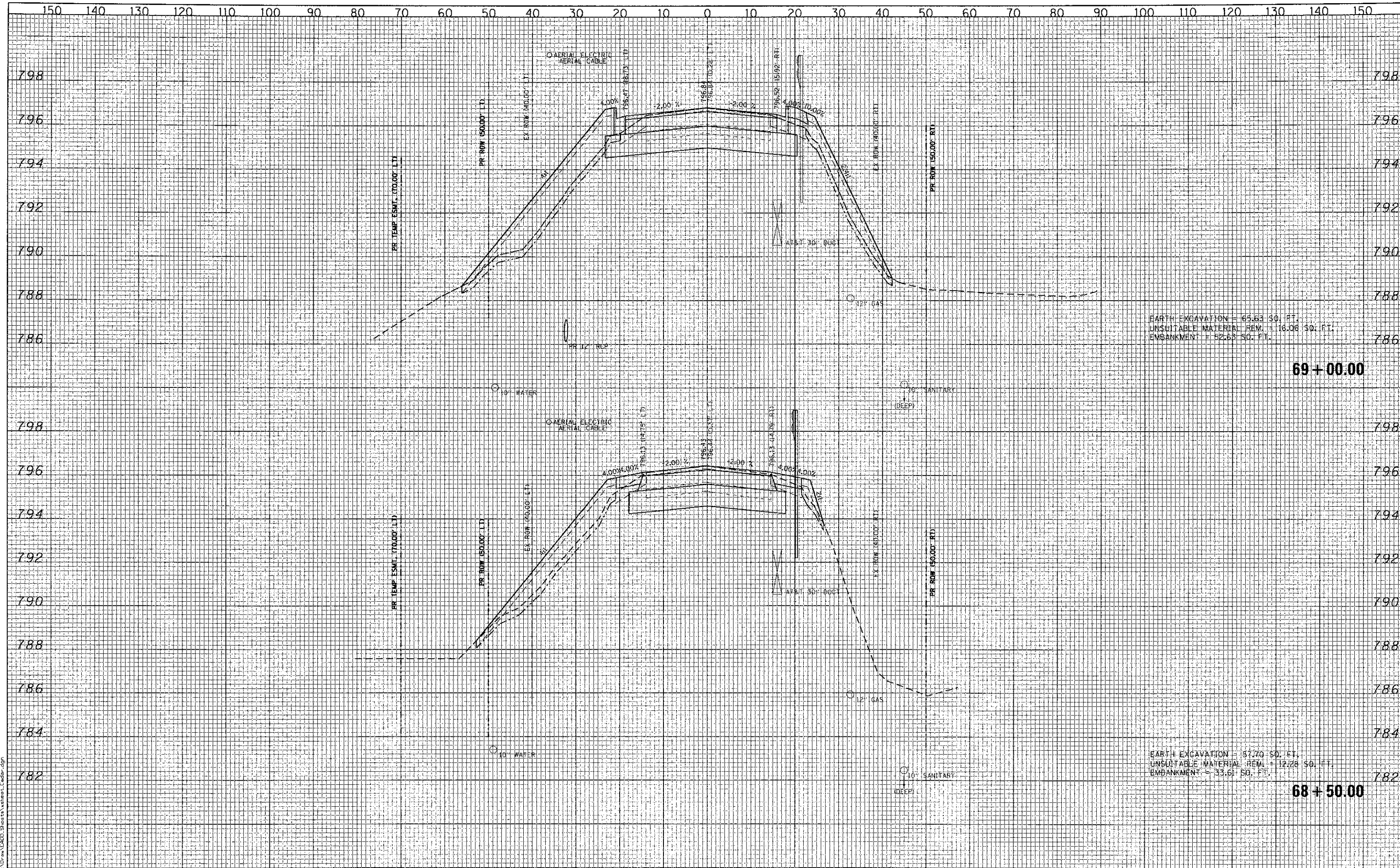

EARTH EXCAVATION = 65.63 SQ. FT.  
 UNSUITABLE MATERIAL REM. = 116.06 SQ. FT.  
 EMBANKMENT = 52.63 SQ. FT.

69+00.00

EARTH EXCAVATION = 57.70 SQ. FT.  
 UNSUITABLE MATERIAL REM. = 12.28 SQ. FT.  
 EMBANKMENT = 33.61 SQ. FT.

68+50.00

FILE NAME = L:\AL\KEDD\112240.D - 112240 - 112240 - Sheets\Station\_Cross.dgn

**CMT** ©Copyright CMT, Inc.  
 CRAWFORD, MURPHY & TILLY, INC.  
 CONSULTING ENGINEERS  
 License No. 04-000613

USER NAME = Jeff Sedig	DESIGNED - CMC	REVISED -
PLOT SCALE = 20.0000' / in.	DRAWN - ERD	REVISED -
PLOT DATE = #PLOTDATE#	CHECKED - KON	REVISED -
	DATE - 10/22/2012	REVISED -

**STATE OF ILLINOIS  
 DEPARTMENT OF TRANSPORTATION**

**CEDAR LAKE ROAD - CROSS SECTIONS**

SCALE: 10:1 H:V    SHEET NO.    OF    SHEETS    STA. 68+50.00    TO    STA. 69+00.00

F.A. RTE.	SECTION	COUNTY	TOTAL SHEETS	SHEET NO.
0192	06-00153-07-CH	LAKE	120	92
CONTRACT NO. 63682				
FED. ROAD DIST. NO. 1   ILLINOIS FED. AID PROJECT				