

FINAL SURVEY
 SURVEYED
 PLOTTED
 NOTE BOOK
 AREAS CHECKED

ORIGINAL SURVEY
 SURVEYED
 PLOTTED
 NOTE BOOK
 AREAS CHECKED

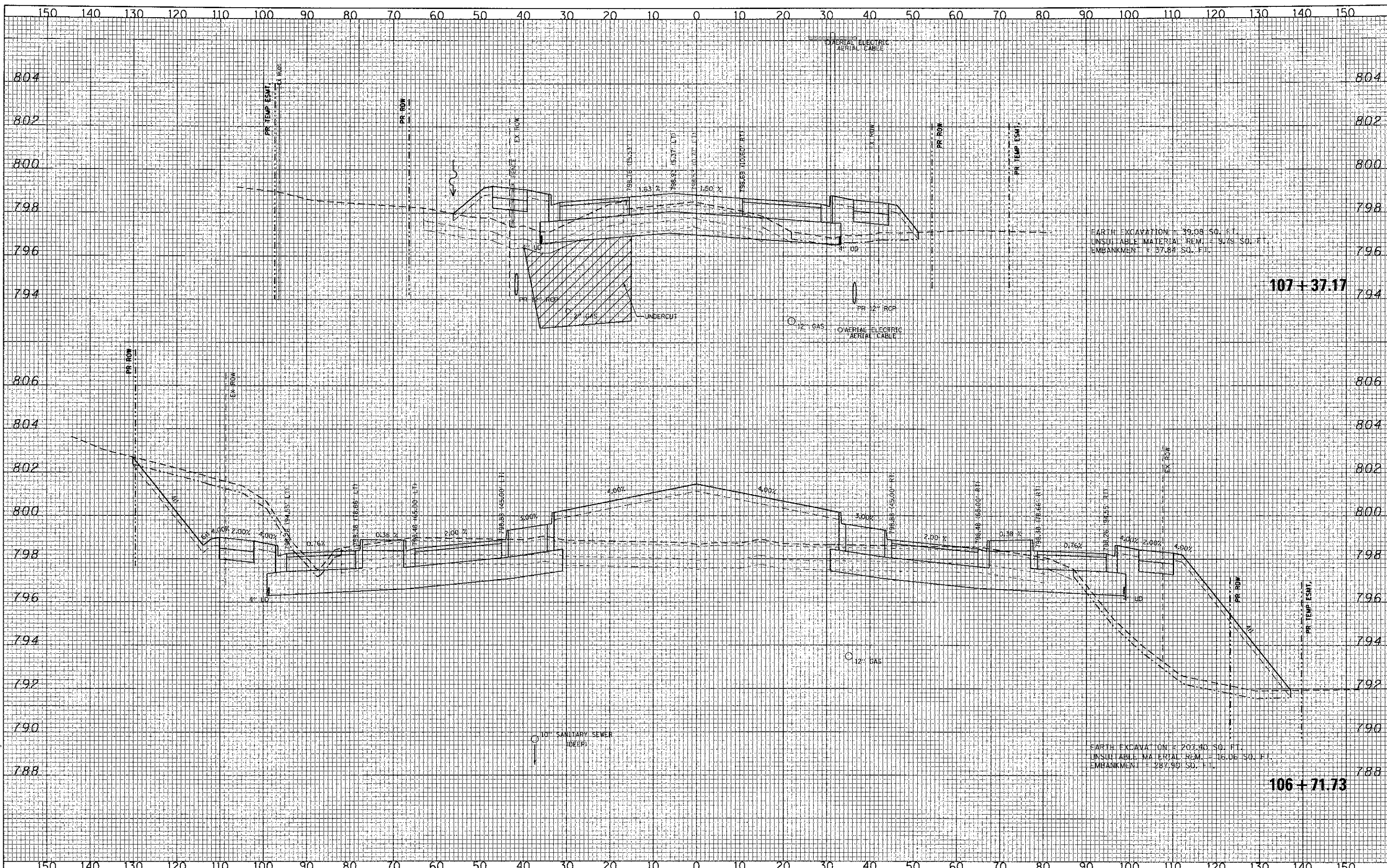

CMT
 CRAWFORD, MURPHY & TILLY, INC.
 CONSULTING ENGINEERS
 License No. 184-000613

USER NAME = Jeff Sedvig
 DESIGNED - CMC
 DRAWN - ERD
 CHECKED - KDN
 DATE - 10/22/2012

REVISED -
 REVISED -
 REVISED -
 REVISED -

STATE OF ILLINOIS
DEPARTMENT OF TRANSPORTATION

MONVILLE ROAD - CROSS SECTIONS
 SCALE: 10H:2V SHEET NO. OF SHEETS STA. 106+71.73 TO STA. 107+37.17

F.A. RTE.	SECTION	COUNTY	TOTAL SHEETS NO.
0192	06-00153-07-CH	LAKE	120 114
			CONTRACT NO. 63682

FED. ROAD DIST. NO. 1 ILLINOIS FED. AID PROJECT