

DATE: _____
 BY: _____
 SUBMITTED: _____
 PLOTTED: _____
 TEMPLATE: _____
 NOTE BOOK: _____
 AREAS CHECKED: _____
 NO. _____

DATE: _____
 BY: _____
 SCANNED: _____
 PLOTTED: _____
 TEMPLATE: _____
 NOTE BOOK: _____
 AREAS CHECKED: _____
 NO. _____

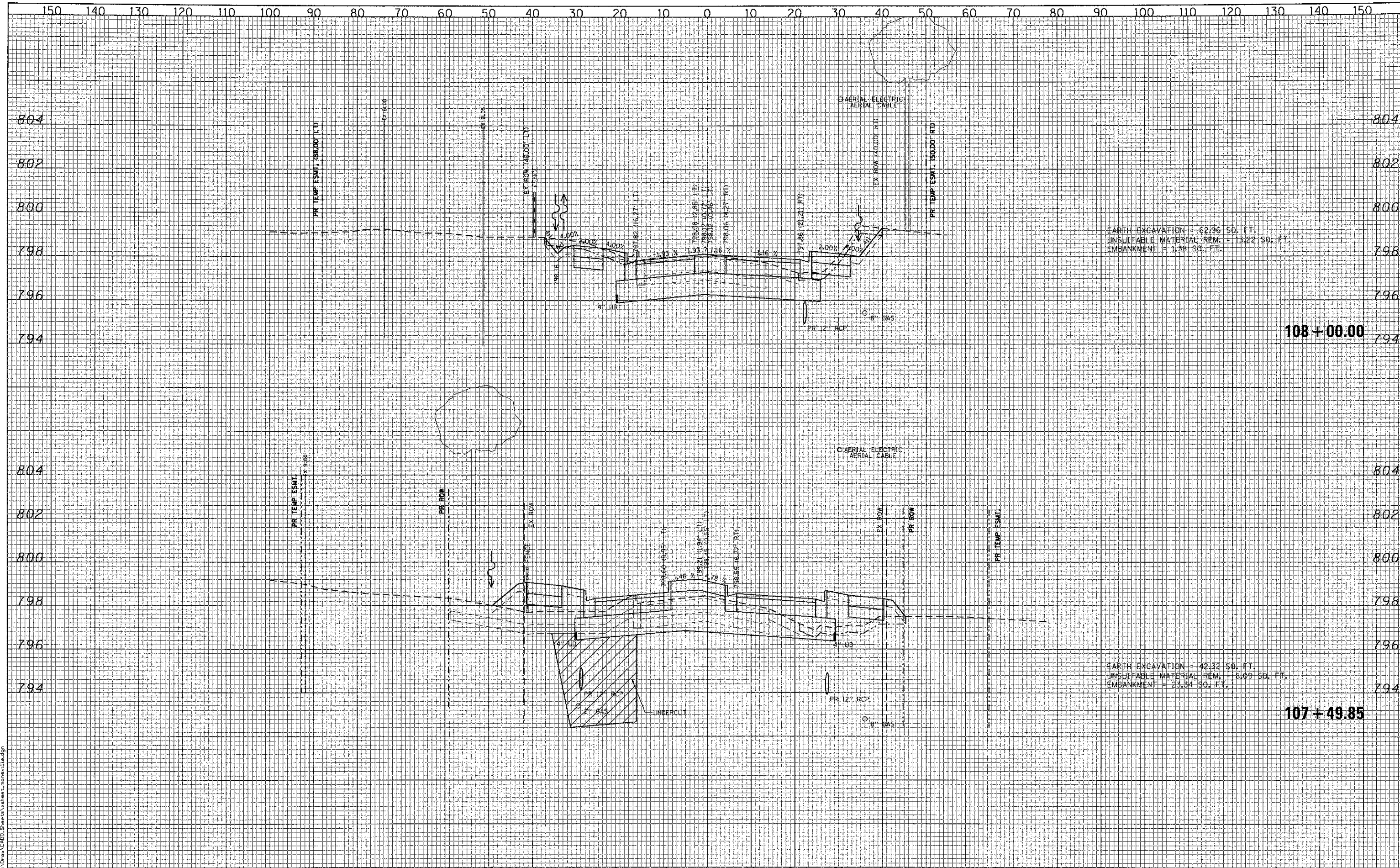

EARTH EXCAVATION = 62.96 SQ. FT.
 UNSUITABLE MATERIAL REM. = 13.22 SQ. FT.
 EMBANKMENT = 1.38 SQ. FT.

EARTH EXCAVATION = 42.32 SQ. FT.
 UNSUITABLE MATERIAL REM. = 8.09 SQ. FT.
 EMBANKMENT = 23.34 SQ. FT.

108+00.00

107+49.85

FILE NAME =

L:\AL\600\112240\Draw\10000_Sheets\Sheet\monville_107.dwg

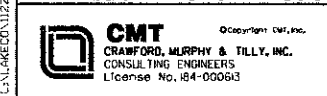

USER NAME = Jeff Sedig
 DESIGNED - CMC
 DRAWN - ERD
 CHECKED - KDN
 DATE - 10/22/2012

REVISED -
 REVISED -
 REVISED -
 REVISED -

STATE OF ILLINOIS
 DEPARTMENT OF TRANSPORTATION

MONVILLE ROAD - CROSS SECTIONS
 SCALE: 10Hx2V
 SHEET NO. OF SHEETS STA. 107+49.85 TO STA. 108+00.00

F.A. RTE.	SECTION	COUNTY	TOTAL SHEETS	SHEET NO.
0192	06-00153-07-CH	LAKE	120	115
CONTRACT NO. 63682				
FED. ROAD DIST. NO. 1 ILLINOIS FED. AID PROJECT				