

DATE	
BY	
FINAL SURVEY	
PLOTTED	
NOTE BOOK	
AREAS CHECKED	
NO.	

DATE	
BY	
ORIGINAL SURVEY	
PLOTTED	
NOTE BOOK	
AREAS CHECKED	
NO.	

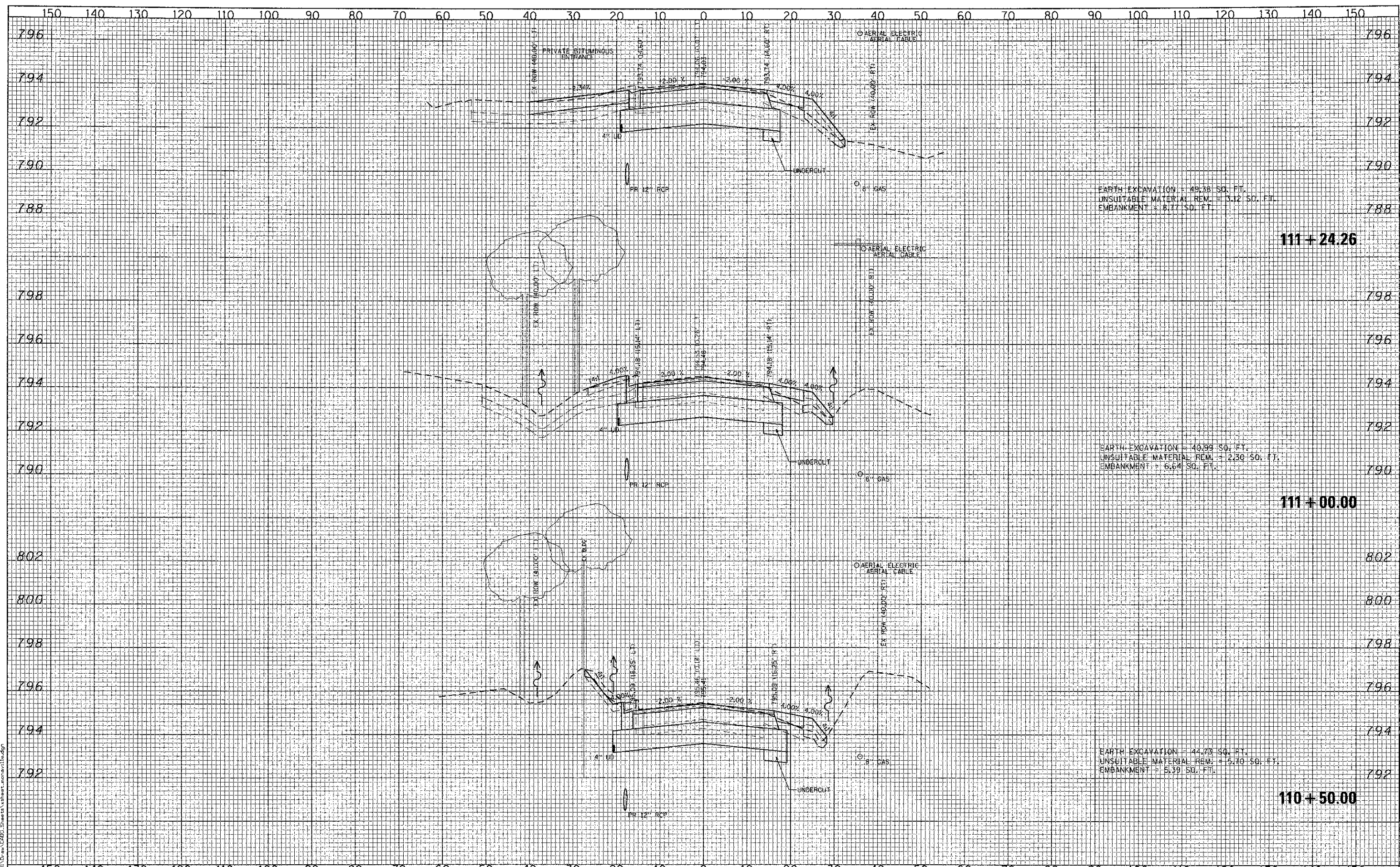

EARTH EXCAVATION = 49.38 SQ. FT.
 UNSUITABLE MATERIAL REM. = 3.12 SQ. FT.
 EMBANKMENT = 8.77 SQ. FT.

EARTH EXCAVATION = 40.99 SQ. FT.
 UNSUITABLE MATERIAL REM. = 2.30 SQ. FT.
 EMBANKMENT = 6.64 SQ. FT.

EARTH EXCAVATION = 44.73 SQ. FT.
 UNSUITABLE MATERIAL REM. = 5.70 SQ. FT.
 EMBANKMENT = 5.39 SQ. FT.

111+24.26

111+00.00

110+50.00

FILE NAME =

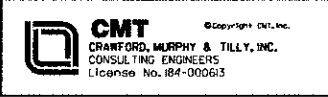

USER NAME = Jeff Sedig	DESIGNED - CMC	REVISED -
PLOT SCALE = 20.0000' / in.	DRAWN - ERD	REVISED -
PLOT DATE = #PLOTDATE#	CHECKED - KDN	REVISED -
	DATE - 10/22/2012	REVISED -

STATE OF ILLINOIS
 DEPARTMENT OF TRANSPORTATION

MONAVILLE ROAD - CROSS SECTIONS

SCALE: 10Hx2V SHEET NO. OF SHEETS STA. 110+50.00 TO STA. 111+24.26

F.A. RTE.	SECTION	COUNTY	TOTAL SHEETS	SHEET NO.
0192	06-00153-07-CH	LAKE	120	118
				CONTRACT NO. 63682
FED. ROAD DIST. NO. 1 ILLINOIS FED. AID PROJECT				