

MATCH LINE STA. 171+50
SEE SHEET 23

MATCH LINE STA. 176+50
SEE SHEET 25

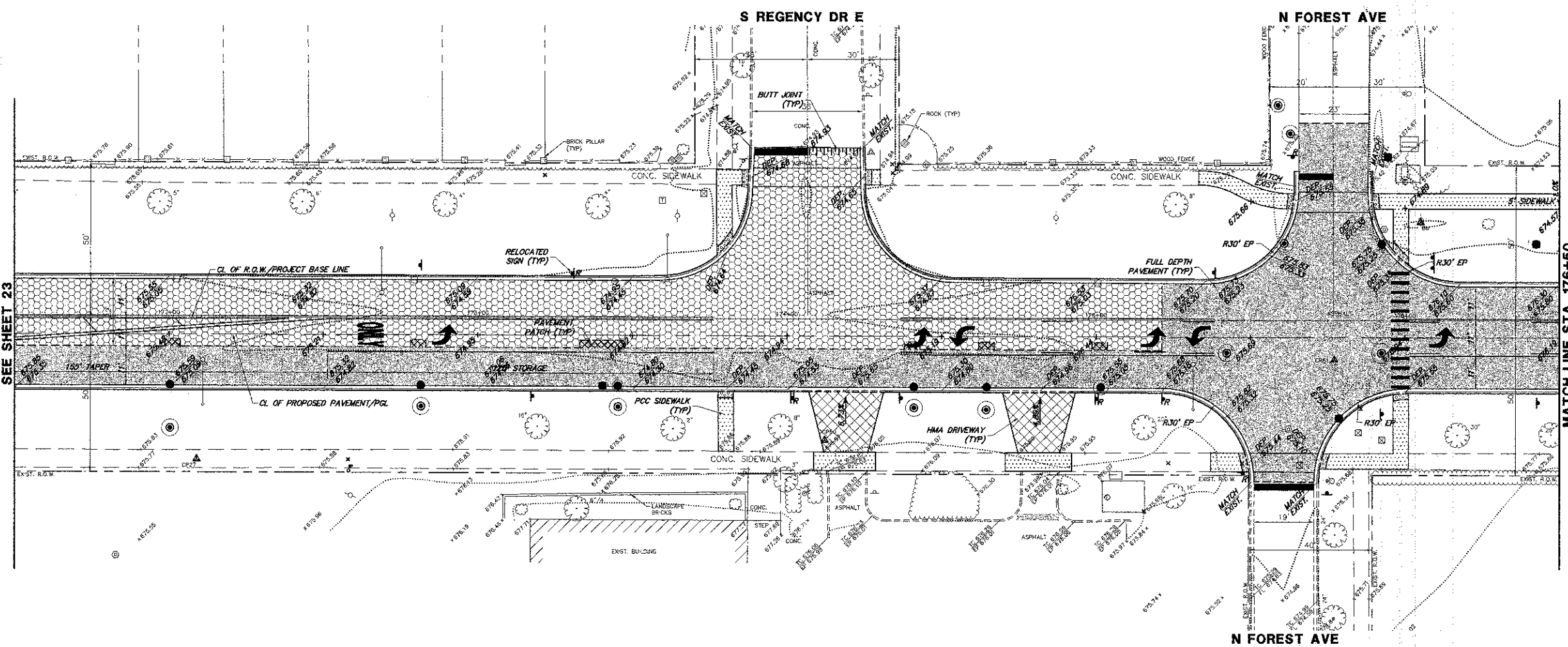

LEGEND:

- HMA PAVEMENT (SEE TYPICAL SECTION)
- HMA RESURFACING (SEE TYPICAL SECTION)
- PCC SIDEWALK (SEE TYPICAL SECTION)
- HMA BIKE PATH (SEE TYPICAL SECTION)
- PCC DRIVEWAY (SEE TYPICAL SECTION)
- HMA DRIVEWAY (SEE TYPICAL SECTION)
- PAVEMENT PATCH (SEE DETAIL)
- B6.12 CURB & GUTTER - REGULAR
- B6.12 CURB & GUTTER - DEPRESSED
- DETECTABLE WARNING
- PROPOSED SIGN
- PROPOSED MAIL BOX
- PROPOSED POWER/LIGHT POLE
- STREET ADDRESS

NOTE:
WHEN PAVEMENT WIDENING IS LESS THAN 6' WIDE,
PCC BASE COURSE 9" SHALL BE USED.

WEST KENSINGTON ROAD

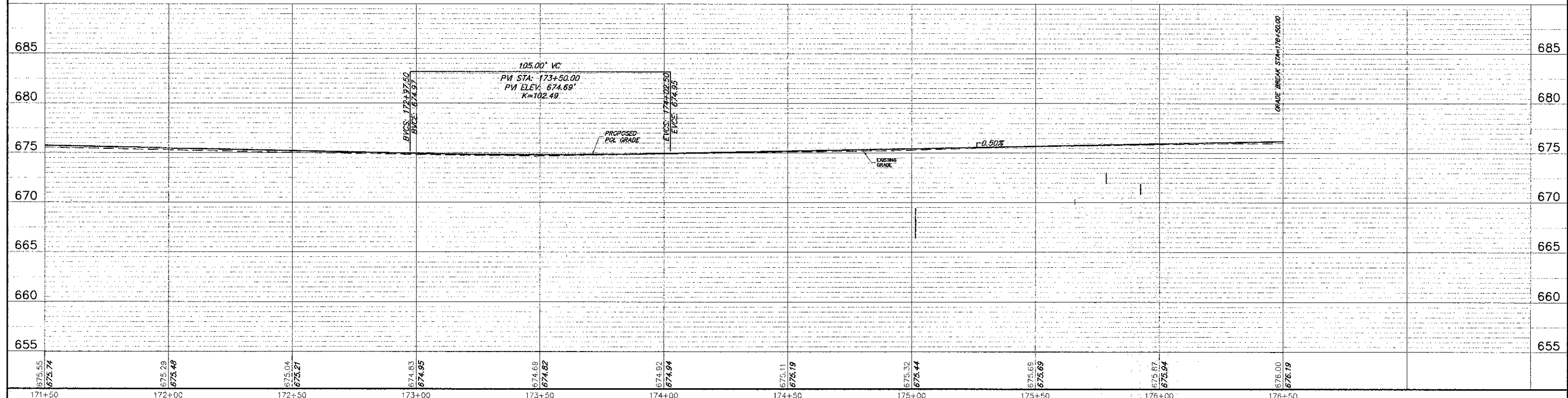

FILE NAME = 4185.800-PR3.dwg	USER NAME = PAUL SWATEK	DESIGNED - BVS	REVISED -	STATE OF ILLINOIS DEPARTMENT OF TRANSPORTATION	ROADWAY PLAN & PROFILE - KENSINGTON ROAD KENSINGTON ROAD IMPROVEMENTS	FAU RTE 1295	SECTION 09-00154-00-PV	COUNTY COOK	TOTAL SHEETS 119	SHEET NO. 24	
PLOT SCALE = 1" = .06'		DRAWN - PJS	REVISED -			SCALE: 1"=20'		SHEET NO. OF SHEETS		STA. 171+50 TO STA. 176+50	
PLOT DATE = 10/17/2012		CHECKED - KLB	REVISED -			CONTRACT # 63748		ILLINOIS FED. AID PROJECT			
171+50	172+00	172+50	173+00	173+50	174+00	174+50	175+00	175+50	176+00	176+50	