

N

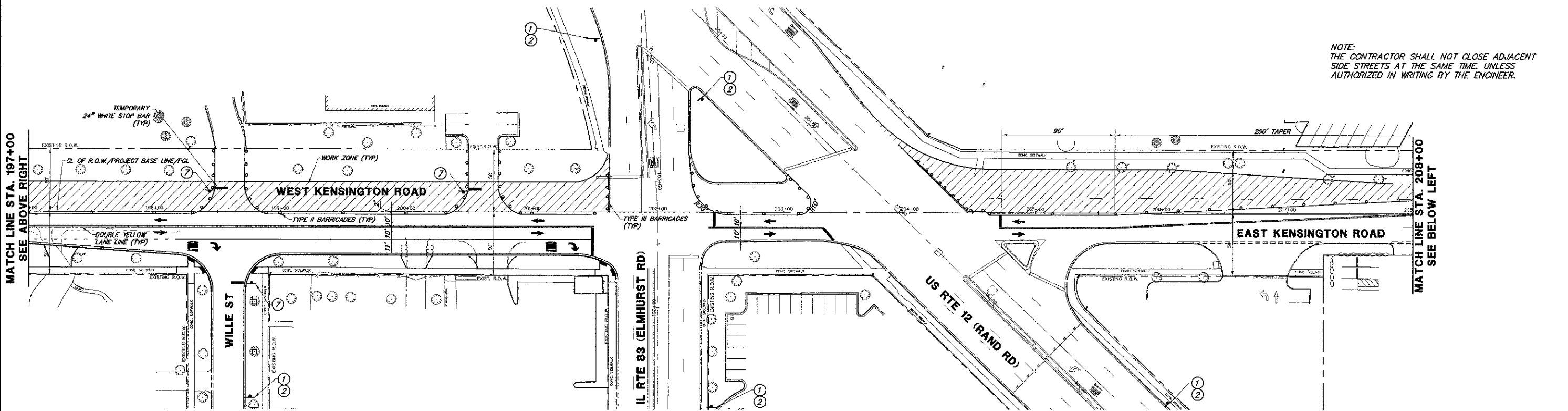

NOTE:
THE CONTRACTOR SHALL NOT CLOSE ADJACENT
SIDE STREETS AT THE SAME TIME, UNLESS
AUTHORIZED IN WRITING BY THE ENGINEER.

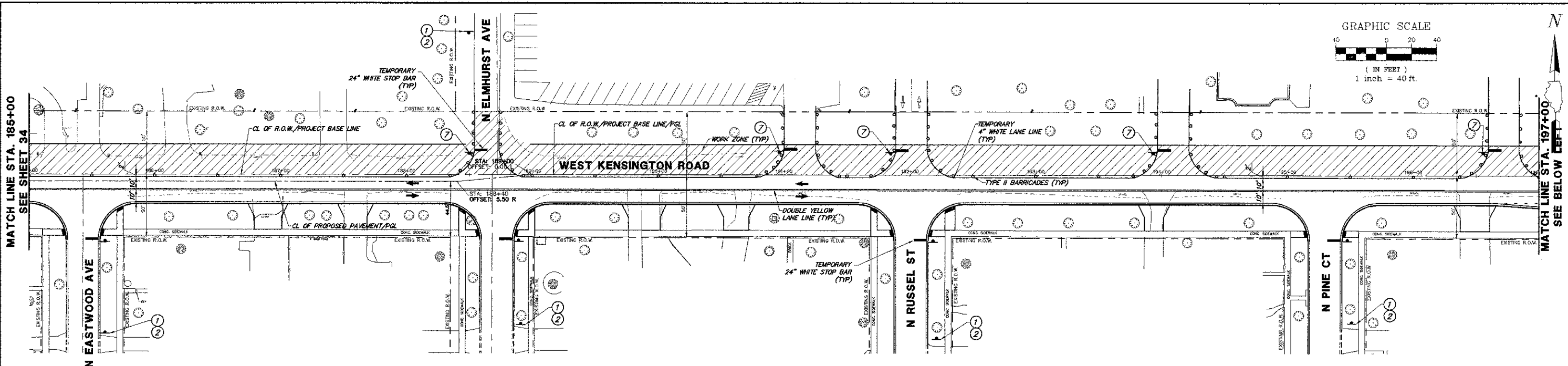
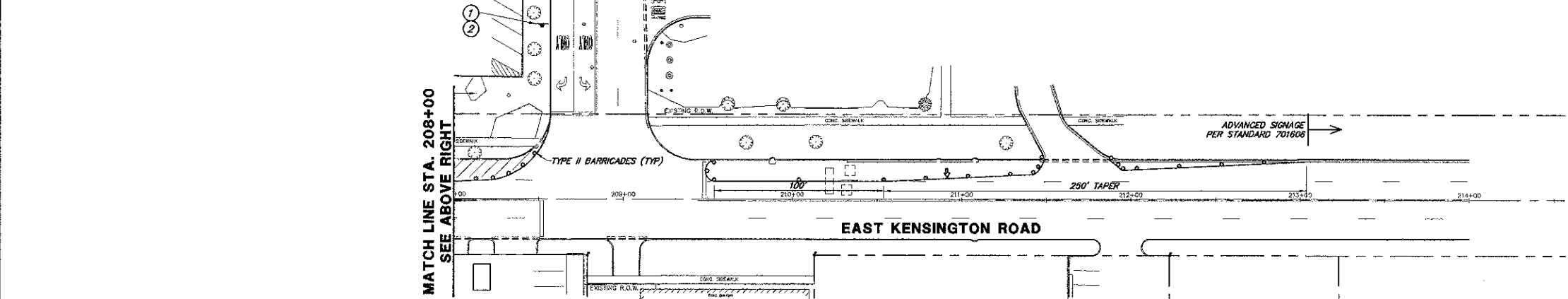

LEGEND

- TEMPORARY PAVEMENT
- WORK ZONE
- DIRECTION OF TRAFFIC
- VERTICAL PANELS WITH "BI-DIRECTIONAL" STEADY BURN LIGHTS @ 50 FT C-C.
- TYPE II BARRICADES OR DRUMS WITH "BI-DIRECTIONAL" STEADY BURN LIGHTS @ 50 FT CENTERS ALONG ROADWAY, 25 FT CENTERS ON TAPERS AND 10 FT CENTERS ALONG RADII.
- TYPE III BARRICADES WITH FLASHING LIGHTS
- ARROW BOARD

① RCA

② BI-DIRECTIONAL

③ SINGLE DIRECTION

④ SINGLE DIRECTION

⑤ END CONSTRUCTION

⑥ NO RIGHT TURN

⑦ STOP

FILE NAME = 4185.800-STAGING PLAN.dwg	USER NAME = PAUL SWATEK
DESIGNED - BVS	REVISIONS -
DRAWN - PJS	REVISIONS -
CHECKED - KLB	REVISIONS -
DATE - 10/17/12	REVISIONS -

DESIGNED - BVS	REVISIONS -
DRAWN - PJS	REVISIONS -
CHECKED - KLB	REVISIONS -
DATE - 10/17/12	REVISIONS -

**STATE OF ILLINOIS
DEPARTMENT OF TRANSPORTATION**

**STAGES OF CONSTRUCTION AND TRAFFIC CONTROL PLAN - STAGE 2
KENSINGTON ROAD IMPROVEMENTS**

FAU RTE 1295	SECTION 09-00154-00-PV	COUNTY COOK	TOTAL SHEETS 119	SHEET NO. 35
SCALE: 1" = 40'			CONTRACT # 63746	
ILLINOIS FED. AID PROJECT				