

REGRADE EXISTING DITCHES  
FROM STA. 36+08 TO STA. 52+94 LT

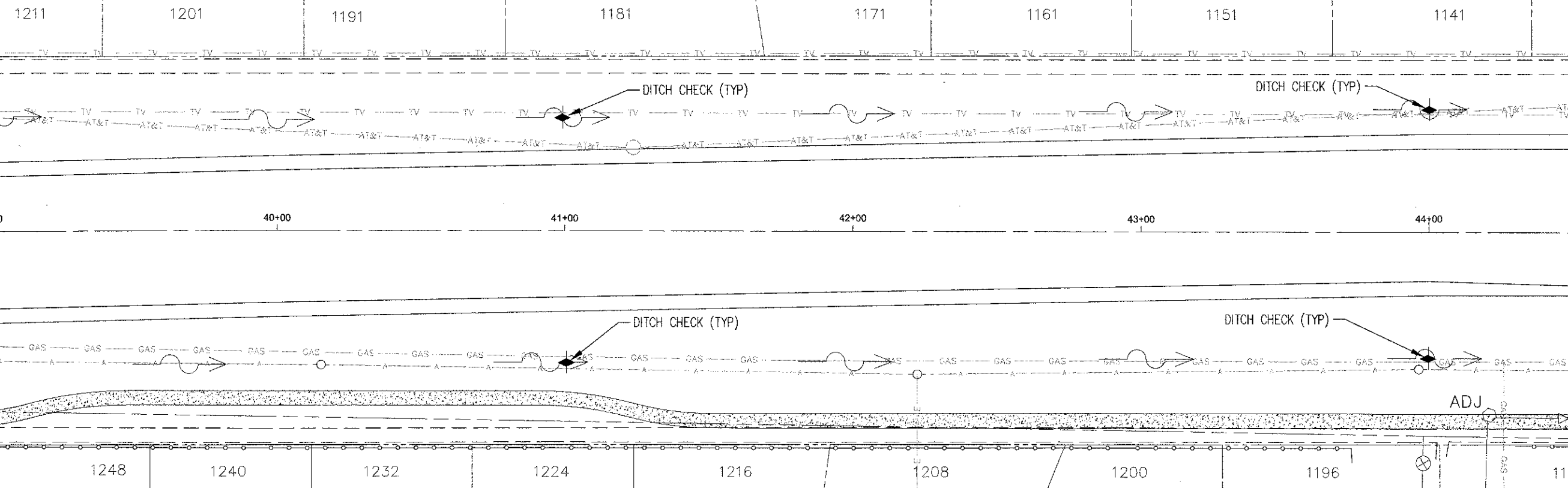

REGRADE EXISTING DITCHES  
FROM STA. 34+94 TO STA. 48+33 RT

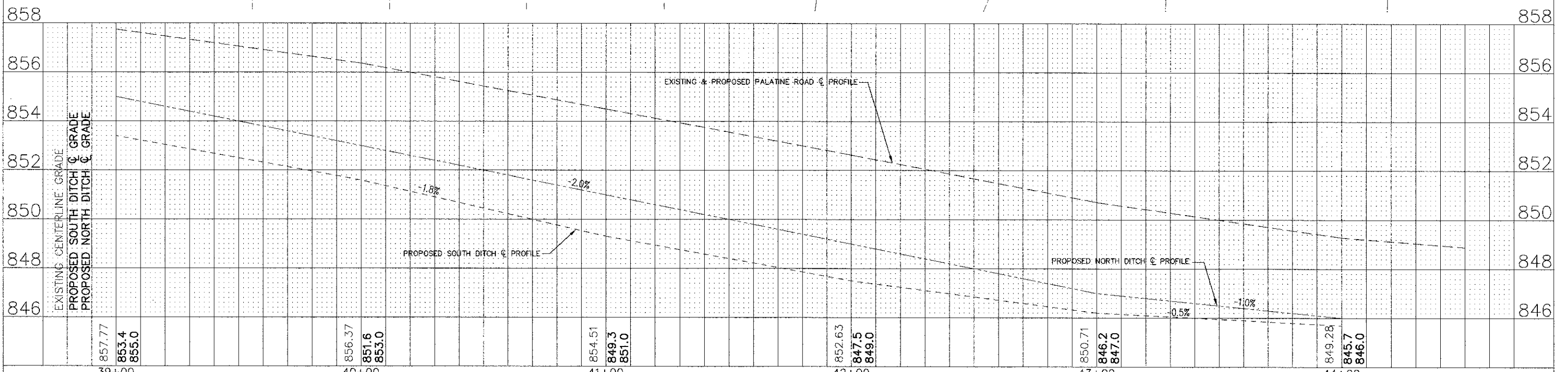

PLAN	SURVEYED	DATE	BY
	ALIGNMENT CHECKED		
	NOTE BOOK NO.		
	BY WHOM CHECKED		
	NO.		

PROFILE	SURVEYED	DATE	BY
	GRADES CHECKED		
	NOTE BOOK NO.		
	BY WHOM CHECKED		
	NO.		
	STRUCTURE NOTATIONS CHD		

FILE NAME -  
Palatine Plan and Profile.dwg

DESIGNED - NMP	REVISED -
DRAWN - NMP	REVISED -
CHECKED - CJM	REVISED -
DATE - 02-07-11	REVISED -

**STATE OF ILLINOIS**  
**DEPARTMENT OF TRANSPORTATION**

Palatine Road Widening STP Project  
Drainage, Utilities, Erosion & Sediment Control Plan

F.A.U.:	SECTION	COUNTY	TOTAL SHEETS
1285	09-00082-00-CH	Cook	97
			NO. 44
		CONTRACT NO. 63749	
		ILLINOIS FED. AID PROJECT CMM 9003(492)	

SCALE: 1" = 20' SHEET NO. 7 OF 11 SHEETS STA. 39+00 TO STA 44+50