

PLAN	SURVEYED	DATE
	PLOTTED	BY
	ALIGNMENT CHECKED	
	NO. _____	
	NO. _____	

PROFILE	SURVEYED	DATE
	PLOTTED	BY
	ALIGNMENT CHECKED	
	NO. _____	
	NO. _____	

**RESTORATION OF WORK AREA**

RESTORATION OF THE TRAFFIC SIGNAL WORK AREA SHALL BE INCIDENTAL TO THE RELATED PAY ITEM SUCH AS FOUNDATION, CONDUIT, HANDHOLE, TRENCH AND BACKFILL, ETC., AND NO EXTRA COMPENSATION SHALL BE ALLOWED. ALL ROADWAYS SURFACES SUCH AS SHOULDERS, MEDIANS, SIDEWALKS, PAVEMENT, ETC. SHALL BE REPLACED IN KIND. ALL DAMAGE TO MOWED LAWNS SHALL BE REPLACED WITH AN APPROVED SOD AND ALL DAMAGE TO UNMOWED LAWNS SHALL BE SEEDING IN ACCORDANCE WITH STANDARD SPECIFICATIONS 252 AND 250 RESPECTIVELY.

I.D.O.T. TRAFFIC SIGNAL INSTALLATION ELECTRICAL SERVICE REQUIREMENTS					TOTAL WATTAGE
TYPE	NO. LAMPS	WATTAGE		% OPERATION	
SIGNAL (RED)	12	INCAND.	17	0.50	102.00
	(YELLOW)		25	0.25	75.00
	(GREEN)	12	15	0.25	45.00
ARROW	8		12	0.10	9.60
PED SIGNAL	4		25	1.00	100.00
CONTROLLER	1		100	1.00	100.00
VIDEO DET.	1		25	1.00	25.00
<b>TOTAL =</b>					<b>456.60</b>

ENERGY COSTS TO: ILLINOIS DEPARTMENT OF TRANSPORTATION  
201 W. CENTER COURT  
SCHAUMBURG, IL 60196

ENERGY SUPPLY CONTACT: XX  
PHONE: YY  
COMPANY: COMMONWEALTH EDISON

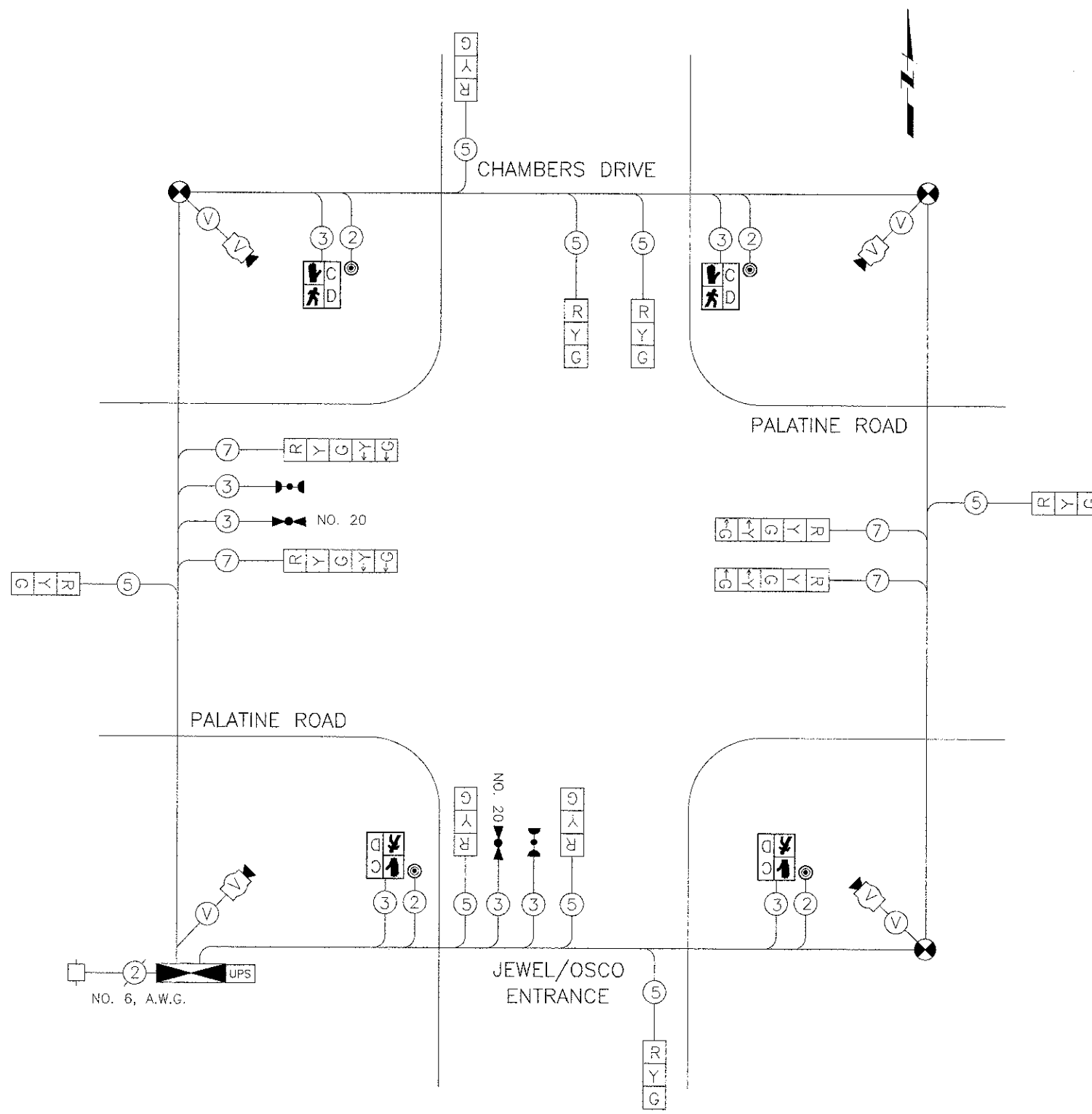

**TEMPORARY CABLE PLAN**  
NOT TO SCALE

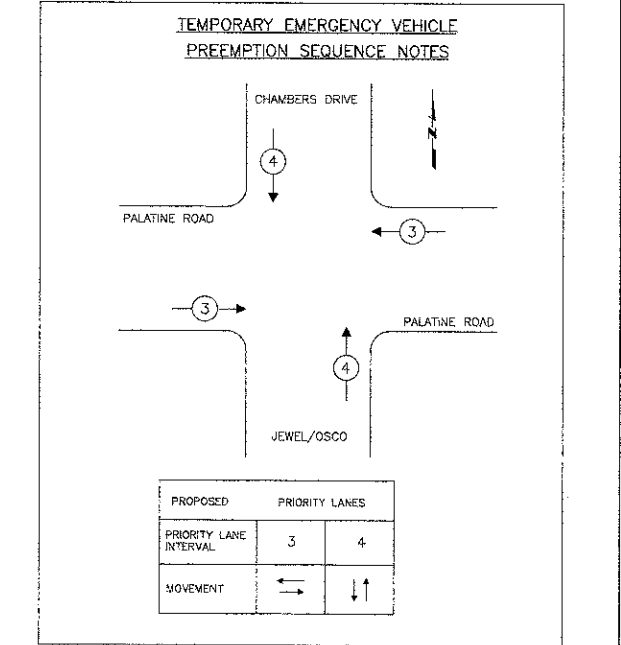
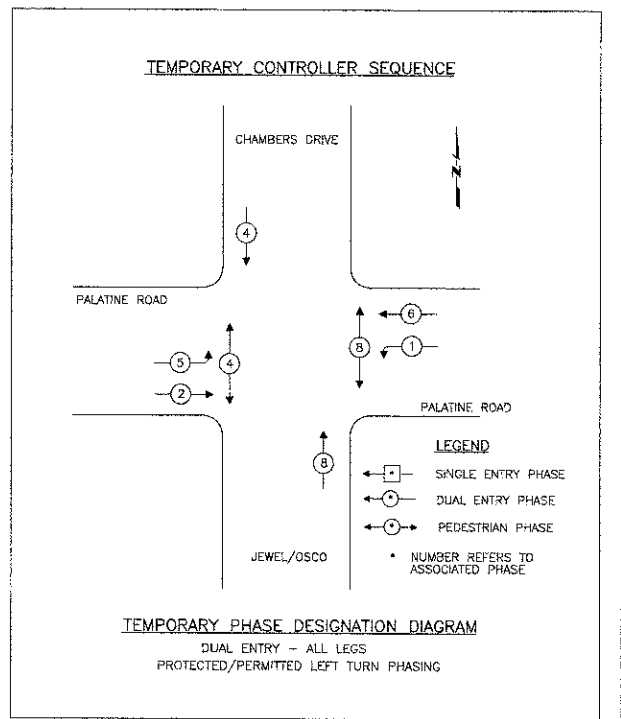

FILE NAME =	DESIGNED --	REVISED --
SIGNALS.DWG	DRAWN --	REVISED --
	CHECKED --	REVISED --
	DATE --	REVISED --

**STATE OF ILLINOIS DEPARTMENT OF TRANSPORTATION**

Palatine Road Widening STP Project  
Temporary Traffic Signal Cable Plan - Palatine Road & Chambers Drive

F.A.U. RTE.	SECTION	COUNTY	TOTAL SHEETS	SHEET NO.
1285	09-00082-00-CH	Cook	97	70
SCALE: NONE			SHEET NO. 1 OF 1 SHEETS	
STA. _____			TO STA. _____	

CONTRACT NO. 63749  
ILLINOIS FED. AID PROJECT CMM 9003(492)