

PLAN	STARTED	DATE	BY
	PLOTTED		
	ALIGNED		
	CHECKED		
	APPROVED		
NO.	NO.	NO.	NO.

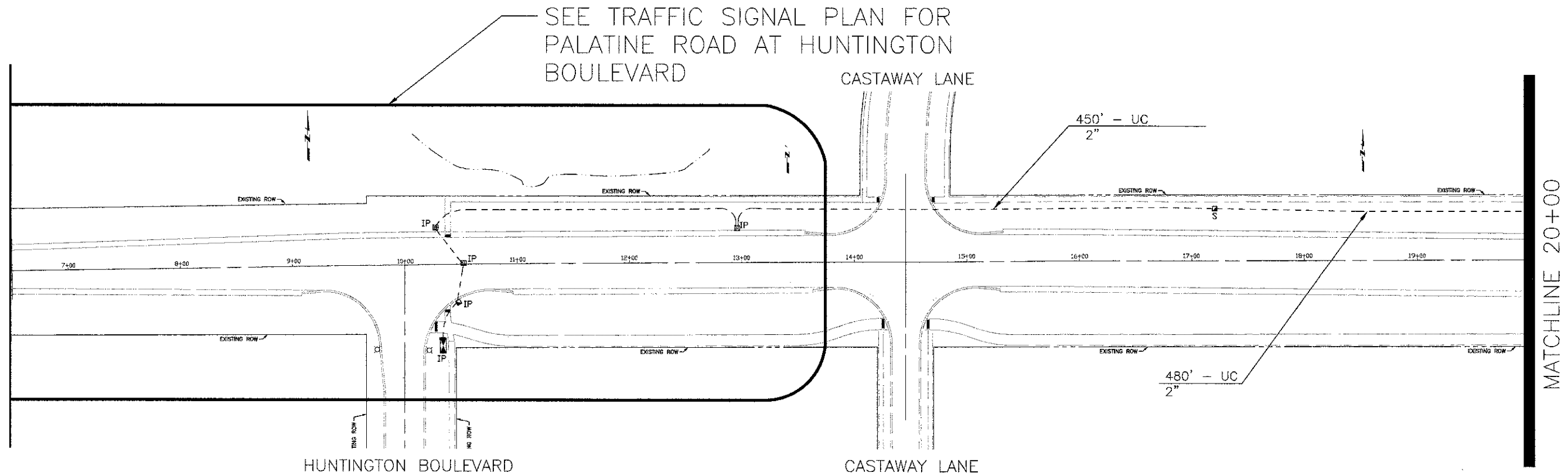

PROFILE	STARTED	DATE	BY
	PLOTTED		
	GRADES CHECKED		
	STRUCTURE NOTATIONS CHG		
NO.	NO.	NO.	NO.

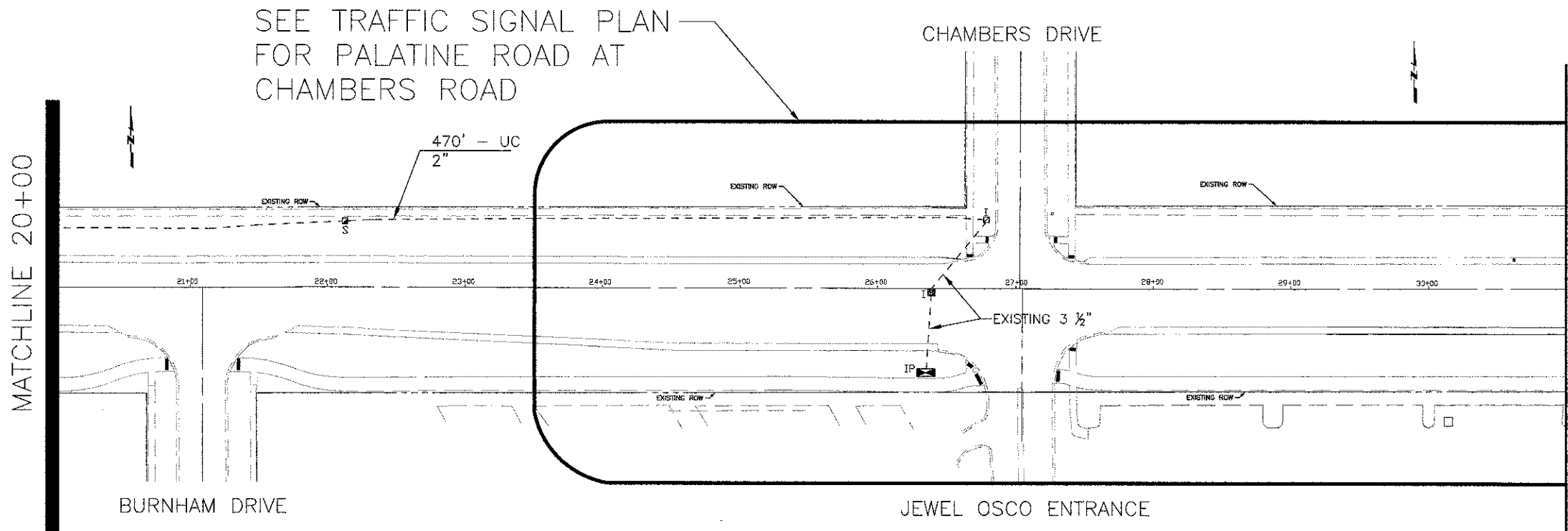

**RESTORATION OF WORK AREA**  
 RESTORATION OF THE TRAFFIC SIGNAL WORK AREA SHALL BE INCIDENTAL TO THE RELATED PAY ITEM SUCH AS FOUNDATION, CONDUIT, HANDHOLE, TRENCH AND BACKFILL, ETC., AND NO EXTRA COMPENSATION SHALL BE ALLOWED. ALL ROADWAYS SURFACES SUCH AS SHOULDERS, MEDIANS, SIDEWALKS, PAVEMENT, ETC. SHALL BE REPLACED IN KIND. ALL DAMAGE TO MOWED LAWNS SHALL BE REPLACED WITH AN APPROVED SOD AND ALL DAMAGE TO UNMOWED LAWNS SHALL BE SEEDING IN ACCORDANCE WITH STANDARD SPECIFICATIONS 252 AND 250 RESPECTIVELY.

FILE NAME =	DESIGNED --	REVISED --
SIGNALS.DWG	DRAWN --	REVISED --
	CHECKED --	REVISED --
	DATE --	REVISED --

**STATE OF ILLINOIS  
 DEPARTMENT OF TRANSPORTATION**

Palatine Road Widening STP Project  
 Interconnect Plan - Palatine Road

SCALE: 1"=50'    SHEET NO. 1 OF 1 SHEETS    STA.    TO STA.

F.A.U. RTE.	SECTION	COUNTY	TOTAL SHEETS	SHEET NO.
1285	09-00082-00-CH	Cook	97	73
CONTRACT NO. 63749				
ILLINOIS FED. AID PROJECT CMM 9003(492)				